

AREA STATEMENT

TITLE AREA OF SECTOR	A-7	=64.6 (HACT)
AREA UNDER RECREATIONAL		=15.8 HAC
SMIRITI VAN		
AREA UNDER CIRCULATION		=6.192 (HACT)
AREA UNDER OPEN SPACE		=4.0515 (HACT)
PLOTWISE DISCRPTION OF OTHER USES		
PLOT NO.	USE	AREA (IN HECT)
COMMITTED USES		
1.	COMMAND TANK	4.0
26.	66KV ELECTRIC SUBSTATION	1.08
EDUCATIONAL		
13.	INTEGRATED SCHOOL (WITH OUT HOSTEL)	34938
14.	SCHOOL FOR HANDICAPPED	4387
15.	SCHOOL FOR HANDICAPPED	4591
17.	SCHOOL FOR HANDICAPPED	5044
25.	INSTITUTE FOR APPLIED MANPOWER RESEARCH	61200
HEALTH		
16.	POLY CLINIC	2704
18.	NURSING HOME	2760
19.	NURSING HOME	2764
20.	POLY CLINIC	2835
23.	INTERMEDIATE HOSPITAL (CAT'B)	10010
28.	INTERMEDIATE HOSPITAL (CAT'A)	37555
30.	INTERMEDIATE HOSPITAL (CAT'A)	36630
OTHER FACILITIES		
2.	POLICE STATION	11034 SQM
3.	TELEPHONE EXCHANGE	4422
4.1.	PETROL PUMP - (COM-SERVICE STATION)	2160
4.1.1.	(AREA=0.108 HACT EACH)	2160
5.1.1.	VACANT PLOTS (AREA=108 HACT EACH)	2160
7.	EMSA	1547
8.	VACANT PLOTS	2005
9.	VACANT PLOTS SUB-DIVISION - 9A, 9B, 9C	2085
10.	VACANT PLOT	1568
11.1.	CLUB & SPORTS COMPLEX	728 HAC
21.	SHOPPING CENTRE (INCLUDING GUEST HOUSE, DHARMA SHALA, TAXI STAND ETC)	8721
27.	BUS TERMINAL	400
24.	DELHI POLICE FORENSIC LAB	1556
25.	INSTITUTION	3235 SQM



GREEN BELT

ROAD 40 M R/W

THE SITE OF CREMATION GROUND WAS APPROVED IN PRINCIPLE IN THE 23rd SCREENING COMMITTEE HELD ON 15.3.2004 VIDE ITEM NO. 32.2.2004 IN THE FILE NO. F-15(16)2000/NP AT PAGE 31/N WITH THE DIRECTION THAT THE LAND WILL BE HANDED OVER TO M.C.D. FOR THE DEVELOPMENT OF CREMATION GROUND WITH GREEN BUFFER ALONG PERIPHERAL ROAD

EXISTING CREMATION GROUND
A-3235 SQM

RECREATIONAL /SMIRITI VAN
AREA =15.8 HAC.

SITE MEASURING 0.49 (HACT) (1.24 ACR.) PROPOSED FOR THE SET UP OF M.R. CHILDRENS & PERSONS VIDE FILE NO F-22(24)02/11.

26. 66 KV E.S.S. 120 M X 90 M AREA=1.08 HAC (COMMITTED AREA)

27. BUS TERMINAL 60M X 80M (4800 SQM)

28. UCMS PLOT-28A (4,000 SQM)

SITE PROPOSED FOR ALLOTMENT TO I.G.D.T.W. INTERMEDIATE HOSPITAL (CAT'A) AREA = 37555 SQM (APPROX.)

PLOT-28B (33555 SQM)

THE SUB-DIVISION OF PLOT NO. 28 TO PLOT NO. 28A & 28B WAS APPROVED IN THE 42nd SCM DDA HELD ON 07.03.2024 VIDE ITEM NO.16:2024. S-FILE: PLG/MP/0113/2022/F-20 COMP. NO: 33123

Sd/- ANIL NIGAL (ASST. DIR. (PLG))

Sd/- NEELI RANDEHARA (DIR. (PLN))

25. SITE PROPOSED FOR INSTITUTE OF APPLIED MAN POWER RESEARCH 180 M X 340 M AREA =61200 SQM (15.12 ACS.)

13. INTEGRATED SCHOOL 176M X 198M AREA=34938 SQM

24. SITE PROPOSED FOR FORENSIC SCIENCE LAB DELHI POLICE (1556 H)

PROPOSAL FOR ALLOTMENT OF PLOT NO. 24 ADMEASURING 1.56 Ha APPROVED IN THE 42nd SCM HELD ON 07.03.2024 VIDE ITEM NO. 27:2024. FILE: PLG/MP/0113/2022/F-20 COMP. NO: 33123

Sd/- ANIL NIGAL (ASST. DIR. (PLG))

Sd/- NEELI RANDEHARA (DIR. (PLN))

21. SHOPPING CENTER AREA=8721 SQM

23. INTERMEDIATE HOSPITAL (CAT'B) 91 M X 110 M AREA=10010 SQM

MODIFICATION ON PLOT NO-30 HAVE BEEN MADE W.R.T THE APPROVAL OF COMM. (PLG.) DDA. VIDE FILE NO. DIR/93/187/PI-1 AT PAGE 6/N ON 19/6/96. PLAN MODIFIED ON DT-5.6.97.

SITE MEASURING 11038 SQM ALLOTTED TO POLICE DEPT. FOR THE SET UP OF POLICE STATION VIDE VC'S ORDER DT 6-11-01 AT PAGE 24/N IN FILE NO F-25 (3)95/IL

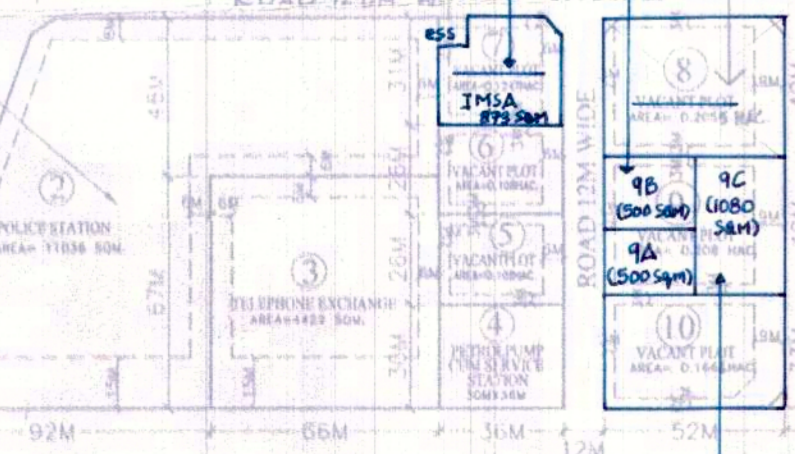

SUB-DIVISION OF PLOT 9 INTO PLOTS 9A, 9B AND 9C APPROVED IN 303 SCM DDA dt. 21.12.2011 VIDE ITEM NO. 113:2011 [FILE: F3(34)2010/MP (DIRECTOR)]

PROPOSAL FOR PLOT 15 FOR CONSTRUCTION OF CE(N2) OFFICE APPROVED IN 324th SCM, DDA dt. 16.10.2019 VIDE ITEM NO. 115:2019 [FILE: F-20(14)2018-MP] Sd/- ANIL NIGAL (ASST. DIR. (PLG))

MODIFICATION IN SIZES OF PLOTS 15 & 16 WAS APPROVED IN 724th SCM, DDA dt. 20.10.2024 VIDE ITEM NO. 51:2024 [FILE: PLG/MP/0113/2022/F-20] Sd/- ANIL NIGAL (ASST. DIR. (PLG))

Sd/- ANIL NIGAL (ASST. DIR. (PLG))

Sd/- NEELI RANDEHARA (DIR. (PLN))

E.S.S. SITES (5 NOS.) APPROVED BY COMM. (PLG.) ORDER DATED 17.1.2001 AT PAGE NO 3/N IN FILE NO: F7(39)/ED-7/DDA/1226

DELHI DEVELOPMENT AUTHORITY
Approved in 231st Screening Committee Meeting held on 15.11.07. Item No. 32:2007

THIS DRAWING IS REDRAFTED ON COMPUTER FROM ORIGINAL APPROVED DRAWING.

CHECKED BY:- A.K. MALHOTRA (PLG. ASST.)

VERIFIED BY:- Sd/- ANIL NIGAL (ASST. DIR. (PLG.))

PUBLIC & SEMI PUBLIC FACILITIES SECTOR. A-7, NARELA

SCALE: 1:2000	DATE: MAY 1995	NORTH
MURSHI (HUB DELHI)	Sd/- MANJU ASST. DIR.	
DEALT BY: PLG. ASST. K.RAJ	Sd/- P.S.P. BATLA ASST. DIR.	
J.T. DIRECTOR	PROJECT PLANNER	
NARELA PROJECT		
नरेला परियोजना		