

88/c

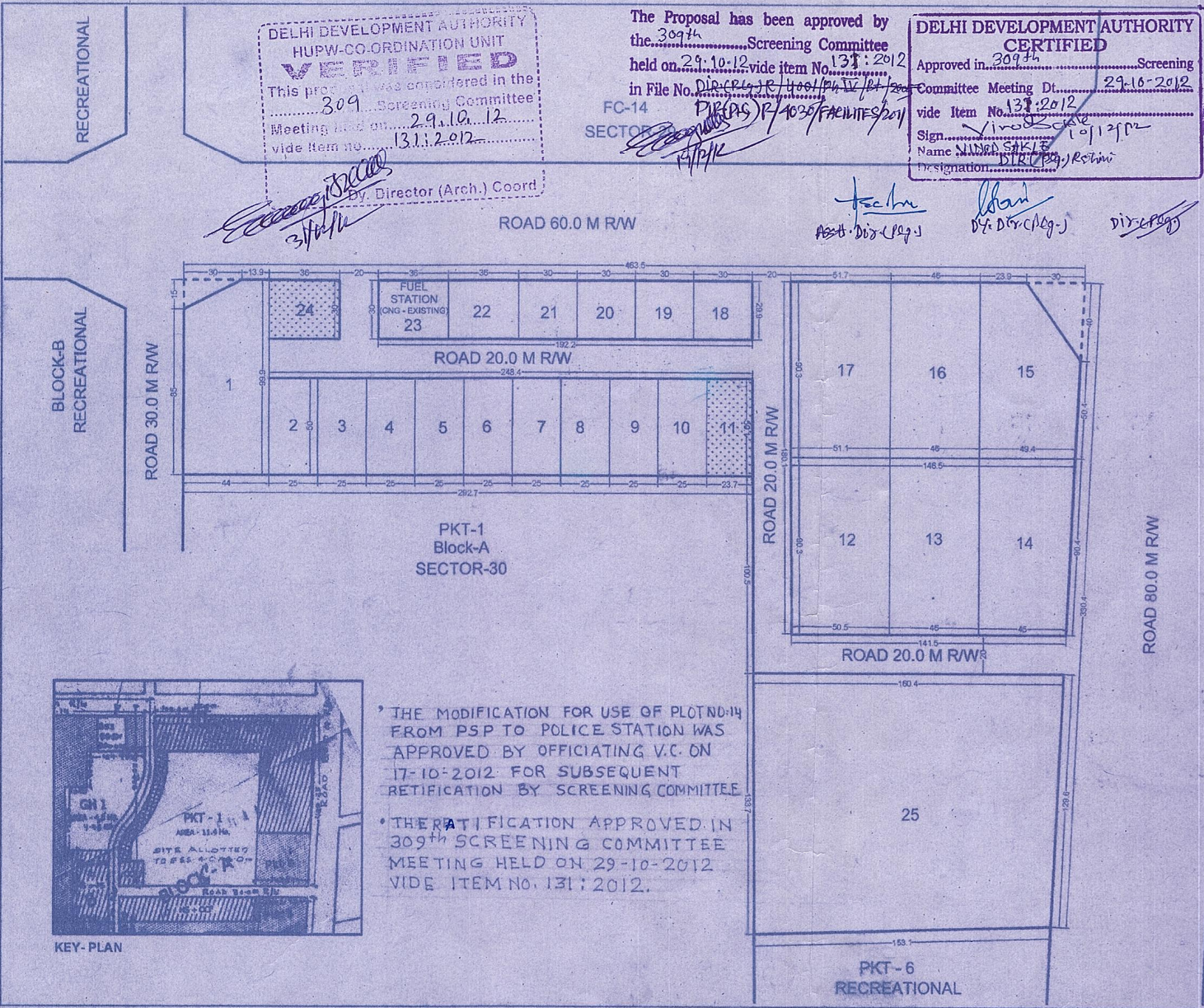

DELHI DEVELOPMENT AUTHORITY
HUPW-CO-ORDINATION UNIT
VERIFIED
This proposal was considered in the
309th Screening Committee
Meeting held on 29.10.2012
vide Item No. 131/2012

The Proposal has been approved by
the 309th Screening Committee
held on 29.10.2012 vide item No. 131/2012
in File No. DIR (PLG) R/4030/FACILITIES/2011
FC-14
SECTOR-30

DELHI DEVELOPMENT AUTHORITY
CERTIFIED
Approved in 309th Screening
Committee Meeting Dt. 29.10.2012
vide Item No. 131/2012
Sign. Virod Saha
Name: Virod Saha
Designation: Dy. Dir. (Plg.) Rohini

[Handwritten Signature]
Director (Arch.) Coord

[Handwritten Signatures]
Asst. Dir. (Plg.) Dy. Dir. (Plg.) Dir. (Plg.)

- THE MODIFICATION FOR USE OF PLOT NO. 14 FROM PSP TO POLICE STATION WAS APPROVED BY OFFICIATING V.C. ON 17-10-2012 FOR SUBSEQUENT RETIFICATION BY SCREENING COMMITTEE
- THE RETIFICATION APPROVED IN 309th SCREENING COMMITTEE MEETING HELD ON 29-10-2012 VIDE ITEM NO. 131/2012.

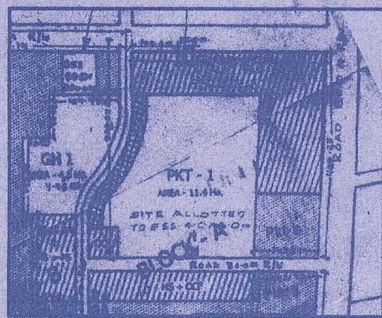

KEY-PLAN

DELHI DEVELOPMENT AUTHORITY
ROHINI PROJECT PLANNING & DESIGN

AREA STATEMENT
TOTAL AREA OF POCKET 8.31 HA
DETAILS OF PLOTS:

PLOT NO	USE	AREA (IN HA)
1	PSP	0.416
2-6	(5 PLOTS) PSP 1250 SQM EACH	0.625
7	FAMILY WELFARE CENTER	0.125
8	PEDIATRIC CENTRE	0.125
9	GERIATRIC CENTRE	0.125
10	DIA GNOSTIC CENTRE	0.125
11	PARK	0.118
12	PSP	0.459
13	PSP	0.415
14	PSP POLICE STATION	0.428
15	PARKING BUSES, LMV, IPTS	0.406
16	PSP	0.415
17	HOSPITAL 'D'	0.464
18	BUS TERMINAL	0.990
19-20	(2 PLOTS) PSP 900 SQM EACH	0.180
21	POLICE POST	0.990
22	FUEL STATION (PETROL PUMP)	0.108
23	FUEL STATION (CNG-EXISTING)	0.108
24	PARK	0.198
25	POLICE LINES	2.051
	CIRCULATION	3.328

- NOTES:
- THIS PLAN IS PREPARED BASED ON TOTAL SURVEY OF POKET FC-15 PROVIDED BY EXECUTIVE ENGINEER, RPD-2, DDA VIDE LETTER No. F50 (62) AE(P) / RPD 2 /DDA/801, DATED 12.05.2011 AND SUBSEQUENTLY VIDE LETTER No. F50 (62) AE(P) / RPD 2 /DDA/314 DATED 17.09.2011.
 - SERVICES / UTILITIES ARE TO BE PROVIDED IN PARK
 - DEVELOPMENT CONTROL NORMS AS PER MASTER PLAN FOR DELHI - 2021

THE PROPOSAL HAS BEEN CONSIDERED AND APPROVED BY 304th SCREENING COMMITTEE MEETING HELD ON 27.02.2012 VIDE ITEM NO. 08/2012 WITH THE CONDITION: SUBJECT TO MINOR MODIFICATION AND SAME HAS BEEN INCORPORATED AS/ MINUTES

THE SAME HAS BEEN VERIFIED BY DY. DIR (ARCH.) CO-ORDINATION IN FILE NO. DIR (PLG) R/4030/FACILITIES/2011 ON DT: 26.04.12 AT PAGE NO 15/N. sd- 13/4/12 -sd- 13/4/12 AC (PLG) DERP Commr (PLG) (FILE No: DIR (PLG) R/4030/FACILITIES/2011)

PROPOSED LAYOUT PLAN FOR PUBLIC & SEMI PUBLIC POKET (FC-15) AT SECTOR 30, PHASE IV, ROHINI

SCALE 1:2000
DATE FEBRUARY 2012
PLG. ASSTT. / PLG. OFFICER
ASSTT. DIR. (PLG.)
DY. DIR. (PLG.)
DIRECTOR (PLG.)

ROHINI
PROJECT OFFICE NEW DELHI-10085
DRG. NO.: FC-15/30/PHIV