

56/C
57/C

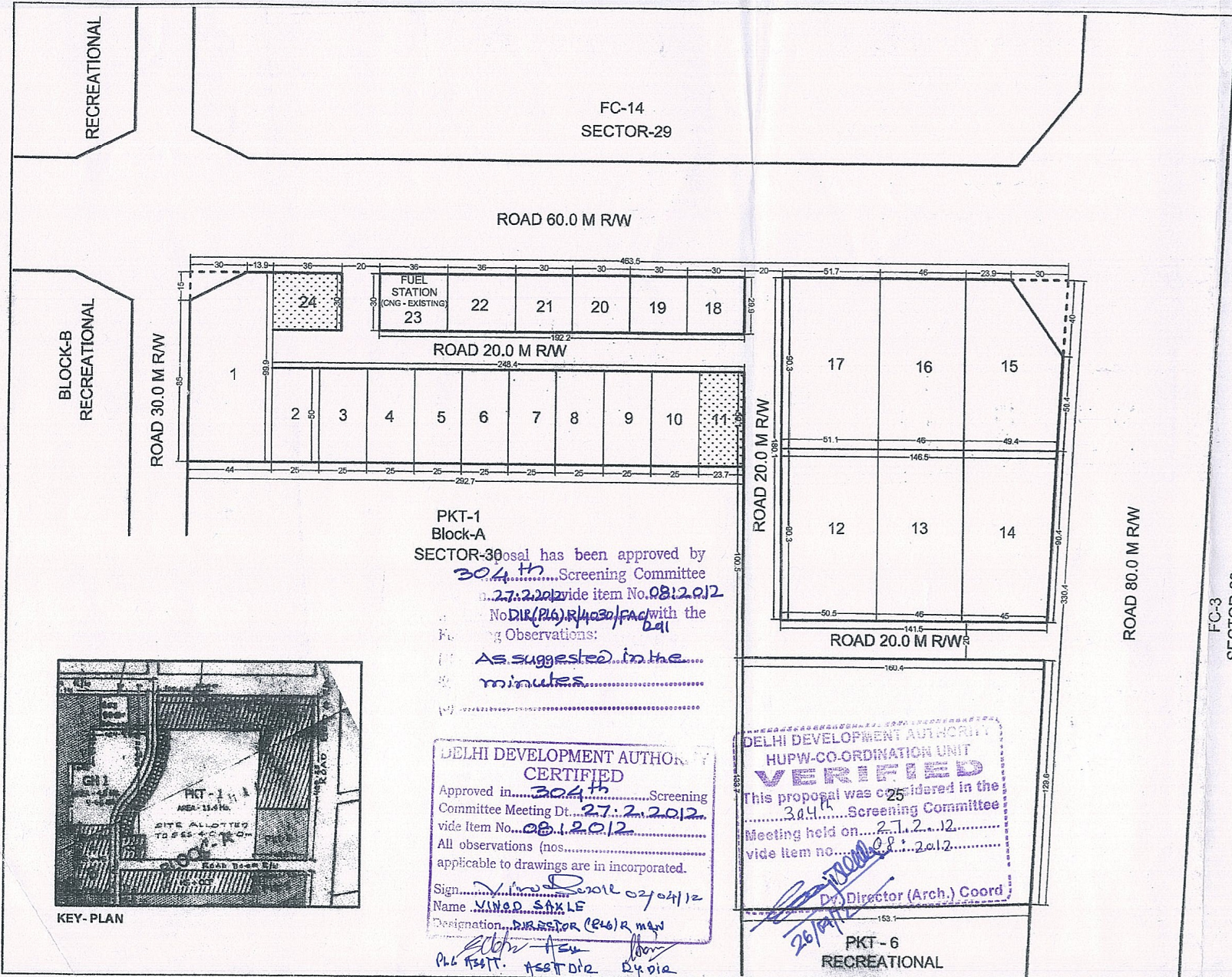

DELHI DEVELOPMENT AUTHORITY
ROHINI PROJECT PLANNING & DESIGN

AREA STATEMENT
TOTAL AREA OF POCKET 8.31 HA
DETAILS OF PLOTS:

PLOT NO	USE	AREA (IN HA)
1	PSP	0.416
2-6	(5 PLOTS) PSP 1250 SQM EACH	0.625
7	FAMILY WELFARE CENTER	0.125
8	PEDIATRIC CENTRE	0.125
9	GERIATRIC CENTRE	0.125
10	DIAGNOSTIC CENTRE	0.125
11	PARK	0.118
12	PSP	0.458
13	PSP	0.415
14	PSP	0.426
15	PARKING BUSES, LMV, IPTS	0.406
16	PSP	0.415
17	HOSPITAL 'D'	0.464
18	BUS TERMINAL	0.090
19-20	(2 PLOTS) PSP 900 SQM EACH	0.180
21	POLICE POST	0.090
22	FUEL STATION (PETROL PUMP)	0.108
23	FUEL STATION (CNG-EXISTING)	0.108
24	PARK	0.108
25	POLICE LINES CIRCULATION	2.601
		1.322

NOTES:

- i) THIS PLAN IS PREPARED BASED ON TOTAL STATION SURVEY OF POCKET FC-15 PROVIDED BY EXECUTIVE ENGINEER, RPD-2, DDA VIDE LETTER No. F50 (62) AE(P) / RPD 2 /DDA/601 DATED 12.05.2011 AND SUBSEQUENTLY VIDE LETTER No. F50 (62) AE(P) / RPD 2/DDA/1314 DATED 17.09.2011.
- ii) SERVICES / UTILITIES ARE TO BE PROVIDED IN PARK.
- iii) DEVELOPMENT CONTROL NORMS AS PER MASTER PLAN FOR DELHI - 2021

THE PROPOSAL HAS BEEN CONSIDERED AND APPROVED BY 304th SCREENING COMMITTEE MEETING HELD ON 27.02.2012 VIDE ITEM NO 08/12012 WITH THE CONDITION: SUBJECT TO MINOR MODIFICATION AND SAME HAS BEEN INCORPORATED AS/MINUTES

FC-3
SECTOR-28

PKT-1
Block-A
SECTOR-30
This proposal has been approved by 304th Screening Committee vide item No. 08/12012 No DIR (PLG) R/4030/FAC with the following Observations:
As suggested in the minutes

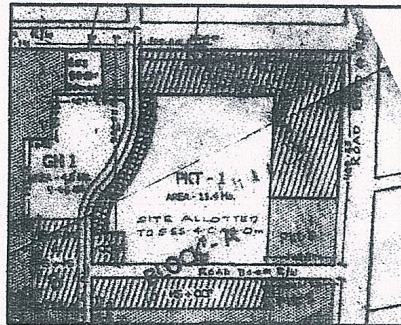

KEY-PLAN

DELHI DEVELOPMENT AUTHORITY
CERTIFIED
Approved in 304th Screening Committee Meeting Dt. 27.2.2012 vide item No. 08/12012 All observations (nos.) applicable to drawings are incorporated.
Sign: Vinod Saxle 02/04/12
Name: VINOD SAXLE
Designation: DIRECTOR (PLG) R/M&P
P.L.G. ASSTT. ASST DIR D.Y. DIR

DELHI DEVELOPMENT AUTHORITY
HUPW-CO-ORDINATION UNIT
VERIFIED
This proposal was considered in the 304th Screening Committee Meeting held on 27.2.2012 vide item no. 08/12012
Dr. Director (Arch.) Coord
26/04/12

PKT-6
RECREATIONAL

PROPOSED LAYOUT PLAN FOR PUBLIC & SEMI PUBLIC POCKET (FC-15) AT SECTOR 30, PHASE IV, ROHINI

SCALE 1:2000
DATE FEBRUARY 2012
PLG. ASSTT. / PLG. OFFICER
ASSTT. DIR. (PLG)
DY. DIR. (PLG)
DIRECTOR (PLG)

ROHINI
PROJECT OFFICE NEW DELHI 110085
DRG. NO.: FC-15/30/PH-IV

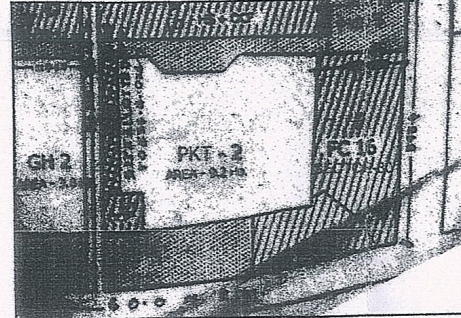
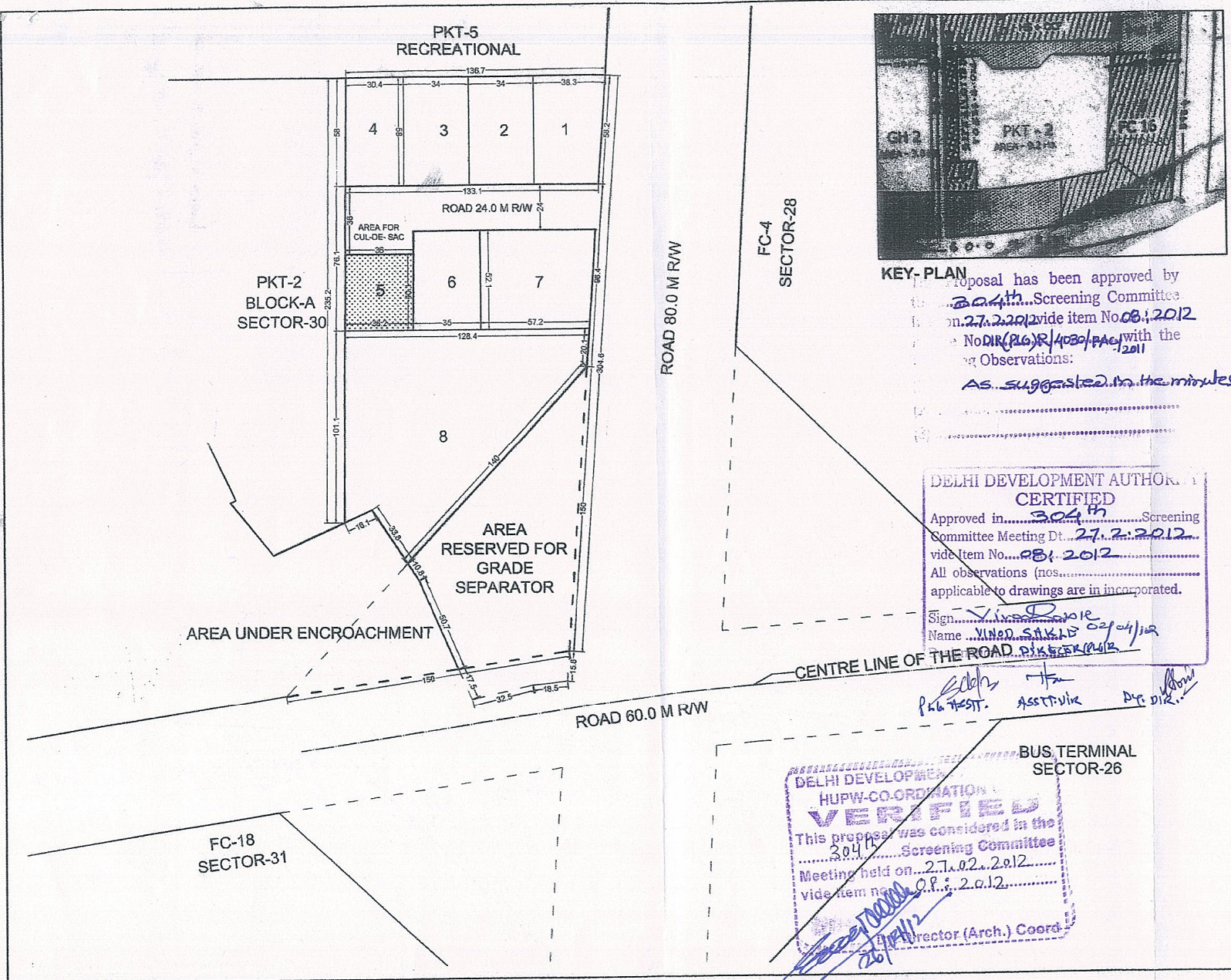

KEY-PLAN
 The proposal has been approved by the 304th Screening Committee on 27.2.2012 vide item No. 08/2012 of the NODIR (PLG) R/4030/FACI/2011 with the following Observations:
 As suggested in the minutes.

DELHI DEVELOPMENT AUTHORITY
CERTIFIED
 Approved in 304th Screening Committee Meeting Dt. 27.2.2012 vide Item No. 08/2012. All observations (nos.) applicable to drawings are incorporated.
 Sign: Vinod Saxena
 Name: VINOD SAXENA
 P.G. TEST. ASST. DIR. P.G. DIR.

DELHI DEVELOPMENT AUTHORITY
HUPW-CO-ORDINATION
VERIFIED
 This proposal was considered in the 304th Screening Committee Meeting held on 27.2.2012 vide item no. 08/2012.
 Director (Arch.) Coord.

DELHI DEVELOPMENT AUTHORITY
ROHINI PROJECT PLANNING & DESIGN

AREA STATEMENT

TOTAL AREA OF POCKET	5.595 HA
1. AREA UNDER BUILTUP	1.977 HA
2. NET AREA OF POCKET	3.618 HA

DETAILS OF PLOTS:

PLOT NO	USE	AREA (IN HA)
1	MULTIPURPOSE COMMUNITY HALL	0.210
2	COMMUNITY RECREATIONAL CLUB	0.197
3	PSP	0.197
4	MATERNITY HOME	0.178
5	PARK	0.144
6	PSP	0.162
7	PSP	0.308
8	PSP	1.017
	CIRCULATION	1.185

- NOTES:**
- THIS PLAN IS PREPARED BASED ON TOTAL STATION SURVEY OF POCKET FC-16 PROVIDED BY EXECUTIVE ENGINEER, RPD-2, DDA VIDE LETTER No. F50 (62) AE(P) / RPD 2 /DDA/601 DATED 12.05.2011 AND SUBSEQUENTLY VIDE LETTER No. F50 (62) AE(P) / RPD 2 /DDA/1314 DATED 17.09.2011.
 - SERVICES / UTILITIES ARE TO BE PROVIDED IN PARK.
 - DEVELOPMENT CONTROL NORMS AS PER MASTER PLAN FOR DELHI - 2021.

THE PROPOSAL HAS BEEN CONSIDERED AND APPROVED BY 304th SCREENING COMMITTEE MEETING HELD ON 27.2.2012 VIDE ITEM NO 08/2012 WITH THE CONDITION SUBJECT TO MINOR MODIFICATION AND SAME HAS BEEN INCORPORATED AS/ MINUTES

Program: 1314/11
 Ac (PLG) V.P.P. Commr (PLG) II
 (FILE No: DIR (PLG) R/4030/FACILITIES/2011)

PROPOSED LAYOUT PLAN FOR PUBLIC & SEMI PUBLIC POCKET (FC-16) AT SECTOR 30, PHASE IV, ROHINI

SCALE	1:2000
DATE	FEBRUARY 2012
PLG. ASSTT. / PLG. OFFICER	[Signature]
ASSTT. DIR. (PLG)	[Signature]
DY. DIR. (PLG)	[Signature]
DIRECTOR (PLG)	[Signature]

ROHINI
 PROJECT OFFICE NEW DELHI 10085

DRG. NO. FC-16/30/PHV