

ROHINI PROJECT PLANNING & DESIGN

AREA STATEMENT

PLOT AREA	2898.00
AREA RESERVED FOR E.S.S. & O.C.F.	652.05
NET AREA AVAIL. FOR SHOPPING	2235.95
PROPOSED ACTUAL COVD. AREA OF G.F. UNDER SHOPS	684.00
ELECTRIC SUB-STATION	243.00
AREA OF O.C.F.	409.05

DETAIL OF SHOPS

TYPE	SIZE	NOS	NO.
S5	3M x 3M	24	4 TO 9, 16 TO 21, 28 TO 33 & 39
S6	3M x 6M	15	1, 2, 11 TO 14, 23 TO 27, 35 TO 37, 46 & 47
S6A	ODD SIZE	3	10, 15, 22, 27 & 34
S6B	ODD SIZE	4	48 TO 51
TOTAL		51	

MILK BOOTH TOILET & DUSTBIN AS PER PLAN

LAT-OUT PLAN  
C.S.I. SECTOR IV

DATE: \_\_\_\_\_  
SCALE 1:200  
APPROVED: \_\_\_\_\_  
PROJECT: \_\_\_\_\_

REVISED ON 25/6/12  
NOTE:  
1. DIMENSIONS OF DIMS HAVE BEEN CHANGED  
2. FOR DETAILS OF DISTRIBUTION REFER TO DB-T/4

REVISED ON 6/1/13  
NOTE:  
1. SPACE FOR ELECTRIC METER BEEN MAINTAINED  
REVISED ON 25/10/13  
NOTE:  
1. DRG. HAS BEEN MODIFIED AS PER SITE CONDITION AS MENTIONED IN THE LETTER OF 15/10/13 NO. FA/188/RPD/DEL/12/13 DATED 26/9/13

NOTE:  
FOR DETAILS OF SHOPS REFER TO AREA STATEMENT

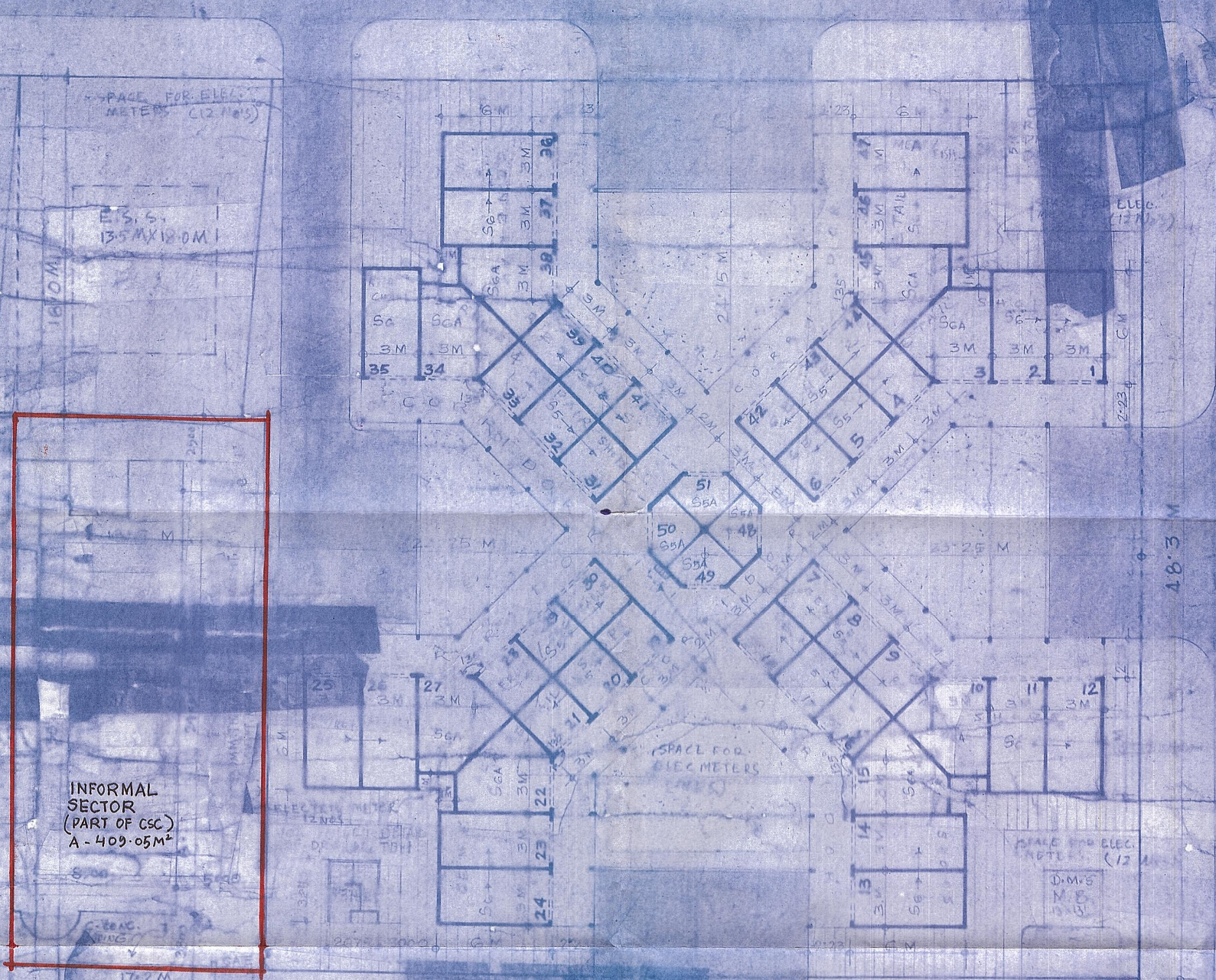

DELHI DEVELOPMENT AUTHORITY  
**CERTIFIED**  
Approved in 309th Screening Committee Meeting Dt. 29.10.12 vide Item No. 106. 2012. All observations applicable to drawings are incorporated.  
Sign: *Vinod Sakle*  
Name: VINOD SAKLE  
Designation: Dir. (P.S.)

The Proposal has been approved by the 309th Screening Committee Meeting held on 29.10.12 vide item No. 106; 2012 in File No. 2012/1003-4/pt. 2/08/Vol II.  
Following Observations:  
(1) The land for Community Hall will be merged with the area of CSC. This part of CSC will be designated to be used by the Informal Sector where no construction will be allowed.

DELHI DEVELOPMENT AUTHORITY  
HELPING INFORMATION UNIT  
This proposal was considered in the 309th Screening Committee Meeting on 29.10.12 vide Item No. 106; 2012.  
Date: 15/11/12  
For (Arch.) Coord.

THE AGENDA FOR COMMUNITY HALL SITE MEASURING 409.05 SQ. M. IS APPROVED BY 309th SCREENING COMMITTEE MEETING HELD ON 29/10/12 VIDE ITEM NO. 106; 2012 WITH THE OBSERVATION THAT THE LAND earmarked FOR COMMUNITY HALL WILL BE MERGED WITH THE AREA OF CSC. THIS PART OF CSC WILL BE DESIGNATED TO BE USED BY THE INFORMAL SECTOR WHERE NO CONSTRUCTION WILL BE ALLOWED.

*KU*  
Pls. Abst.  
*Asst. Dir. (P.S.)*  
*Dy. Dir. (P.S.)*