

Item No. (...110/2011...)

Screening Committee No. (...303...)

Title of the Agenda:

- i) **Proposed Numbering for Public & Semi Public Facilities pockets (FC) in various sectors of Zone-M, Rohini, Phase- III, IV & V.**
- ii) **Modification in Layout Plan of Sector- 34 and Sector-35, Rohini, Phase -V - Regarding Proposed Location of 66 KV Electric Sub- Station.**

File No. Dir (Plg) R/5001/Ph- V/2005

Synopsis

The Public and Semi Public Facilities (PSP) in some of the approved sector plans of Zone – M have been numbered. Retaining the approved numbering, a consolidated numbering plan is being prepared for naming PSP Facilities Pockets (FC) in various sectors of Zone-M, Rohini, Phase- III, IV & V. The proposed numbering plan is placed before Screening Committee for consideration.

Supdtg. Engineer (Electrical)- Elec. Circle-2/DDA has requested for earmarking 4 nos. 66 KV grid Electric Substation in the Layout Plan of Sector- 34 and Sector- 35, Rohini, Phase- V for electrification of these sectors. The proposal of Modification in Layout Plan of Sector- 34 and Sector-35, Rohini, Phase –V - Regarding Proposed Location of four (04 nos.) 66 KV Electric Sub- Station is placed before Screening Committee for consideration.

1.0 BACKGROUND

- i) Rohini Sub-City has been planned on an area of 7407.00 ha approximately with a design population of 16 lakhs Rohini Sub-City consists of two part Zones, namely Zone - H Part (i.e. Phase-I & II) and Zone-M Part (i.e. Phase III, IV & V). Rohini Sub-city is conceived in 5 Phases which includes 41 Sectors (i.e. Phase – I & II consists Sector 1 to 19, Phase – III consists Sector 20 to 25, Phase – IV consists Sector 26 to 33, Phase - V consists Sector 34 to 41). In the approved Landuse Plan of Zone- M, Public and Semi- Public Facilities at Zonal Level have been provided across the sectors of Rohini Phase III, IV & V under PSP Pockets. The PSP Facilities in some of the approved sector plans of Zone – M have been numbered. While preparing a consolidated numbering plan for naming PSP Facilities Pockets (FC) in various sectors of Zone-M, Rohini, Phase- III, IV & V the approved Facility Pockets numbering have to be retained.
- ii) In interaction with Rohini Planning department by DDA Electrical Department, Supdtg. Engineer (Electrical)- Elec. Circle-2/DDA requested for earmarking 4 nos. 66 KV grid Electric Substation in the Layout Plan of Sector- 34 and Sector- 35, Rohini, Phase- V. The tentative location of 66 KV Substation marked on Layout Plan of Sector- 34 and Sector- 35 was approved by M/s NDPL and forwarded by Executive Engineer (Elect), Electrical Division No-IV, DDA wide letter No. ED-IV/DDAW-98/2011/2510 dated 17/11/2011.

2.0 EXAMINATION

- i) The PSP Facilities in some of the approved sector plans of Zone – M, Rohini, Phase III, IV & V have already been numbered. These are: three (03 nos.- FC-9, FC-10 and FC- 11) facility pockets in Sector- 27, eight (08 nos.- FC-1, FC-2, FC-3, FC-4, FC-5, FC-6, FC-7 and FC- 8) facility pockets in Sector-28 and two (02 nos.- FC-16 and FC-17) facility pockets in Sector- 30. In addition in Sector-22, Sector- 25, Sector- 26 and in between Sector 21 & Sector- 22, PSP Schemes were approved and partly developed at site. These were approved PSP areas with respective sector number. These are not included in overall numbering proposal. The remaining PSP Facility pockets are being numbered accordingly as per numeric order.

- ii) In view of the verification of the location of 66- KV grid substation forwarded by Executive Engineer (Elect.), Electrical Division No-IV, DDA wide letter No. ED-IV/DDA/W-98/2011/2510 dated 17/11/2011, the site of 4 nos 66- KV grid substation with area 8000 sq.m (0.80 Ha) each is earmarked on the layout plan of Sector- 34 and Sector- 35, Rohini. The dimension and area of Sector- 34 and Sector- 35 is as per Total Station Survey conducted by Engineering wing incorporated in the Layout Plan. Layout Plan was approved by Screening Committee 247th meeting held on 31/03/2006 vide item no: 39:2006 with subsequent amendments from time to time.

As per Master Plan of Delhi- 2021, for each 1 lakh of population, 2 nos. 66 KV Electric substation needs to be provided. MPD 2021 suggests that as per Central Electricity Authority norms the land requirement for 66 KV Substation is 8600 sq. m (0.86 Ha).

On the layout plan of Sector- 34 and Sector- 35, four (4 nos.) ESS sites are earmarked as per width available which varies from 75.12 m to 87.42 m. However, required area of 8000 sq.m. (0.80 Ha) as desired by Electrical Division DDA has been retained in all the four (04 nos.) proposed ESS sites. Four (4 nos) 66- KV grid substation with area 8000 sq.m (0.80 Ha) each is earmarked on the layout plan of Sector- 34 and Sector- 35. Three (03 nos) 66- KV grid Electric Substation each of area 8000 sq.m. (0.8 Ha) are proposed in Sector-34 of Rohini , Phase- V of which one (01 nos.) ESS is proposed in Public and Semi-Public Facility (PSP) Area under FC-26 and two (02 nos.) ESS are proposed in area earmarked for Community Facility (CF). The remaining one (01 nos.) ESS is proposed in Sector- 35 of Rohini, Phase- V in Public and Semi-Public (PSP) Area under FC-29. The location of electric- substation in the current plan is also been guided by the proximity of the load centres, i.e. EWS housing schemes under construction which shall require electricity within one year time. These EWS houses in Sector- 34 and Sector-35, Rohini are to be released by DDA for allotment very shortly.

As per Master Plan of Delhi- 2021, Utilities are permitted in all the use zones. The landuse of all the four ESS sites as per MPD-2021 and ZDP of Zone 'M' is Public and Semi- Public Facilities (2 sites) and Residential (2 sites). As per approved Sector Plan the Residential area is earmarked for Community Facilities (CF).

3.0 PROPOSAL

- i) The proposed numbering for the PSP Pockets/ Facility Centres (FC) in Sector- 27 to Sector- 41 is placed as per details followed for consideration and approval by the Screening Committee.

19.2/4
303:110:2011

S.No	Sector Name	Facility Pockets Numbering Proposed	Remarks
1	Sector- 27	FC- 9, FC- 10 & FC- 11	- Numbering of all three (03 nos.) pockets is approved in approved Sector Layout Plan.
2	Sector- 28	FC- 1, FC- 2, FC-3 , FC- 4, FC- 5, FC- 6, FC- 7 & FC- 8	- Numbering of all eight (08 nos.) pockets is approved in approved Sector Layout Plan.
3	Sector- 29	FC-12, FC-13, FC-14	- Numbering not approved in approved Sector Layout Plan
4	Sector- 30	FC-15, FC-16, FC-17	- Numbering of two (02 nos.- FC- 16 and FC- 17) pockets is approved in approved Sector Layout Plan.
5	Sector- 31	FC-18 & FC-19	- Numbering not approved in approved Sector Layout Plan
6	Sector- 32	FC-20 & FC-21	- Numbering not approved in approved Sector Layout Plan
7	Sector- 33	FC- 22, FC- 23, FC-24 & FC- 25	- Sector Plan not approved
8	Sector- 34	FC- 26, FC- 27 & FC- 28	- Numbering not approved in approved Sector Layout Plan
9	Sector- 35	FC- 29, FC-30 & FC-31	- Numbering not approved in approved Sector Layout Plan
10	Sector- 36	FC- 32	- Numbering not approved in approved Sector Layout Plan
11	Sector- 38	FC- 33 & FC- 34	- Numbering not approved in approved Sector Layout Plan
12	Sector- 39	FC- 35, FC- 36 & FC- 37	- Sector Plan under preparation
13	Sector- 40	FC- 38, FC- 39 & FC-40	- Sector Plan under preparation
14	Sector- 41	FC- 41, FC- 42, FC- 43 & FC- 44	- Sector Plan under preparation
15	PSP Facility Pocket Near Railway Line (Under Industrial Use)	FC- 45	- PSP Facility Pocket under Industrial Use

ii) The proposed Modification in Layout Plan of Sector- 34 and Sector-35, Rohini, Phase --V incorporating Proposed Location of four (04 nos.) 66 KV grid Electric Sub-Station with an area of 8000 sq.m.(0.80 Ha) each is placed before Screening Committee for consideration.

4.0 FINANCIAL LIABILITY/SOCIAL GAIN

- i) There is no financial implication from planning point of view as the proposal is for numbering of PSP Facility pockets which will ease in planning, designing, execution and allotment of DDA land in Rohini, Phase-III, IV & V.
- ii) There is a social gain in providing sites for ESS as the proposal will help in electrification of Sector-34 and Sector-35, Rohini, Phase- V.

303
Pg. 3/4
11.01.2011

5.0 FOLLOW UP ACTION

- i) After the approval of the numbering of public and Semi-public Pockets/ Facility Centres (FC) in Zone- M, the same numbering will be followed for all future planning, designing and execution work.
- ii) After the approval, the modified Layout Plan will be sent to:
 - Engineering Wing (Civil)/Rohini - For Demarcation & development
 - Land Disposal Wing/DDA - For allotment based on demarcation by Engineering Wing (Civil)/Rohini
 - Engineering Wing (Electrical)/DDA- For Electrification of the Sectors.

303: 110: 2011
19.4/14

Vinod Sakle
 (Vinod Sakle)
 Director (PIg), Rohini
 Zone M&N

P C Soni
 (P C Soni)
 Deputy Director (PIg)
 Rohini

Alka Arya
 (Alka Arya)
 Assistant Director (PIg)/MPR
 Rohini

DELHI DEVELOPMENT AUTHORITY
 HUPW-CO-ORDINATION UNIT
 Approved in..... 303 Screening
 Committee Meeting Dt. 21.12.11
 vide Item no. 110:2011
[Signature]
 Dy. Director (Arch.) Coord
 16/02/12

Approved Minutes of the 303rd screening Committee meeting held on 21.12.11 in Vikas Sadan.

110:2011 Proposed numbering for Public & Semi Public Facilities pockets(FC) in various sectors of Zone-M, Rohini, Ph.-III, IV & V. Modification in layout plan of Sector-34 and 35, Rohini, Ph.-V-regarding proposed location of 66 KV Electric Sub-Station. File no.- Dir.(Plg.)R/5001/Ph.-V/2005.

Presented by:- Director(Planning)Rohini

Proposal for consideration: The Public and semi Public facilities (PSP) in some of the approved sector plans of Zone-M have been numbered. Retaining the approved numbering, a consolidated numbering plan is being prepared for naming PSP facilities pockets (FC) in various sectors of Zone-M, Rohini, Ph.-III, IV and V.

Supdtg. Engineer (Electrical)-Elec. Circle -2/DDA has requested for earmarking 4 nos. 66KVgrid Electric Substation in the layout plan of Sector-34 and Sector-35, Rohini, Ph.-V for electrification of these sectors. The proposed modification in the Layout Plan of Sector -35, Rohini, Phase-V incorporating proposed location of 4nos. of 66 KV electric substation with an area of 8000sqm(0.8 hac) each is put up for consideration. The proposed numbering for the PSP Pockets/Facility Centres (FC) in Sector- 27 to Sector - 41 is as reflected in the agenda.

Decision of Screening Committee: The proposal as reflected in the agenda was approved.

Follow up Action: The approved numbering of Public and Semi-Public Pockets/Facilities (FC) in Zone-M will be followed in all future planning designing and execution work. The approved plan will be sent to the engineering Wing(civil) Rohini for demarcation and development, to Land disposal Wing for allotment based on demarcation, to the electrical Wing for electrification of the Sectors.

DELHI DEVELOPMENT AUTHORITY
HUPW-CO ORDINATION UNIT
Approved in 3.03 Screening
Committee Meeting Dt. 21.12.11
vide Item no. 110:2011
By Director (Arch.) Coord
16/02/12

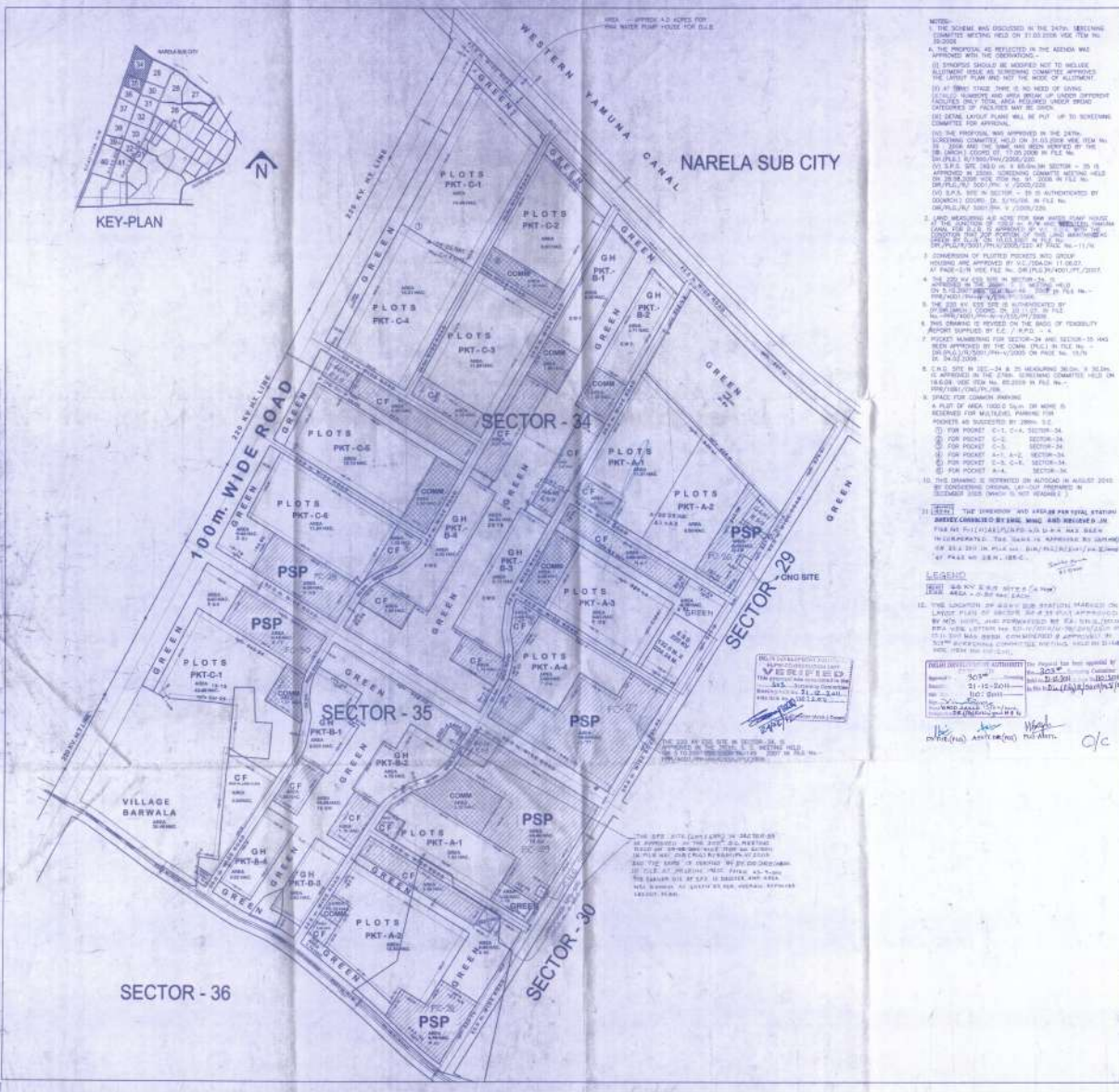

NOTES:

- THE SCHEME WAS SUBMITTED IN THE 24TH BIDDING COMPETITIVE BIDDING MEET ON 21.08.2008 AND THE BIDDING WAS APPROVED WITH THE OBSERVATIONS.
- IF CHANGES SHOULD BE REQUIRED IN THE SCHEME, THE SAME SHALL BE APPROVED BY THE DEVELOPMENT AUTHORITY AFTER CONSULTING THE CONCERNED DEPTTS.
- AT FINAL STAGE THERE IS NO NEED OF OBTAINING APPROVAL FROM THE CONCERNED DEPTTS FOR THE PROPOSED CHANGES.
- THE DETAILED LAYOUT PLANS WILL BE PUT UP TO RECEIVE COMMENTS FOR APPROVAL.
- THE PROPOSAL WAS APPROVED IN THE 24TH BIDDING COMPETITIVE BIDDING MEET ON 21.08.2008 AND THE BIDDING WAS APPROVED WITH THE OBSERVATIONS.
- IF CHANGES SHOULD BE REQUIRED IN THE SCHEME, THE SAME SHALL BE APPROVED BY THE DEVELOPMENT AUTHORITY AFTER CONSULTING THE CONCERNED DEPTTS.
- AT FINAL STAGE THERE IS NO NEED OF OBTAINING APPROVAL FROM THE CONCERNED DEPTTS FOR THE PROPOSED CHANGES.
- THE DETAILED LAYOUT PLANS WILL BE PUT UP TO RECEIVE COMMENTS FOR APPROVAL.
- THE PROPOSAL WAS APPROVED IN THE 24TH BIDDING COMPETITIVE BIDDING MEET ON 21.08.2008 AND THE BIDDING WAS APPROVED WITH THE OBSERVATIONS.
- IF CHANGES SHOULD BE REQUIRED IN THE SCHEME, THE SAME SHALL BE APPROVED BY THE DEVELOPMENT AUTHORITY AFTER CONSULTING THE CONCERNED DEPTTS.
- AT FINAL STAGE THERE IS NO NEED OF OBTAINING APPROVAL FROM THE CONCERNED DEPTTS FOR THE PROPOSED CHANGES.
- THE DETAILED LAYOUT PLANS WILL BE PUT UP TO RECEIVE COMMENTS FOR APPROVAL.

LEGEND

- RESIDENTIAL (Plotted)
- RESIDENTIAL (Group Housing)
- COMMERCIAL
- RECREATIONAL
- PUBLIC & SEMI PUBLIC FACILITIES
- COMMUNITY FACILITY

DELHI DEVELOPMENT AUTHORITY
ROHINI PROJECT PLANNING AND DESIGN

LANDUSE AREA STATEMENT OF SECTOR - 34
A. TOTAL AREA OF SECTOR 34 318.40 HAC
B. LANDUSE BREAKUP OF AREA UNDER SECTOR - 34

LANDUSE	AREA (HAC)	PERCENTAGE
RESIDENTIAL (GROUP)	214.6826	67.45
COMMERCIAL	52.0818	16.35
PUBLIC / SEMI PUBLIC	27.0328	8.49
RECREATIONAL	18.4046	5.78
UTILITIES	26.0022	8.10
TOTAL	318.2040	100

C. LANDUSE BREAKUP OF GROSS RESIDENTIAL AREA

LANDUSE	AREA (HAC)	PERCENTAGE
RESIDENTIAL (NET)	132.2418	61.62
COMMON	12.0818	5.73
PUBLIC / SEMI PUBLIC	11.1128	5.37
RECREATIONAL	10.2428	4.84
UTILITIES	15.5628	7.38
TOTAL	171.2422	100

D. DISTRIBUTION OF NET RESIDENTIAL AREA

NET AREA (HAC)	NO.	PERCENTAGE	POPULATION
GROUP HOUSING	212	12.5	1074
INDIVIDUAL HOUSING	222	12.9	1318
TOTAL	434	25.4	2392

E. TOTAL NO. OF PROPOSED DUA IN SECTOR 34 2324
F. TOTAL NO. OF PROPOSED PLOTS 1264
G. TOTAL PROPOSED POPULATION FOR SECTOR 34 14883

LANDUSE AREA STATEMENT OF SECTOR - 35
A. TOTAL AREA OF SECTOR 35 175.00 HAC
B. LANDUSE BREAKUP OF AREA UNDER SECTOR - 35

LANDUSE	AREA (HAC)	PERCENTAGE
RESIDENTIAL (GROUP)	128.1233	72.64
COMMERCIAL	28.8218	16.47
PUBLIC / SEMI PUBLIC	15.8128	9.03
RECREATIONAL	10.2428	5.85
UTILITIES	22.0022	12.57
TOTAL	175.00	100

C. LANDUSE BREAKUP OF GROSS RESIDENTIAL AREA

LANDUSE	AREA (HAC)	PERCENTAGE
RESIDENTIAL (NET)	64.0616	36.31
COMMON	5.7618	3.29
PUBLIC / SEMI PUBLIC	7.9068	4.52
RECREATIONAL	5.1218	2.93
UTILITIES	11.0528	6.32
TOTAL	94.9048	53.77

D. DISTRIBUTION OF NET RESIDENTIAL AREA

NET AREA (HAC)	NO.	PERCENTAGE	POPULATION
GROUP HOUSING	184	10.5	1597
INDIVIDUAL HOUSING	184	10.5	1867
TOTAL	368	21.0	3464

E. TOTAL NO. OF PROPOSED DUA IN SECTOR 35 1444
F. TOTAL NO. OF PROPOSED PLOTS 722
G. TOTAL PROPOSED POPULATION FOR SECTOR 35 8947

LAYOUT PLAN OF SECTOR - 34 AND SECTOR - 35, PHASE V, ROHINI

DATE: 21.08.08
SCALE: 1:1000
PROJECT NO: 21.08.08
DRAWN BY: [Signature]
CHECKED BY: [Signature]
APPROVED BY: [Signature]

224/c

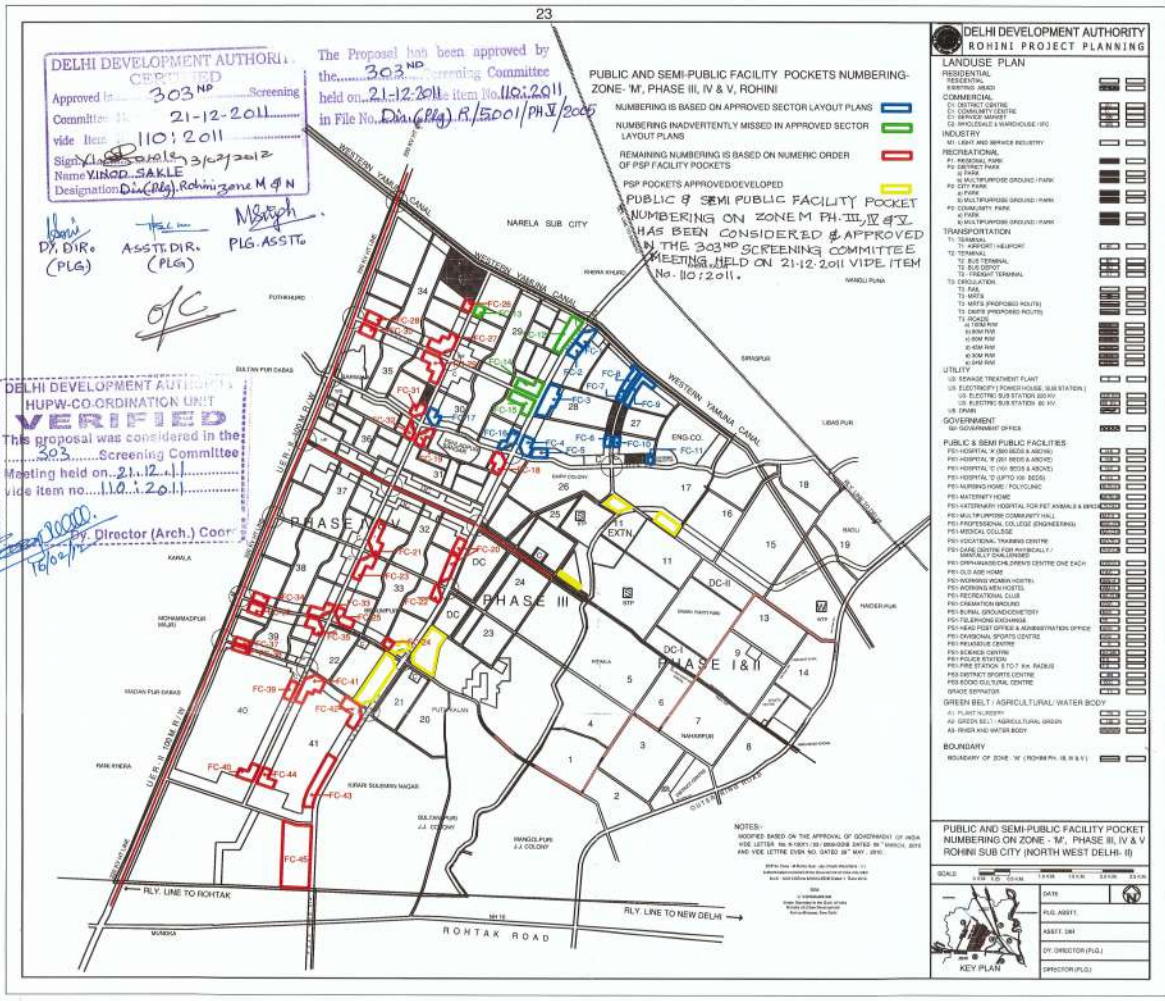

DELHI DEVELOPMENT AUTHORITY
 CIRCULAR
 Approved by 303ND Screening Committee on 21-12-2011
 vide Item No. 110:2011
 Signed by Vinod Sakle 3/12/2012
 Name VINOD SAKLE
 Designation Dir.(PLG), Rohini Zone M & N

The Proposal has been approved by the 303ND Screening Committee held on 21-12-2011 vide item No. 110:2011 in File No. Dir.(PLG) R/15001/PH.IV/2005

PUBLIC AND SEMI-PUBLIC FACILITY POCKETS NUMBERING - ZONE 'M', PHASE III, IV & V, ROHINI
 NUMBERING IS BASED ON APPROVED SECTOR LAYOUT PLANS
 NUMBERING INADVERTENTLY MISSED IN APPROVED SECTOR LAYOUT PLANS
 REMAINING NUMBERING IS BASED ON NUMERIC ORDER OF PSP FACILITY POCKETS
 PSP POCKETS APPROVED/DEVELOPED
 PUBLIC & SEMI-PUBLIC FACILITY POCKET NUMBERING ON ZONE M PH. II, IV & V HAS BEEN CONSIDERED & APPROVED IN THE 303ND SCREENING COMMITTEE MEETING HELD ON 21-12-2011 VIDE ITEM No. 110:2011.

DELHI DEVELOPMENT AUTHORITY
 HUPW-CO-ORDINATION UNIT
VERIFIED
 This proposal was considered in the 303ND Screening Committee Meeting held on 21-12-11 vide item no. 110:2011
 By Director (Arch.) Coord. 16/01/12

Handwritten signatures and initials:
 D.V. DIR. (PLG)
 ASSTT. DIR. (PLG)
 M. Singh
 PLG. ASSTT.
 o/c

**DELHI DEVELOPMENT AUTHORITY
 ROHINI PROJECT PLANNING**

LANDUSE PLAN

RESIDENTIAL
 R1 RESIDENTIAL
 R2 RESIDENTIAL
 R3 RESIDENTIAL
 R4 RESIDENTIAL
 R5 RESIDENTIAL
 R6 RESIDENTIAL
 R7 RESIDENTIAL
 R8 RESIDENTIAL
 R9 RESIDENTIAL
 R10 RESIDENTIAL
 R11 RESIDENTIAL
 R12 RESIDENTIAL
 R13 RESIDENTIAL
 R14 RESIDENTIAL
 R15 RESIDENTIAL
 R16 RESIDENTIAL
 R17 RESIDENTIAL
 R18 RESIDENTIAL
 R19 RESIDENTIAL
 R20 RESIDENTIAL
 R21 RESIDENTIAL
 R22 RESIDENTIAL
 R23 RESIDENTIAL
 R24 RESIDENTIAL
 R25 RESIDENTIAL
 R26 RESIDENTIAL
 R27 RESIDENTIAL
 R28 RESIDENTIAL
 R29 RESIDENTIAL
 R30 RESIDENTIAL
 R31 RESIDENTIAL
 R32 RESIDENTIAL
 R33 RESIDENTIAL
 R34 RESIDENTIAL
 R35 RESIDENTIAL
 R36 RESIDENTIAL
 R37 RESIDENTIAL
 R38 RESIDENTIAL
 R39 RESIDENTIAL
 R40 RESIDENTIAL
 R41 RESIDENTIAL
 R42 RESIDENTIAL
 R43 RESIDENTIAL
 R44 RESIDENTIAL
 R45 RESIDENTIAL
 R46 RESIDENTIAL
 R47 RESIDENTIAL
 R48 RESIDENTIAL
 R49 RESIDENTIAL
 R50 RESIDENTIAL

COMMERCIAL
 C1 COMMERCIAL
 C2 COMMERCIAL
 C3 COMMERCIAL
 C4 COMMERCIAL
 C5 COMMERCIAL
 C6 COMMERCIAL
 C7 COMMERCIAL
 C8 COMMERCIAL
 C9 COMMERCIAL
 C10 COMMERCIAL
 C11 COMMERCIAL
 C12 COMMERCIAL
 C13 COMMERCIAL
 C14 COMMERCIAL
 C15 COMMERCIAL
 C16 COMMERCIAL
 C17 COMMERCIAL
 C18 COMMERCIAL
 C19 COMMERCIAL
 C20 COMMERCIAL
 C21 COMMERCIAL
 C22 COMMERCIAL
 C23 COMMERCIAL
 C24 COMMERCIAL
 C25 COMMERCIAL
 C26 COMMERCIAL
 C27 COMMERCIAL
 C28 COMMERCIAL
 C29 COMMERCIAL
 C30 COMMERCIAL
 C31 COMMERCIAL
 C32 COMMERCIAL
 C33 COMMERCIAL
 C34 COMMERCIAL
 C35 COMMERCIAL
 C36 COMMERCIAL
 C37 COMMERCIAL
 C38 COMMERCIAL
 C39 COMMERCIAL
 C40 COMMERCIAL
 C41 COMMERCIAL
 C42 COMMERCIAL
 C43 COMMERCIAL
 C44 COMMERCIAL
 C45 COMMERCIAL
 C46 COMMERCIAL
 C47 COMMERCIAL
 C48 COMMERCIAL
 C49 COMMERCIAL
 C50 COMMERCIAL

INDUSTRY
 I1 LIGHT AND SERVICE INDUSTRY
 I2 LIGHT AND SERVICE INDUSTRY
 I3 LIGHT AND SERVICE INDUSTRY
 I4 LIGHT AND SERVICE INDUSTRY
 I5 LIGHT AND SERVICE INDUSTRY
 I6 LIGHT AND SERVICE INDUSTRY
 I7 LIGHT AND SERVICE INDUSTRY
 I8 LIGHT AND SERVICE INDUSTRY
 I9 LIGHT AND SERVICE INDUSTRY
 I10 LIGHT AND SERVICE INDUSTRY
 I11 LIGHT AND SERVICE INDUSTRY
 I12 LIGHT AND SERVICE INDUSTRY
 I13 LIGHT AND SERVICE INDUSTRY
 I14 LIGHT AND SERVICE INDUSTRY
 I15 LIGHT AND SERVICE INDUSTRY
 I16 LIGHT AND SERVICE INDUSTRY
 I17 LIGHT AND SERVICE INDUSTRY
 I18 LIGHT AND SERVICE INDUSTRY
 I19 LIGHT AND SERVICE INDUSTRY
 I20 LIGHT AND SERVICE INDUSTRY
 I21 LIGHT AND SERVICE INDUSTRY
 I22 LIGHT AND SERVICE INDUSTRY
 I23 LIGHT AND SERVICE INDUSTRY
 I24 LIGHT AND SERVICE INDUSTRY
 I25 LIGHT AND SERVICE INDUSTRY
 I26 LIGHT AND SERVICE INDUSTRY
 I27 LIGHT AND SERVICE INDUSTRY
 I28 LIGHT AND SERVICE INDUSTRY
 I29 LIGHT AND SERVICE INDUSTRY
 I30 LIGHT AND SERVICE INDUSTRY
 I31 LIGHT AND SERVICE INDUSTRY
 I32 LIGHT AND SERVICE INDUSTRY
 I33 LIGHT AND SERVICE INDUSTRY
 I34 LIGHT AND SERVICE INDUSTRY
 I35 LIGHT AND SERVICE INDUSTRY
 I36 LIGHT AND SERVICE INDUSTRY
 I37 LIGHT AND SERVICE INDUSTRY
 I38 LIGHT AND SERVICE INDUSTRY
 I39 LIGHT AND SERVICE INDUSTRY
 I40 LIGHT AND SERVICE INDUSTRY
 I41 LIGHT AND SERVICE INDUSTRY
 I42 LIGHT AND SERVICE INDUSTRY
 I43 LIGHT AND SERVICE INDUSTRY
 I44 LIGHT AND SERVICE INDUSTRY
 I45 LIGHT AND SERVICE INDUSTRY
 I46 LIGHT AND SERVICE INDUSTRY
 I47 LIGHT AND SERVICE INDUSTRY
 I48 LIGHT AND SERVICE INDUSTRY
 I49 LIGHT AND SERVICE INDUSTRY
 I50 LIGHT AND SERVICE INDUSTRY

RECREATIONAL
 R1 RECREATIONAL
 R2 RECREATIONAL
 R3 RECREATIONAL
 R4 RECREATIONAL
 R5 RECREATIONAL
 R6 RECREATIONAL
 R7 RECREATIONAL
 R8 RECREATIONAL
 R9 RECREATIONAL
 R10 RECREATIONAL
 R11 RECREATIONAL
 R12 RECREATIONAL
 R13 RECREATIONAL
 R14 RECREATIONAL
 R15 RECREATIONAL
 R16 RECREATIONAL
 R17 RECREATIONAL
 R18 RECREATIONAL
 R19 RECREATIONAL
 R20 RECREATIONAL
 R21 RECREATIONAL
 R22 RECREATIONAL
 R23 RECREATIONAL
 R24 RECREATIONAL
 R25 RECREATIONAL
 R26 RECREATIONAL
 R27 RECREATIONAL
 R28 RECREATIONAL
 R29 RECREATIONAL
 R30 RECREATIONAL
 R31 RECREATIONAL
 R32 RECREATIONAL
 R33 RECREATIONAL
 R34 RECREATIONAL
 R35 RECREATIONAL
 R36 RECREATIONAL
 R37 RECREATIONAL
 R38 RECREATIONAL
 R39 RECREATIONAL
 R40 RECREATIONAL
 R41 RECREATIONAL
 R42 RECREATIONAL
 R43 RECREATIONAL
 R44 RECREATIONAL
 R45 RECREATIONAL
 R46 RECREATIONAL
 R47 RECREATIONAL
 R48 RECREATIONAL
 R49 RECREATIONAL
 R50 RECREATIONAL

TRANSPORTATION
 T1 TRANSPORTATION
 T2 TRANSPORTATION
 T3 TRANSPORTATION
 T4 TRANSPORTATION
 T5 TRANSPORTATION
 T6 TRANSPORTATION
 T7 TRANSPORTATION
 T8 TRANSPORTATION
 T9 TRANSPORTATION
 T10 TRANSPORTATION
 T11 TRANSPORTATION
 T12 TRANSPORTATION
 T13 TRANSPORTATION
 T14 TRANSPORTATION
 T15 TRANSPORTATION
 T16 TRANSPORTATION
 T17 TRANSPORTATION
 T18 TRANSPORTATION
 T19 TRANSPORTATION
 T20 TRANSPORTATION
 T21 TRANSPORTATION
 T22 TRANSPORTATION
 T23 TRANSPORTATION
 T24 TRANSPORTATION
 T25 TRANSPORTATION
 T26 TRANSPORTATION
 T27 TRANSPORTATION
 T28 TRANSPORTATION
 T29 TRANSPORTATION
 T30 TRANSPORTATION
 T31 TRANSPORTATION
 T32 TRANSPORTATION
 T33 TRANSPORTATION
 T34 TRANSPORTATION
 T35 TRANSPORTATION
 T36 TRANSPORTATION
 T37 TRANSPORTATION
 T38 TRANSPORTATION
 T39 TRANSPORTATION
 T40 TRANSPORTATION
 T41 TRANSPORTATION
 T42 TRANSPORTATION
 T43 TRANSPORTATION
 T44 TRANSPORTATION
 T45 TRANSPORTATION
 T46 TRANSPORTATION
 T47 TRANSPORTATION
 T48 TRANSPORTATION
 T49 TRANSPORTATION
 T50 TRANSPORTATION

UTILITY
 U1 UTILITY
 U2 UTILITY
 U3 UTILITY
 U4 UTILITY
 U5 UTILITY
 U6 UTILITY
 U7 UTILITY
 U8 UTILITY
 U9 UTILITY
 U10 UTILITY
 U11 UTILITY
 U12 UTILITY
 U13 UTILITY
 U14 UTILITY
 U15 UTILITY
 U16 UTILITY
 U17 UTILITY
 U18 UTILITY
 U19 UTILITY
 U20 UTILITY
 U21 UTILITY
 U22 UTILITY
 U23 UTILITY
 U24 UTILITY
 U25 UTILITY
 U26 UTILITY
 U27 UTILITY
 U28 UTILITY
 U29 UTILITY
 U30 UTILITY
 U31 UTILITY
 U32 UTILITY
 U33 UTILITY
 U34 UTILITY
 U35 UTILITY
 U36 UTILITY
 U37 UTILITY
 U38 UTILITY
 U39 UTILITY
 U40 UTILITY
 U41 UTILITY
 U42 UTILITY
 U43 UTILITY
 U44 UTILITY
 U45 UTILITY
 U46 UTILITY
 U47 UTILITY
 U48 UTILITY
 U49 UTILITY
 U50 UTILITY

GOVERNMENT
 G1 GOVERNMENT
 G2 GOVERNMENT
 G3 GOVERNMENT
 G4 GOVERNMENT
 G5 GOVERNMENT
 G6 GOVERNMENT
 G7 GOVERNMENT
 G8 GOVERNMENT
 G9 GOVERNMENT
 G10 GOVERNMENT
 G11 GOVERNMENT
 G12 GOVERNMENT
 G13 GOVERNMENT
 G14 GOVERNMENT
 G15 GOVERNMENT
 G16 GOVERNMENT
 G17 GOVERNMENT
 G18 GOVERNMENT
 G19 GOVERNMENT
 G20 GOVERNMENT
 G21 GOVERNMENT
 G22 GOVERNMENT
 G23 GOVERNMENT
 G24 GOVERNMENT
 G25 GOVERNMENT
 G26 GOVERNMENT
 G27 GOVERNMENT
 G28 GOVERNMENT
 G29 GOVERNMENT
 G30 GOVERNMENT
 G31 GOVERNMENT
 G32 GOVERNMENT
 G33 GOVERNMENT
 G34 GOVERNMENT
 G35 GOVERNMENT
 G36 GOVERNMENT
 G37 GOVERNMENT
 G38 GOVERNMENT
 G39 GOVERNMENT
 G40 GOVERNMENT
 G41 GOVERNMENT
 G42 GOVERNMENT
 G43 GOVERNMENT
 G44 GOVERNMENT
 G45 GOVERNMENT
 G46 GOVERNMENT
 G47 GOVERNMENT
 G48 GOVERNMENT
 G49 GOVERNMENT
 G50 GOVERNMENT

PUBLIC & SEMI-PUBLIC FACILITIES
 P1 PUBLIC & SEMI-PUBLIC FACILITIES
 P2 PUBLIC & SEMI-PUBLIC FACILITIES
 P3 PUBLIC & SEMI-PUBLIC FACILITIES
 P4 PUBLIC & SEMI-PUBLIC FACILITIES
 P5 PUBLIC & SEMI-PUBLIC FACILITIES
 P6 PUBLIC & SEMI-PUBLIC FACILITIES
 P7 PUBLIC & SEMI-PUBLIC FACILITIES
 P8 PUBLIC & SEMI-PUBLIC FACILITIES
 P9 PUBLIC & SEMI-PUBLIC FACILITIES
 P10 PUBLIC & SEMI-PUBLIC FACILITIES
 P11 PUBLIC & SEMI-PUBLIC FACILITIES
 P12 PUBLIC & SEMI-PUBLIC FACILITIES
 P13 PUBLIC & SEMI-PUBLIC FACILITIES
 P14 PUBLIC & SEMI-PUBLIC FACILITIES
 P15 PUBLIC & SEMI-PUBLIC FACILITIES
 P16 PUBLIC & SEMI-PUBLIC FACILITIES
 P17 PUBLIC & SEMI-PUBLIC FACILITIES
 P18 PUBLIC & SEMI-PUBLIC FACILITIES
 P19 PUBLIC & SEMI-PUBLIC FACILITIES
 P20 PUBLIC & SEMI-PUBLIC FACILITIES
 P21 PUBLIC & SEMI-PUBLIC FACILITIES
 P22 PUBLIC & SEMI-PUBLIC FACILITIES
 P23 PUBLIC & SEMI-PUBLIC FACILITIES
 P24 PUBLIC & SEMI-PUBLIC FACILITIES
 P25 PUBLIC & SEMI-PUBLIC FACILITIES
 P26 PUBLIC & SEMI-PUBLIC FACILITIES
 P27 PUBLIC & SEMI-PUBLIC FACILITIES
 P28 PUBLIC & SEMI-PUBLIC FACILITIES
 P29 PUBLIC & SEMI-PUBLIC FACILITIES
 P30 PUBLIC & SEMI-PUBLIC FACILITIES
 P31 PUBLIC & SEMI-PUBLIC FACILITIES
 P32 PUBLIC & SEMI-PUBLIC FACILITIES
 P33 PUBLIC & SEMI-PUBLIC FACILITIES
 P34 PUBLIC & SEMI-PUBLIC FACILITIES
 P35 PUBLIC & SEMI-PUBLIC FACILITIES
 P36 PUBLIC & SEMI-PUBLIC FACILITIES
 P37 PUBLIC & SEMI-PUBLIC FACILITIES
 P38 PUBLIC & SEMI-PUBLIC FACILITIES
 P39 PUBLIC & SEMI-PUBLIC FACILITIES
 P40 PUBLIC & SEMI-PUBLIC FACILITIES
 P41 PUBLIC & SEMI-PUBLIC FACILITIES
 P42 PUBLIC & SEMI-PUBLIC FACILITIES
 P43 PUBLIC & SEMI-PUBLIC FACILITIES
 P44 PUBLIC & SEMI-PUBLIC FACILITIES
 P45 PUBLIC & SEMI-PUBLIC FACILITIES
 P46 PUBLIC & SEMI-PUBLIC FACILITIES
 P47 PUBLIC & SEMI-PUBLIC FACILITIES
 P48 PUBLIC & SEMI-PUBLIC FACILITIES
 P49 PUBLIC & SEMI-PUBLIC FACILITIES
 P50 PUBLIC & SEMI-PUBLIC FACILITIES

BOUNDARY
 B1 BOUNDARY
 B2 BOUNDARY
 B3 BOUNDARY
 B4 BOUNDARY
 B5 BOUNDARY
 B6 BOUNDARY
 B7 BOUNDARY
 B8 BOUNDARY
 B9 BOUNDARY
 B10 BOUNDARY
 B11 BOUNDARY
 B12 BOUNDARY
 B13 BOUNDARY
 B14 BOUNDARY
 B15 BOUNDARY
 B16 BOUNDARY
 B17 BOUNDARY
 B18 BOUNDARY
 B19 BOUNDARY
 B20 BOUNDARY
 B21 BOUNDARY
 B22 BOUNDARY
 B23 BOUNDARY
 B24 BOUNDARY
 B25 BOUNDARY
 B26 BOUNDARY
 B27 BOUNDARY
 B28 BOUNDARY
 B29 BOUNDARY
 B30 BOUNDARY
 B31 BOUNDARY
 B32 BOUNDARY
 B33 BOUNDARY
 B34 BOUNDARY
 B35 BOUNDARY
 B36 BOUNDARY
 B37 BOUNDARY
 B38 BOUNDARY
 B39 BOUNDARY
 B40 BOUNDARY
 B41 BOUNDARY
 B42 BOUNDARY
 B43 BOUNDARY
 B44 BOUNDARY
 B45 BOUNDARY
 B46 BOUNDARY
 B47 BOUNDARY
 B48 BOUNDARY
 B49 BOUNDARY
 B50 BOUNDARY

NOTES:
 1. NUMBERING IS BASED ON THE APPROVAL OF GOVERNMENT OF INDIA AND LETTER NO. 10001/101/2005 DATED 18.05.2005 AND VIDE LETTER NO. 10001/101/2005 DATED 18.05.2005.

PUBLIC AND SEMI-PUBLIC FACILITY POCKET NUMBERING ON ZONE - 'M', PHASE III, IV & V ROHINI SUB CITY (NORTH WEST DELHI - II)

SCALE: 1:10000
 DATE: 16/01/12
 PREPARED BY: [Signature]
 CHECKED BY: [Signature]
 APPROVED BY: [Signature]
 KEY PLAN

dc