

Item No. 104:2011
Screening Committee No. 302

Title of Agenda: Proposed Layout Plans for Public & Semi Public Facilities pocket at Sector-27 (FC-9) & Sector-28 (FC-3, FC-4 & FC-5) Rohini PH-IV

File No. Dir.(Plg.)R/4001/Ph-IV/Pt./2005.

Synopsis

In composite sector plan of Sector-27 & 28, Rohini there are total eleven (11) pockets, three (03) in Sector-27 & eight (08) in Sector-28 proposed for Public & Semi Public facilities. The proposed Layout Plans for Six pockets, one in Sector-27 (FC-9) & Five in Sector-28 Rohini, Phase-IV were placed before 298th Screening Committee Meeting held on 26.04.11 vide item No.25:2011. The item was discussed, and it was decided that the proposal be put up again in Screening Committee after due incorporation of the area confirmed through Total Station Survey. The current proposal based on Total Station Survey of Layout Plans for Four (4) Facilities Pockets as given in Agenda are placed before the Screening Committee for consideration & approval.

1.0 BACKGROUND:

In the approved composite sector plan of Sector 27 & 28, Rohini, the provisions has been made for Public & Semi Public facilities at Zonal level. Layout plan of these facilities pockets needs to be designed by proposing the various Zonal level facilities as per MPD-2021.

In the approved composite sector plan of Sector-27 & 28, Rohini, some facilities were proposed in the said pockets as per MPD-2001. Now the facilities are proposed as per MPD-2021.

In the 298th Screening Committee Meeting held on 26.04.11, six (6) Pockets, Layout Plan for Public & Semi Public Facilities areas i.e. Sector-27 (FC-9) & Sector-28 (FC-1, FC-2, FC-3, FC-4 & FC-5) were placed as an agenda item. The Layout Plan of FC-1 & FC-2 will be prepared once the matter regarding dovetailing (between Rohini & Narela) of UER-III (80mtr R/W) is finalised and approved by Technical Committee, DDA. The remaining Five pockets Two(2) in Sector-27 & one(1) in Sector-28 are fully built up (unauthorised colony), and two pockets in Sector-28 are already approved by Screening Committee.

Pg. 1/5

2.0 EXAMINATION:

The Composite Sector plan of sector-27 & 28, Rohini was approved in 215th Screening Committee held on 25.07.2001 vide item No.31:2001 in file No.PP/R/4001/2001. In the approved composite Sector Plan of Sector-27 & 28 Rohini, an area measuring 45 Hac (7.5 Ha in Sector-27 & 37.5 Ha in Sector-28) earmarked for Public & Semi Public area at Zonal level in eleven pockets with specifying FC-9 to FC-11 in Sector-27 & FC-1 to FC-8 in Sector-28. The Landuse of all the pockets is "Public & Semi Public Facilities" as per MPD-2021 and approved Zonal Development plan of Zone-'M'.

In the three pockets in Sector-27 two pockets (FC-10, FC11) are fully build up (unauthorised colony, Shahbad Extn). As such no Layout Plan is to be prepared at this stage. Similarly FC-9 is also partly built up, as such, the proposal requires to be planned for remaining area. The area adjacent to built up has been taken as per Total Station Survey provided by Rohini Engineering Wing.

In the eight pockets in Sector-28 one pocket FC-6 is fully built up (unauthorised colony, Shahbad Extn) and two pockets FC-7 & FC-8 were earlier approved in the 243rd Screening Committee held on 29.11.2005 vide item No.109:2005 in file No.Dir.(Plg.)R/4028/Blk-C/PSP/2005 in which neighbourhood level facilities were proposed, as such no Layout plan is to be prepared at this stage.

In the total Station Survey of FC-3, Sector-28 forwarded by Engineering Wing, Rohini on 20.05.11, a Nallah has been shown passing through proposed scheme area. The matter was taken up for clarification from Engineering Wing Rohini. The Nallah is to be abandoned as per the overall development of Sector-27 & 28, Rohini as intimated by Rohini Engineering Wing.

One Pocket FC-4 Sector-28 is at junction of proposed 80mtr. Road and 60mtr. Road. As per Landuse Plan of approved Zonal Development Plan of Zone-M at various Junctions provision for Inter-section/Grade Separator requires to be made. In the earlier scheme of FC-4 no reservation for inter-section design was kept. However, the reservation for inter-section design in the scheme based on Total Station Survey has been considered. Such provision of reservation at Junctions requires to be considered for all the inter-section design on all the major arterial Road as indicated in the Landuse plan of Zone-M.

One pocket FC-5, Sector-28 is partly built up, the current proposal is based on Total Station Survey forwarded by Engineering Wing, DDA.

Pg. 2/5
30.2.104.2011

Based on the report/list of approved Zonal Development Plan of Zone 'M' the facilities are proposed. A tentative matrix has been worked out for these facilities to be proposed in Public & Semi Public Facilities area in various sectors. Accordingly, the Zonal level facilities are proposed in Four (4) pockets in Sector-27 & 28, Rohini.

3.0 PROPOSAL:

In view of the above examination, following is proposed:-

The proposed Layout Plan for the Facilities pockets in Sector-27 (FC-9) and in Sector 28 (FC-3, FC-4 & FC-5) are placed as per details given in area statement (Para 4.0) for consideration and approval by the Screening Committee.

In addition the provision of reservation for inter-section design as considered in the FC-4, Sector-28, Rohini land reserved for grade separator, shall be followed for all the schemes by Architecture Deptt. (Housing & Commercial Scheme) and Landscape Unit for respective schemes based on Landuse Plan of Zone-M.

4.0 AREA STATEMENT:

i. SECTOR-27

FACILITY POCKET-9

Total area of pocket is 3.514 Ha. The details of Area Statement is as under:-

Plot No.	USE	Area (Ha)
1.	CNG Station(Existing)	0.108
2.	Veterinary Hospital	0.200
3.	Orphanage/Children Centre	0.201
4.	Parking space for parking of buses, LMV's ITPS etc.	0.289
5.	Hospital 'C'	0.734
6.	Vocational Training Centre	0.410
7.	PSP	0.409
8.	Fire Station	1.030
9.	Recreational	0.108
10.	Circulation	0.025

3/5
104/2011

.....4.....

II. FACILITY POCKET-3

Total area of the pocket is 7.374 Ha. The details of area Statement is as under:-

Plot No.	USE	Area (Ha)
1.	ESS 66 KV (Existing)	0.855
2.	Disaster Management Centre	2.595
3.	Nursing Home/Polyclinic	0.187
4.to7.	(4 plots)PSP (1000 sqm each)	0.400
8.	Hospital 'D'	0.300
9.	Family Welfare Centre	0.075
10.	Pediatric Centre	0.075
11.	Geriatric Centre	0.075
12.	Diagnostic Centre	0.075
13.	Maternity Home	0.154
14.	PSP	0.099
15-16	(2 plots) PSP (1000 Sqm each)	0.200
17.	Socio-cultural activities	0.100
18.	District Office and Battalion	1.075
19.	Green	0.199
*	Circulation	0.910

III. FACILITY POCKET -4

Total area of the pocket is 7.155 Ha. The details of area Statement is as under:-

Plot No.	USE	Area (Ha)
1.	Police Station	0.940
2.	General College	2.069
3-4.	(2 plots) PSP (940 sqm each)	0.188
5.	Night Shelter	0.094
6.	Orphanage/Children Centre	0.094
7.	Care Centre for Physically/ Mentally Challenged	0.094
8.	Maternity Home	0.171
9to14	(6 plots) PSP 1100 sqm each)	0.660
15.	Nursing Home/Polyclinic	0.201
16.	Parking	0.192
17.	Petrol Pump	0.119
	Green	0.125
*	Circulation (includes land reserved for grade separator)	2.208

J-4/5
2:104:201

.....5.....

iv **FACILITY POCKET -5**

Total area of the pocket is 1.6874a. The details of Area Statement is as under:-

Plot No.	USE	Area (Ha)
1.	Recreational Club	0.480
2.	Hospital 'C'	1.184
3.	Circulation	0.023

5.0 **FINANCIAL LIABILITY/SOCIAL GAIN**

The proposal is for utilisation of DDA land for Zonal level facilities. As such there will be financial gain once allotted and social fulfilment of requirement of the Community.

6.0 **FOLLOW UP ACTION**

After the approval of the Layout Plans for Public & Semi Public Pockets in Sector-27&28 will be forwarded to Engineering Wing for feasibility/demarcation and Simultaneously to Land Disposal Wing for appropriate action based on feasibility/demarcation by the Engineering Wing. Further the plan will be forwarded to Landscape Unit, DDA for preparation of the Plans wherever applicable.

In addition the Plan of FC-4, Sector-28 will be separately forwarded to Architecture Deptt and Landscape Unit for reservation for inter-section design in respective scheme.

302:104:2011

Vinod Sakle
(Vinod Sakle)
Director(Plg.)/Rohini
Zone M & N/DDA

P.C. Soni
(P.C. Soni)
Dy.Dir.(Plg.)/Rohini
DDA

A.K. Malhotra
(A.K. Malhotra)
Asstt. Dir.(Plg.)/Rohini
DDA

DELHI DEVELOPMENT AUTHORITY
HUPW-CO-ORDINATION UNIT
Approved in.....302.....Screening
Committee Meeting Dt...17-11-11
vide Item no...104:2011
[Signature]
Dy. Director (Arch.) Coord

[Signature]
29/12/11

Approved Minutes of the 302nd screening Committee meeting held on 17.11.11 in Vikas Sadan.

104:2011 Proposed layout plans for Public & Semi Public facilities pocket at Sector-27 (FC-9)& Sector-28(FC-3,FC-4 & FC-5)Rohini Ph.-IV.

File no.- Dir.(Plg.)R/4001/Ph.IV/Pt./2005

Presented by:- Dir.(Plg.)Rohini

Proposal for Consideration: In composite sector plan of Sector-27 & 28,Rohini there are total 11 pockets; three in Sector-27 and eight in Sector-28 proposed for Public and Semi Public facilities. The proposed layout plans for six pockets, one in Sector-27(FC-9) and five in Sector-28 Rohini Ph.-IV were placed before 298th SCM held on 26.04.11 vide item no.25:2011. The item was discussed and it was decided that the proposal be put up again in Screening Committee after due incorporation of the area confirmed through Total Station Survey. The proposed layout plan for the Facilities pockets in Sector-27(FC-9) and in Sector-28(FC-3, FC-4 and FC-5) are placed as per details given in area statement of the agenda.

Decision of Screening Committee: The proposal as reflected in the agenda was approved with condition that

- In the Facility Pocket-9, Sector 27, the width plot no 7(PSP) be increased from 55m 60m and this 5m width be adjusted from Plot no 8(Fire Station).
- In the Facility Pocket-4, Sector 28 instead of six plots of 1100sqm each, four plots of equal size be carved out for better spaces, with change in subsequent plot numbering due to reduction of plots in pocket.
- In the Facility Pocket -5, Sector 28 it was decided that the Recreational Club site be put for Auction to gauge market response.

Follow up Action: The approved proposal for the Layout plan of the Public & Semi Public Pockets in Sector 27 & 28 will be forwarded to the Engineering Wing for feasibility/demarcation and simultaneously to the Land Disposal Wing for appropriate action based on feasibility/demarcation by the Engineering Wing. Further, the plan will be forwarded to the Landscape Unit, DDA for preparation of the plans wherever applicable. In Addition, the plan of FC-4, Sector 28 will be separately forwarded to Architecture Deptt. and Landscape Unit for reservation for inter-section design in respective schemes.

DELHI DEVELOPMENT AUTHORITY
HUPW-CO-ORDINATION UNIT
Approved in...302.....Screening
Committee Meeting Dt.17-11-11
vide Item no...104:2011
[Signature]
29/11/11
Dy. Director (Arch.) Coord

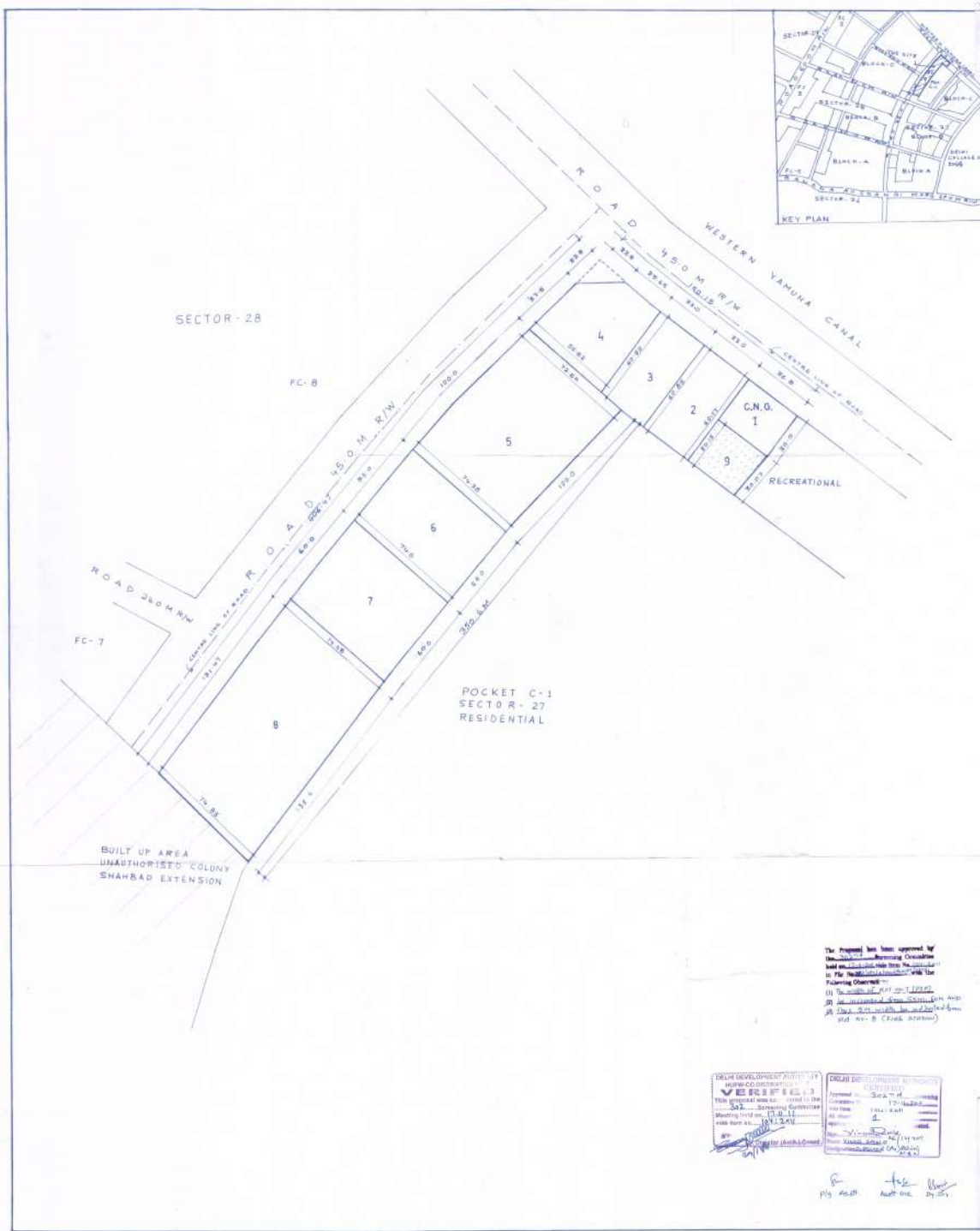

DELHI DEVELOPMENT AUTHORITY
 ROHINI PHASE IV
 ADDRESS

AREA STATEMENT

TOTAL AREA OF POCKET C-1
AH 370

AREA UNDER	
Plot No.	Use
1	C.N.O. STATION - (EXISTING) 0.00
2	VETERINARY HOSPITAL 0.00
3	ORPHANAGE/CHILDREN'S CENTRE 0.00
4	PARKING SPACE FOR TAXIS, BUSES, LMV'S, ITPS ETC. 0.00
5	HOSPITAL 'C' 0.00
6	VOCATIONAL TRAINING CENTRE 0.00
7	P.S.P. 0.00
8	FIRE STATION 0.00
9	RECREATIONAL 0.00
	CIRCULATION 0.00

NOTES

- PLOT NO-9 RECREATIONAL TO BE MERGED IN THE ADJOINING RECREATIONAL (Zonal level)
- THIS DRAWING IS PREPARED ON THE BASES OF TOTAL STATION SURVEY RECEIVED FROM ENGG. M. WIDE LETTER NO F-10(B)/RPD/DDA/669 DATED 20.5.2011.

THE PROPOSAL HAS BEEN CONSIDERED AND APPROVED BY 302ND SCREENING COMMITTEE MEETING HELD ON 17-10-2011. THE ITEM NO. 1011 IS WITH THE CONDITION THAT - IN THE FUTURE PLOT NO. 9, SECTOR 27, THE WIDTH OF PLOT NO. 9 (7.47 M) BE INCREASED FROM 55 M TO 80 M AND THE AREA ADJACENT TO PLOT NO. 9 (FIRE STATION) THE SAME HAS BEEN INCORPORATED IN THE DRAWING.

The proposal has been approved by the Delhi Development Authority and the same has been sanctioned in the Municipal Corporation for the following observations:-
 (1) The width of plot no. 9 is 7.47 m.
 (2) The area adjacent to plot no. 9 (fire station) and no. 8 (Crack station).

FILE NO. DIR/PLG/R/4001/PH IV/PT/2005

PROPOSED LAYOUT PLAN FOR PUBLIC & SEMI PUBLIC POCKET (FC-9) AT SECTOR 27 ROHINI PH IV

SCALE = 1 : 1000	DATE = OCT - 2011
PLG DIR / PUBL ASSTY (1)	JEK DIR / PLG
ASSTY DIR (PLG)	DIRECTOR (PLG)



ROHINI
 PROJECT OFFICE NEW DELHI 110085
 DDA NO.

DELHI DEVELOPMENT AUTHORITY
 HEAD OFFICE
VERIFIED BY 1.3
 This proposal was checked by the
 Director, Planning & Development
 Planning Division, DDA, New Delhi
 on 18.10.2011

DELHI DEVELOPMENT AUTHORITY
 REGIONAL OFFICE
CHECKED BY
 Director, Planning & Development
 Planning Division, DDA, New Delhi
 on 18.10.2011

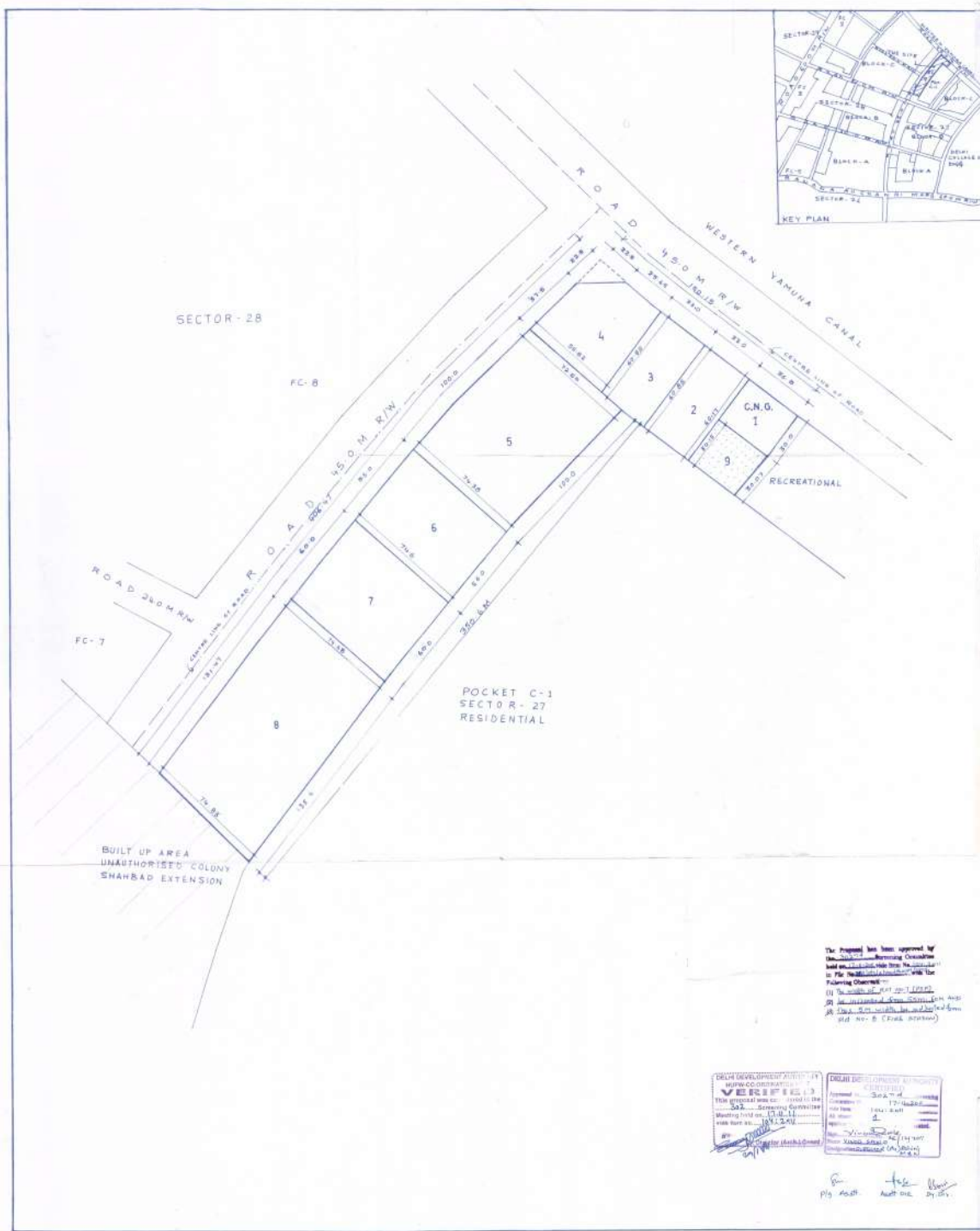

DELHI DEVELOPMENT AUTHORITY
ROHINI PROJECT PLANNING & DESIGN

AREA STATEMENT

TOTAL AREA OF POCKET 3.514 HA

AREA UNDER		
Plot No.	Use	Area(Ha)
1	CNG STATION (EXISTING)	0.106
2	VETERINARY HOSPITAL	0.200
3	ORPHANAGE/CHILDREN CENTRE	0.201
4	PARKING SPACE FOR PARKING OF BUSES, LMV'S, TIPS ETC.	0.289
5	HOSPITAL 'C'	0.734
6	VOCATIONAL TRAINING CENTRE	0.410
7	P.S.P	0.447
8	FIRE STATION	0.992
9	RECREATIONAL CIRCULATION	0.108

NOTES

- PLOT NO-9 RECREATIONAL TO BE MERGED IN THE ADDING RECREATIONAL (Zonal level)
- THIS DRAWING IS PREPARED ON THE BASES OF TOTAL STATION SURVEY RECEIVED FROM ENGG WING VIDE LETTER NO.F-10(B)/R/PD-1/DDA/669 DATED 20-5-2011.

THE PROPOSAL HAS BEEN CONSIDERED AND APPROVED BY 302ND SCREENING COMMITTEE MEETING HELD ON 13-8-2011 WIRE ITEM NO. 104-2011 WITH THE CONDITION THAT:-
IN THE FACILITY PROJECT IN SECTOR-27 THE WIDTH OF FOOTPATH (1.87M) BE INCREASED FROM 85M 50M AND THIS 8M WIDTH BE ADJUSTED FROM PLOT NO-8 (FIRE STATION) AND HAVE BEEN INCORPORATED IN THE DRAWING.

The Proposal has been approved by the Planning Commission, Government of Delhi, vide its meeting held on 13-8-2011 under the Chairmanship of the Hon. Minister for Urban Planning & Development.

Planning Commission:-
(1) The width of the road to be 12.00m.
(2) The width of the road to be 12.00m.
(3) The width of the road to be 12.00m.
(4) The width of the road to be 12.00m.

FILE NO. DIR/PLG/R/4001/PH IV/PT/2005

PROPOSED LAYOUT PLAN FOR PUBLIC & SEMI PUBLIC POCKET (FC-9) AT SECTOR 27 ROHINI PH IV

SCALE = 1:1000	DATE = OCT-2011
PLG DIR (PLG)	JEDR DIR (PLG)
ASST. DIR (PLG)	DIRECTOR (PLG)

ROHINI PROJECT OFFICE NEW DELHI 110085

FC-9/27/PH-IV

DELHI DEVELOPMENT AUTHORITY VERIFIED BY: [Signature] DATE: [Date]	DELHI DEVELOPMENT AUTHORITY CHECKED BY: [Signature] DATE: [Date]
---	--

For: [Signature] PLS. ASST.
For: [Signature] ASST. DIR.



DELHI DEVELOPMENT AUTHORITY
ROHINI PROJECT PLANNING & DESIGN

AREA STATEMENT

TOTAL AREA OF POCKET 7:374 HA
AREA UNDER

PLOT No.	Use	Area(Ha.)
1	ESS 66KV (EXISTING)	0.855
2	DISASTER MANAGEMENT CENTRE	2.595
3	NURSING HOME/POLYCLINIC	0.187
4-7	(4 PLOTS) P.S.P (1000 SQ.M EACH)	0.400
8	HOSPITAL 'D'	0.300
9	FAMILY WELFARE CENTRE	0.075
10	PEDIATRIC CENTRE	0.075
11	GERIATRIC CENTRE	0.075
12	DIAGNOSTIC CENTRE	0.075
13	MATERNITY HOME	0.154
14	P.S.P	0.095
15-16	(2 PLOTS) P.S.P (4000 SQ.M EACH)	0.200
17	SOCIO CULTURAL ACTIVITIES	0.100
18	DISTRICT OFFICE AND BATTALION	1.075
19	GREEN CIRCULATION	0.980

NOTES-

- SERVICES ARE TO BE PROVIDED IN GREEN
- THIS DRAWING IS PREPARED ON THE BASIS OF TOTAL SURVEY RECEIVED FROM ENGS WING WIDE LETTER NO F109/R/PD/004/669 DATED 25.9.2011.

THE PROPOSAL HAS BEEN CONSIDERED AND APPROVED BY 302ND SCREENING COMMITTEE MEETING HELD ON 17.11.2011. VIDE ITEM NO. 104/2011.

DELHI DEVELOPMENT AUTHORITY
MUNICIPAL CORPORATION (M.C.)
VERIFIED
This project was approved by the
302ND Screening Committee
Meeting held on 17.11.2011
vide item no. 104/2011
Date: 17.11.2011
Signature: _____
Director (M.C.)

DELHI DEVT. AUTHORITY
MUNICIPAL CORPORATION (M.C.)
Approved by: _____
Date: 17.11.2011
Signature: _____
Director (M.C.)
The proposal has been approved by
the 302ND Screening Committee
Meeting held on 17.11.2011
vide item no. 104/2011
Date: 17.11.2011
Signature: _____
Director (M.C.)

FILE NO - DR / PLS / R / 6001 / PH-IV / PT / 2005

PROPOSED LAYOUT PLAN FOR PUBLIC & SEMI PUBLIC POCKET (FC-3) AT SECTOR - 28 ROHINI PH. IV

SCALE	1:1000	DATE	NOV. 2011
PLS. DIR. PLS. ASST.	_____	DIR. GEN. PLS.	_____
ASST. DIR. PLS.	_____	DIRECTOR PLS.	_____

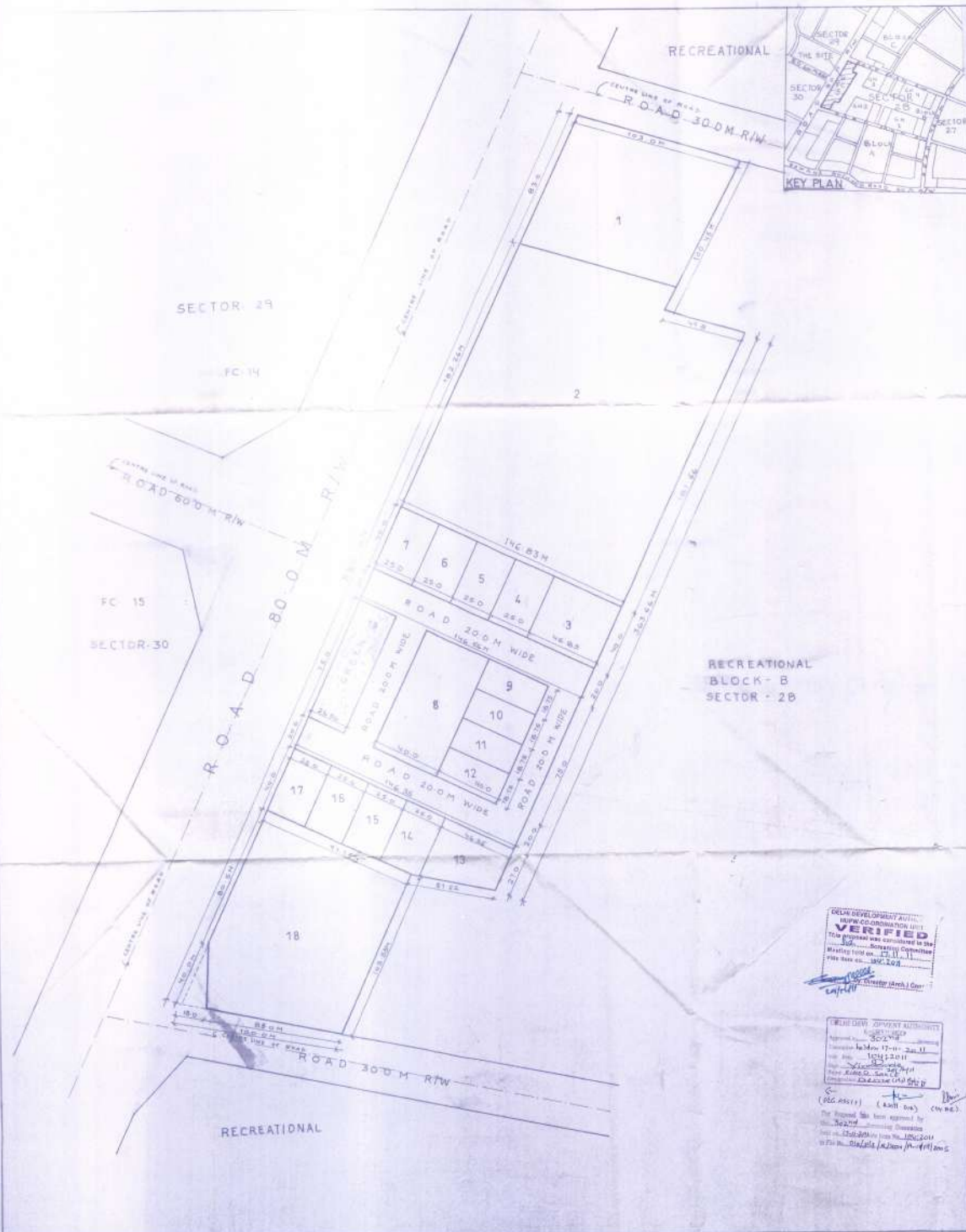



AREA STATEMENT

TOTAL AREA OF POCKET 7.155 HA

AREA UNDER		
Plot No	Use	Area (Ha)
1	POLICE STATION	0.34.0
2	GENERAL COLLEGE	2.05.9
3-4	(2 PLOTS) P S P 940 Sqm each	0.18.8
5	NIGHT SHELTER	0.09.4
6	ORPHANAGE/CHILDREN CENTRE	0.09.4
7	CARE CENTRE FOR PHYSICALLY/MENTALLY CHALLENGED	0.09.4
8	MATERNITY HOME	0.17.1
9-12	(4 PLOTS) P S P 1650 Sqm each	0.66.0
13	NURSING HOME / POLYCLINIC	0.20.1
14	PARKING	0.19.2
15	PETROL PUMP	0.11.9
	GREEN	0.12.5
	CIRCULATION (includes land reserved for grade separator)	2.20.8

- NOTES
- SERVICES ARE TO BE PROVIDED IN GREEN
 - THIS DRAWING IS PREPARED ON THE BASIS OF TOTAL STATION SURVEY RECEIVED FROM ENGG WING VIDE LETTER NO. F-1081/RP-D/DOA/669 DATED 20-5-2011

THE PROPOSAL HAS BEEN CONSIDERED AND APPROVED BY 302ND SCREENING COMMITTEE MEETING HELD ON 17-10-2011 VIDE ITEM NO. 104/2011 WITH THE CONDITION THAT -
 1. IN THE FACILITY POCKET 'A' SECTOR 28, 10 METERS BE 100 PLOTS OF BETTER SPACES WITH CHANGE IN SUBSEQUENT PLOT NUMBERS DUE TO RESUBDIVISION OF PLOTS IN POCKET 'A'.
 THE SAME HAS BEEN INCORPORATED IN THE DRAWING

DIR (PLG/R/1/001/PH/IV/PE/ 2005)

PROPOSED LAYOUT PLAN FOR PUBLIC & SEMI PUBLIC POCKET (FC-4) AT SECTOR 28, ROHINI, PH- IV

SCALE 1:1000 DATE 17TH OCT 2011

PLG/M PUG ASSTT JY DY DIR (PLG)

ASSTT DIR (PUG) DIRECTOR (PUG)

ROHINI

PROJECT OFFICE NEW DELHI 110086

FC 4/28/ PH IV

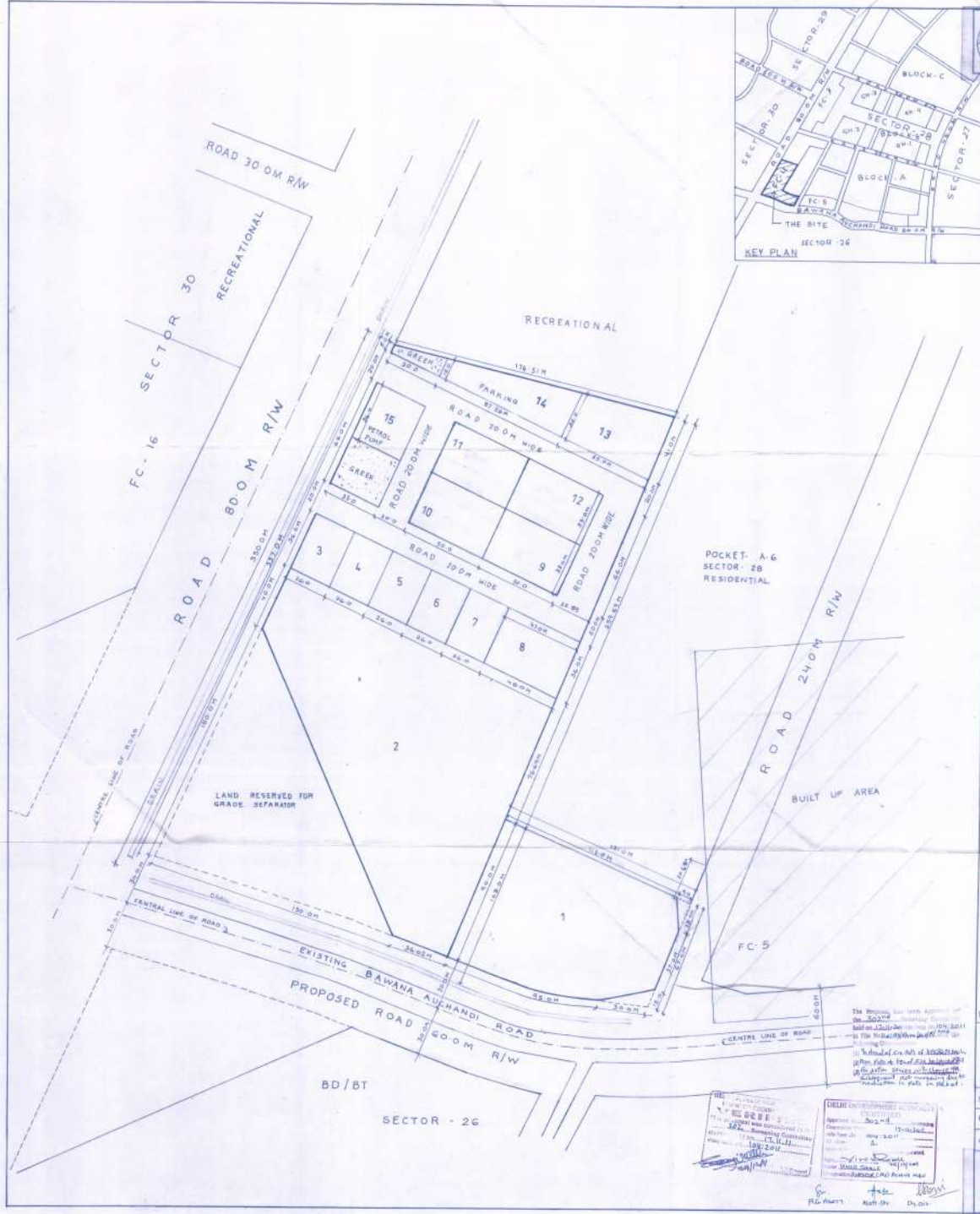

APPROVED BY THE DIRECTOR (PUG) ON 17-10-2011

APPROVED BY THE CHIEF ENGINEER (PUG) ON 17-10-2011

APPROVED BY THE CHIEF ARCHITECT (PUG) ON 17-10-2011

APPROVED BY THE CHIEF SURVEYOR (PUG) ON 17-10-2011

APPROVED BY THE CHIEF ESTIMATOR (PUG) ON 17-10-2011

APPROVED BY THE CHIEF CONTRACTOR (PUG) ON 17-10-2011



DELHI DEVELOPMENT AUTHORITY
ROHINI PROJECT PLANNING & DESIGN

AREA STATEMENT

TOTAL AREA OF POCKET 1-687 HA
AREA UNDER

PLOT No.	Use	Area(Ha)
1	RECREATIONAL CLUB	0.480
2	HOSPITAL 'C'	1-184
	CIRCULATION	0.023

NOTES:-

• THIS DRAWING IS PREPARED ON THE BASIS OF TOTAL STATION SURVEY RECEIVED FROM ENGG WING VIDE LETTER NO F-10(8)/RPO1/ODA/669 DATED 20-5-2011

THE PROPOSAL HAS BEEN CONSIDERED AND APPROVED BY SOPT PREPARING COMMITTEE MEETING HELD ON 08-08-2011 VIDE ITEM NO 104/2011 WITH THE CONDITION THAT:-
1. IN THE FACILITY POCKET-5, SECTOR 28, IT WAS DECIDED THAT THE RECREATIONAL CLUB SITE BE PUT UP FOR ANTON YO GAUGE MARKET RESPONSE.
THE ABOVE CONDITION HAS BEEN REFLECTED IN THE DRAWING FOR FOLLOW-UP ACTION BY LAND DISPOSAL WING DDA.



On Proposed layout approved for
1. Section 28, 28
2. Section 28, 28
3. Section 28, 28
4. Section 28, 28
5. Section 28, 28
6. Section 28, 28
7. Section 28, 28
8. Section 28, 28
9. Section 28, 28
10. Section 28, 28

FILE NO - DIR/PLG/R/4001/PH-IV/PT/2005

PROPOSED LAYOUT PLAN FOR PUBLIC & SEMI PUBLIC POCKET [FC-5] AT SECTOR 28 ROHINI PH IV

SCALE	1:1000	DATE	JUNE-2011	N ↑ NORTH
PLS DIR/PLG/ASSTT.		JR. DIR. DIR (PLG)		
ASSTT. DIR (PLG)		DIRECTOR (PLG)		

DELHI DEVELOPMENT AUTHORITY
ROHINI PROJECT PLANNING & DESIGN
1002, Sector 28, Rohini, New Delhi-110085
10/05/2011

APPROVED BY
DIRECTOR (PLG)
10/05/2011

plg asstt. dir. asstt. dir. asstt. dir.

ROHINI PROJECT OFFICE NEW DELHI 110085
FC-5/28/ PH-IV
DRA NO.