

HSTC

Item No. 61:2011

Screening Committee No. 300th

**Title of the Agenda: Modification in Layout Plan of Sector -34 & 35, PhV Rohini- Regarding shifting of location of Sewage Pumping Station (SPS)
(File No. Dir./Plg./R/5001/Ph.V/2005)**

Synopsis

There is a request from Executive Engineer, RPD-2 for shifting of location of SPS in Sector-35 Rohini. The proposal of modification in the Layout Plan for shifting of SPS in Sector-35 Rohini, is placed before the Screening Committee for its consideration.

1.0 BACKGROUND:

The Layout Plan of Sector-34 and 35 Ph.V, Rohini was approved in 247th Screening Committee meeting held on 31.03.06 vide item No. 39:2006. Subsequently, the SPS site was approved in 250th Screening Committee meeting held on 28.08.06 vide item No. 91:2006. Further in the approved Sector Layout Plan, the dimension and area as per Total Station Survey conducted by Engineering Wing, has been incorporated and the said drawing is issued to Engineering, Landscape and Architecture Department by Rohini Planning Office on 06.07.11.

2.0 EXAMINATION:

In the Layout Plan of Sector- 34 & 35 Rohini, there is a provision of proposed SPS site measuring 60mx65m in the green area of Sector- 35. The SPS site in Sector- 35 marked by Engineering Wing is as SPS-2, in over all Services Plan of Sector-26 to Sector-38 Rohini. The SPS-1 & SPS-3 are located in Sector -26 & 38 Rohini respectively as per this Plan. For shifting of SPS location, a meeting was held in the Chamber of Chief Engineer (Rohini) on 23.06.11 wherein Planning, Landscape, Land Management and Engineering representatives were present. It was pointed out that shifting of earlier site earmarked for Sewage Pumping Station to a suitable location free from all hindrances since earlier approved site is surrounded by existing unauthorized colonies and is not feasible to lay Sewer line and rising main. Further the earlier approved site land has not been handed over to DDA. Accordingly after deliberations, it was decided to shift the location of Sewage Pumping Station in the green area of Sector-35 Rohini touching the boundary of Group Housing Pocket-B2 and 30mtr. R/W road which is near to 60mtr. R/W road. The Landuse of Green area as per MPD-2021 & ZDP of Zone-'M' is 'Recreational'. As per MPD-2021 'Public Utilities' are permitted in all Use Zones. The over all Green Area Plan for the Sector-34 & 35 Rohini, exercise is being separately taken up by Landscape Unit, DDA. However, since it is a modification in Layout Plan of Sector-34 & 35, the proposal is being processed by Planning Department and after the approval by Screening Committee, it will be suitably incorporated by the Landscape Unit in the over all Landscape Plan of Green area. As earlier location of SPS site is not feasible once the shifted location is approved, the earlier approved site will be deleted and the area will remain as Green.

g. 1/2

3.0 PROPOSAL:

The shifted location of Sewage Pumping Station measuring 60x65m is proposed on 30mtr. road near Pocket-B2, Sector-35 Rohini. The same is shown on the print of Layout Plan of Sector -34 & 35 Ph.V, Rohini. After the approval of shifted location of SPS, the earlier site of SPS will be deleted and area will remain as Green as per over all approved Layout Plan of Sector-34 & 35, Rohini.

4.0 AREA STATEMENT:

There is no change in the Area Statement earlier approved including SPS location by 247th Screening Committee meeting held on 31.03.06 and 250th Screening Committee meeting held on 28.08.06.

5.0 FINANCIAL LIABILITY/SOCIAL GAIN:

There is no financial implication from the Planning point of view as the proposal is for utilization of DDA land for services of the Sector-34 & 35, Rohini.

6.0 FOLLOW UP ACTION

After the approval, the modified Layout Plan will be sent to Engineering Wing for development and demarcation and Landscape Unit for incorporation in the over all Landscape Plan of Green area of Sector-34 & 35, Rohini. The copy of the Plan will also be forwarded to L.M. Department, Rohini for information and record.

pg. 2/2
300161:2011

Vinod Sakle
(Vinod Sakle) 15/07/11
Director(Plg.)Rohini
(Zone- M&N)

P.C. Soni
(P.C. Soni)
Dy.Dir.(Plg.)-II Rohini

A.K. Malhotra
(A.K. Malhotra)
Asstt.Dir.(Plg.)Rohini

DELHI DEVELOPMENT AUTHORITY
 HUPW-CO-ORDINATION UNIT
 Approved in.....300.....Screening
 Committee Meeting Dt. 08-08-2011
 vide Item no.....61:2011.....
 Dt. Director (Arch.) Dept

A.K. Malhotra
23/07/11

Minutes of the 300th Screening Committee Meeting held on 08.08.2011 at 4.00pm in Vikas Sadan.

61:2011 Modification in layout plan of sector-34 & 35, Ph.-V Rohini-regarding shifting of location of Sewage Pumping Station.(SPS).

File no.-Dir.(Plg.)R/5001/Ph.V/2005

Presented by:- Dir.(Plg.)Rohini

Proposal for consideration : There is a request from Executive Engineer, RPD-2 for shifting of location of SPS in Sector-35 Rohini. The proposal is of modification in the layout plan for shifting of Sewage Pumping Station measuring 60 x 65 m. is proposed in the Green Area of Sector -35 Rohini touching the boundary of Group Housing Pocket-B2 and 30m.R/W which is near to 60m R.W road. The earlier approved site has not been handed over to DDA and is surrounded by existing unauthorized colonies and is not feasible to lay the sewer line and rising main. After the approval of the new location of SPS, the earlier site of SPS will be deleted from the plan and area will be remain as Green as per overall approved layout plan of Sector-34&35, Rohini. There is no change in the Area Statement from the earlier approved including SPS location by 247th Screening Committee meeting held on 31.03.06 and 250th Screening Committee Meeting held on 28.08.06.

Decision of Screening Committee: The proposal as reflected in the agenda was approved.

Follow up Action: The approved modified layout plan will be sent to the Engineering Wing for development and demarcation and to the Landscape Unit for incorporation in the overall landscape plan of green Area of Sector34& 35, Rohini. The copy of the plan will also be forwarded to the Land Management Wing, Rohini for information and record.

DELHI DEVELOPMENT AUTHORITY
 HUPW-CO-ORDINATION UNIT
 Approved in.....300.....Screening
 Committee Meeting Dt. 08-08-2011
 vide Item no.....61:2011.....
 Dy. Director / Archt. Coord.

[Handwritten signature]
23/08/11

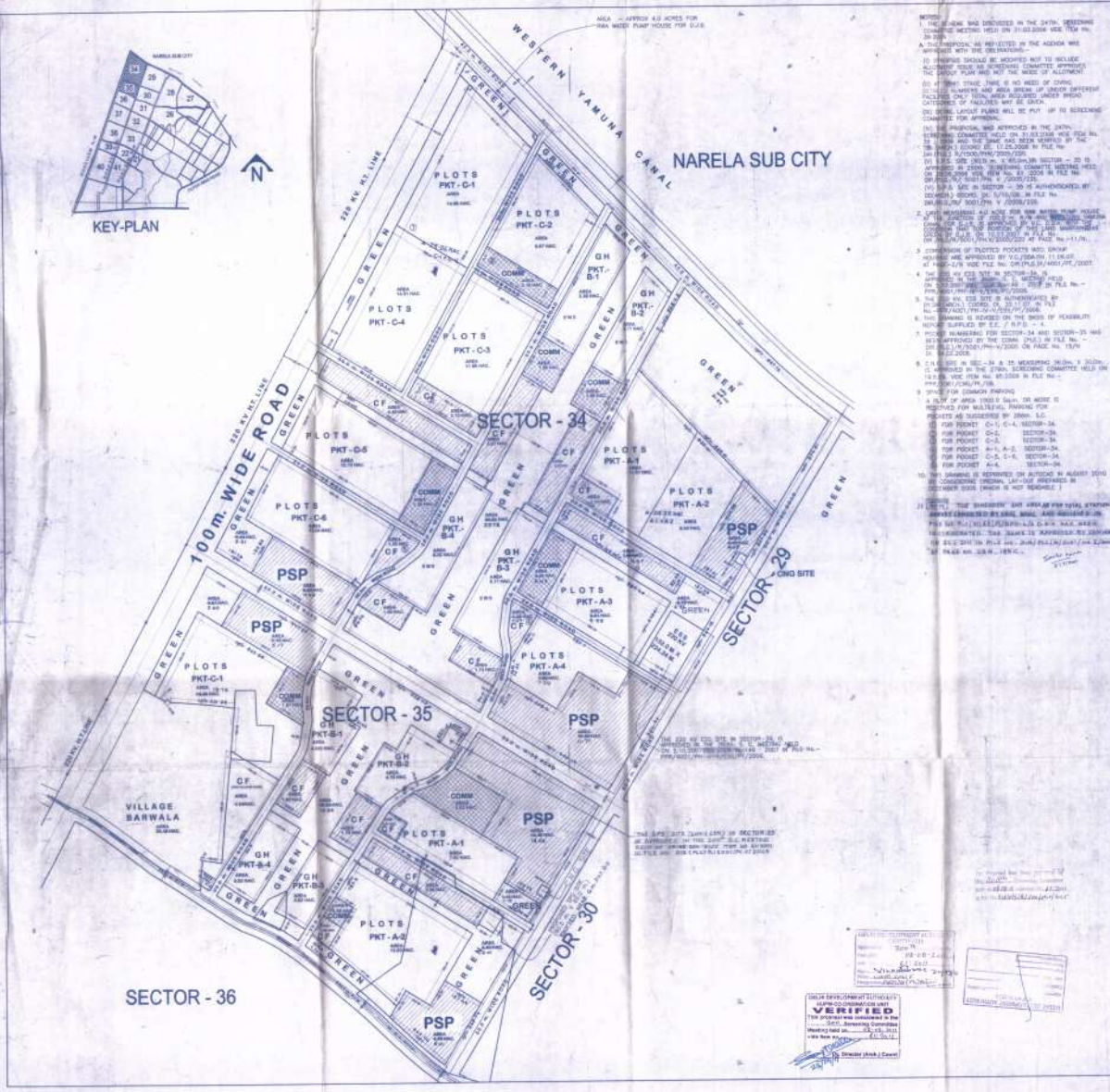

NOTES

1. THE PLAN WAS PREPARED IN THE DATE, SPECIFIED UNDER THE PROJECT NO. IN THE TITLE BLOCK.
2. THE PROJECT NO. IS AS SHOWN IN THE TITLE BLOCK.
3. THE PROJECT NO. IS AS SHOWN IN THE TITLE BLOCK.
4. THE PROJECT NO. IS AS SHOWN IN THE TITLE BLOCK.
5. THE PROJECT NO. IS AS SHOWN IN THE TITLE BLOCK.
6. THE PROJECT NO. IS AS SHOWN IN THE TITLE BLOCK.
7. THE PROJECT NO. IS AS SHOWN IN THE TITLE BLOCK.
8. THE PROJECT NO. IS AS SHOWN IN THE TITLE BLOCK.
9. THE PROJECT NO. IS AS SHOWN IN THE TITLE BLOCK.
10. THE PROJECT NO. IS AS SHOWN IN THE TITLE BLOCK.
11. THE PROJECT NO. IS AS SHOWN IN THE TITLE BLOCK.
12. THE PROJECT NO. IS AS SHOWN IN THE TITLE BLOCK.
13. THE PROJECT NO. IS AS SHOWN IN THE TITLE BLOCK.
14. THE PROJECT NO. IS AS SHOWN IN THE TITLE BLOCK.
15. THE PROJECT NO. IS AS SHOWN IN THE TITLE BLOCK.
16. THE PROJECT NO. IS AS SHOWN IN THE TITLE BLOCK.
17. THE PROJECT NO. IS AS SHOWN IN THE TITLE BLOCK.
18. THE PROJECT NO. IS AS SHOWN IN THE TITLE BLOCK.
19. THE PROJECT NO. IS AS SHOWN IN THE TITLE BLOCK.
20. THE PROJECT NO. IS AS SHOWN IN THE TITLE BLOCK.
21. THE PROJECT NO. IS AS SHOWN IN THE TITLE BLOCK.
22. THE PROJECT NO. IS AS SHOWN IN THE TITLE BLOCK.
23. THE PROJECT NO. IS AS SHOWN IN THE TITLE BLOCK.
24. THE PROJECT NO. IS AS SHOWN IN THE TITLE BLOCK.
25. THE PROJECT NO. IS AS SHOWN IN THE TITLE BLOCK.
26. THE PROJECT NO. IS AS SHOWN IN THE TITLE BLOCK.
27. THE PROJECT NO. IS AS SHOWN IN THE TITLE BLOCK.
28. THE PROJECT NO. IS AS SHOWN IN THE TITLE BLOCK.
29. THE PROJECT NO. IS AS SHOWN IN THE TITLE BLOCK.
30. THE PROJECT NO. IS AS SHOWN IN THE TITLE BLOCK.
31. THE PROJECT NO. IS AS SHOWN IN THE TITLE BLOCK.
32. THE PROJECT NO. IS AS SHOWN IN THE TITLE BLOCK.
33. THE PROJECT NO. IS AS SHOWN IN THE TITLE BLOCK.
34. THE PROJECT NO. IS AS SHOWN IN THE TITLE BLOCK.
35. THE PROJECT NO. IS AS SHOWN IN THE TITLE BLOCK.
36. THE PROJECT NO. IS AS SHOWN IN THE TITLE BLOCK.
37. THE PROJECT NO. IS AS SHOWN IN THE TITLE BLOCK.
38. THE PROJECT NO. IS AS SHOWN IN THE TITLE BLOCK.
39. THE PROJECT NO. IS AS SHOWN IN THE TITLE BLOCK.
40. THE PROJECT NO. IS AS SHOWN IN THE TITLE BLOCK.
41. THE PROJECT NO. IS AS SHOWN IN THE TITLE BLOCK.
42. THE PROJECT NO. IS AS SHOWN IN THE TITLE BLOCK.
43. THE PROJECT NO. IS AS SHOWN IN THE TITLE BLOCK.
44. THE PROJECT NO. IS AS SHOWN IN THE TITLE BLOCK.
45. THE PROJECT NO. IS AS SHOWN IN THE TITLE BLOCK.
46. THE PROJECT NO. IS AS SHOWN IN THE TITLE BLOCK.
47. THE PROJECT NO. IS AS SHOWN IN THE TITLE BLOCK.
48. THE PROJECT NO. IS AS SHOWN IN THE TITLE BLOCK.
49. THE PROJECT NO. IS AS SHOWN IN THE TITLE BLOCK.
50. THE PROJECT NO. IS AS SHOWN IN THE TITLE BLOCK.

DELHI DEVELOPMENT AUTHORITY
ROHINI PROJECT PLANNING AND DESIGN

LANDUSE AREA STATEMENT OF SECTOR - 34

A. TOTAL AREA OF SECTOR 34: 218.40 HEC

B. LANDUSE BREAKUP OF AREA UNDER SECTOR - 34

LANDUSE	AREA (HA)	PERCENTAGE
RESIDENTIAL (GROUP)	158.20	72.43
COMMERCIAL	1.00	0.46
PUBLIC (SCHOOL)	1.00	0.46
RESIDENTIAL (INDIVIDUAL)	48.20	22.05
RECREATIONAL	1.00	0.46
TOTAL	218.40	100

C. LINEUP BREAKUP OF GROSS RESIDENTIAL AREA

LANDUSE	AREA (HA)	PERCENTAGE
RESIDENTIAL (GROUP)	158.20	72.43
RESIDENTIAL (INDIVIDUAL)	48.20	22.05
TOTAL	206.40	94.48

D. DISTRIBUTION OF NET RESIDENTIAL AREA

GROUP	NO. OF PLOTS	AREA (HA)	PERCENTAGE	POPULATION
1. GROUP HOUSING	23.00	100.00	11.00	10750
2. INDIVIDUAL HOUSING	115.00	227.00	8.00	15100
TOTAL	138.00	327.00	19.00	25850

E. TOTAL NO. OF PROPOSED DWG IN SECTOR 34: 71250

F. TOTAL NO. OF PROPOSED PLOTS: 138000

G. TOTAL NO. OF PROPOSED PLOTS: 138000

H. TOTAL PROPOSED POPULATION FOR SECTOR 34: 258500

LANDUSE AREA STATEMENT OF SECTOR - 35

A. TOTAL AREA OF SECTOR 35: 475.00 HEC

B. LANDUSE BREAKUP OF AREA UNDER SECTOR - 35

LANDUSE	AREA (HA)	PERCENTAGE
RESIDENTIAL (GROUP)	300.00	63.16
COMMERCIAL	1.00	0.21
PUBLIC (SCHOOL)	1.00	0.21
RESIDENTIAL (INDIVIDUAL)	173.00	36.42
RECREATIONAL	1.00	0.21
TOTAL	476.00	100

C. LINEUP BREAKUP OF GROSS RESIDENTIAL AREA

LANDUSE	AREA (HA)	PERCENTAGE
RESIDENTIAL (GROUP)	300.00	63.16
RESIDENTIAL (INDIVIDUAL)	173.00	36.42
TOTAL	473.00	99.37

D. DISTRIBUTION OF NET RESIDENTIAL AREA

GROUP	NO. OF PLOTS	AREA (HA)	PERCENTAGE	POPULATION
1. GROUP HOUSING	14.00	100.00	11.00	10750
2. INDIVIDUAL HOUSING	115.00	227.00	8.00	15100
TOTAL	129.00	327.00	19.00	25850

E. TOTAL NO. OF PROPOSED DWG IN SECTOR 35: 134000

F. TOTAL NO. OF PROPOSED PLOTS: 138000

G. TOTAL NO. OF PROPOSED PLOTS: 138000

H. TOTAL PROPOSED POPULATION FOR SECTOR 35: 258500



LAYOUT PLAN OF SECTOR - 34 AND SECTOR - 35, PHASE V, ROHINI

VERIFIED

DATE: 15/05/2011

BY: [Signature]

FOR: [Signature]