



THE LOCATION OF COMMAND TANK II, SPS-3, 220 KV. E.S.S. 4.66 KV. E.S.S. SITES ARE MARKED ON THE LAY-OUT PLAN, FINALISED IN THE MEETING HELD IN THE CHAMBER OF CHIEF ENGINEER (ROHINI) ON 8th JAN 2013 VIDE LETTER NO. F.300(3) E.E.(P) MISC/CC/4/DDA/52 DATED 9.01.2013 THE SCHEME WAS DISCUSSED IN 312th SCREENING COMMITTEE MEETING HELD ON 11.03.2013 VIDE ITEM NO 43:2013 THE SCREENING COMMITTEE HAS APPROVED AND RECOMMENDED THE PROPOSAL FOR CONSIDERATION OF THE AUTHORITY UNDER SUB-CLAUSE B(2) PERMISSION OF USE PREMISES IN USE ZONES OF M.P.D.2021

THE SAME IS VERIFIED BY DY. DIR. (ARCH.) COORDN. DT. 22.04.13 IN FILE NO. PFR/4001/Service/Ph-15-V/E.S.S./2007

THE SAME HAS BEEN APPROVED IN THE AUTHORITY'S MEETING HELD ON 26.07.13 VIDE ITEM NO. 84/2013.

CHANGE OF LANDUSE FROM "RECREATIONAL TO COMMERCIAL (WHOLESALE/WAREHOUSING) MEASURING 2.80 HAC HAS BEEN NOTIFIED VIDE S.O. NO. 2653 (CE) DATED 26.08.2013 (CSR NO. 6)

NOTES

1. CHANGE OF LANDUSE OF LAND MEASURING 21.0 ACRES FROM RECREATIONAL (DISTRICT PARK) TO TRANSPORTATION (HELIPORT) IN SECTOR 36 IS APPROVED IN THE TECHNICAL COMMITTEE'S MEETING HELD ON 7.08.2006 VIDE ITEM NO. 112/2006.

2. THE ABOVE ITEM WAS CONSIDERED IN THE AUTHORITY MEETING HELD ON 12.12.08 VIDE ITEM NO. 67/2008 IN FILE NO. PFR/4001/Service/Ph-15-V/E.S.S./2007. THE POSSESSION OF HELIPORT IS HANDED OVER TO CIVIL AVIATION DEPARTMENT ON 3.7.09 VIDE F.No. F-32(II)/07/11.

MODIFICATION WITH REMAINING ENTRY/EXIT APPROACH ROAD FROM 60.0 M WIDE PARK ROAD THROUGH 45.0 M WIDE GREEN BELT TO HELIPORT IS APPROVED IN 304th SCREENING COMMITTEE MEETING HELD ON 08.06.2012 VIDE ITEM NO. 2214 (L&M) WIDE ROAD WITH 25.4 M WIDE MEDIAN.

CHANGE OF LANDUSE FROM "RECREATIONAL TO TRANSPORTATION (TERMINAL/BUS) MEASURING 4.90 HAC HAS BEEN NOTIFIED VIDE S.O. NO. 2538 (CE) DATED 28.13 (SR. NO. 7)

DELHI DEVELOPMENT AUTHORITY
CERTIFIED
Approved in 339th Screening Committee Meeting held on 24.09.2016
Site Item No. 36/16
Name: M.P.D. B.T. Terminal
Destination: B.T. (B.T.) Rohini, Zone M

BEENAK JOSHI ASSTT. DIR. (P&S) BY DIR. (P&S)
M.A. ASST. ZONE M

DELHI DEVELOPMENT AUTHORITY
HUB & CO-ORDINATION UNIT
VERIFIED
This proposal was considered in the 339th Screening Committee Meeting held on 24.09.2016
Site Item No. 36/16
Dy. Director (Arch.) Co-ordin.

20.0 M WIDE ROAD IN PKT. C-2 SECTOR 37 HAS BEEN APPROVED IN THE 305th SCREENING COMMITTEE MEETING HELD ON 25.05.2012 VIDE ITEM NO. 27:2012 IN FILE NO. DIR (PLG)/R/5037/G/2/2012

NUMBERING OF COMMUNITY FACILITY POCKETS (CF 1 TO CF 10) HAS BEEN APPROVED IN THE 323rd SCREENING COMMITTEE MEETING HELD ON 29.05.2014 VIDE ITEM NO. 53:2014 IN FILE NO. DIR (PLG)/R/5036/CF/2013
THE SAME HAS BEEN AUTHENTICATED AND VERIFIED BY DY. DIR. (ARCH.) COORDIN. DATED 31.07.2014.

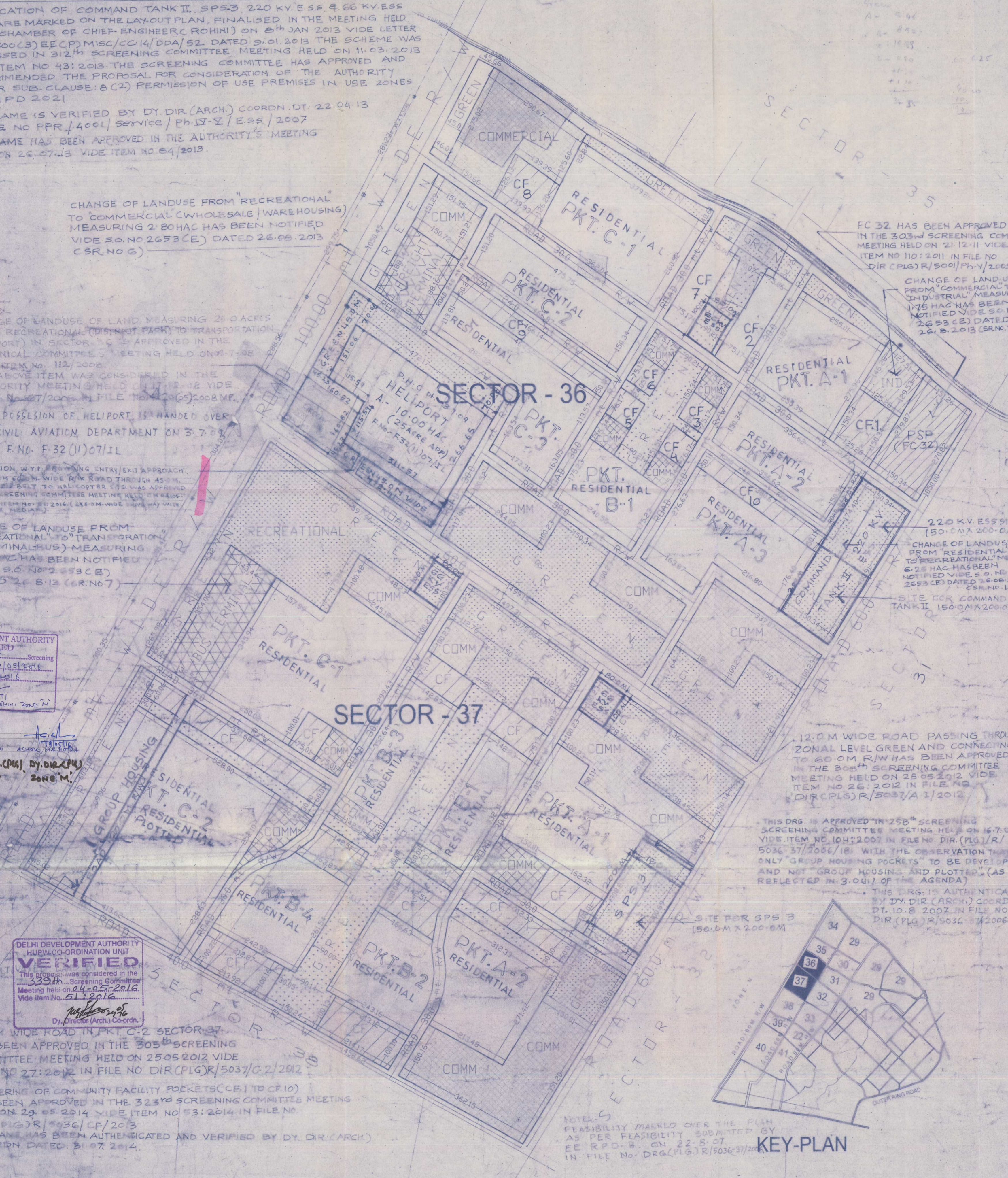

FC 32 HAS BEEN APPROVED IN THE 303rd SCREENING COMMITTEE MEETING HELD ON 21.12.11 VIDE ITEM NO. 110:2011 IN FILE NO. DIR (PLG)/R/5001/Ph-V/2005

CHANGE OF LAND USE FROM COMMERCIAL TO INDUSTRIAL MEASURING 1.75 HAC HAS BEEN NOTIFIED VIDE S.O. NO. 2653 (CE) DATED 26.08.2013 (SR. NO. 9)

220 KV. E.S.S. SITE (50.0 M X 200.0 M)
CHANGE OF LANDUSE FROM RESIDENTIAL TO RECREATIONAL MEASURING 6.25 HAC HAS BEEN NOTIFIED VIDE S.O. NO. 2653 (CE) DATED 26.08.2013 (SR. NO. 10)

SITE FOR COMMAND TANK II (50.0 M X 200.0 M)

12.0 M WIDE ROAD PASSING THROUGH ZONAL LEVEL GREEN AND CONNECTING TO 60.0 M R/W HAS BEEN APPROVED IN THE 305th SCREENING COMMITTEE MEETING HELD ON 25.05.2012 VIDE ITEM NO. 27:2012 IN FILE NO. DIR (PLG)/R/5037/A/1/2012

THIS DRG. IS APPROVED IN 258th SCREENING COMMITTEE MEETING HELD ON 16.7.07 VIDE ITEM NO. 104:2007 IN FILE NO. DIR (PLG)/R/5036/37/2006/161 WITH THE OBSERVATION THAT ONLY "GROUP HOUSING POCKETS" TO BE DEVELOPED AND NOT "GROUP HOUSING AND PLOTTED" (AS REFLECTED IN 3.04(i) OF THE AGENDA)

THIS DRG. IS AUTHENTICATED BY DY. DIR. (ARCH.) COORDN. DT. 10.8.2007 IN FILE NO. DIR (PLG)/R/5036/37/2006

NOTES
FEASIBILITY MARKED OVER THE PLAN AS PER FEASIBILITY SUBMITTED BY EE RPD-9 ON 22.8.07 IN FILE NO. DRG (PLG)/R/5036/37/2006

LANDUSE AREA STATEMENT OF SECTOR - 36

A. TOTAL AREA OF SECTOR 36 180.52 HAC

B. LANDUSE BREAKUP OF AREA UNDER SECTOR - 36

LANDUSE (GROSS)	AREA (HAC)	PERCENTAGE
RESIDENTIAL (GROSS)	86.96	48.17
COMMERCIAL	19.43	10.77
PUBLIC / SEMI-PUBLIC	4.10	2.27
RECREATIONAL	46.66	25.85
INDUSTRIAL	1.72	0.95
F.T. (FREIGHT TERMINAL)	3.27	1.81
CIRCULATION	18.38	10.18
TOTAL	180.52	100

C. LANDUSE BREAKUP OF GROSS RESIDENTIAL AREA

LANDUSE	AREA (HAC)	PERCENTAGE
RESIDENTIAL (NETT)	49.93	57.42
COMMERCIAL	2.85	2.58
COMMUNITY FACILITY	13.68	15.73
RECREATIONAL	5.67	6.52
CIRCULATION	15.43	17.75
TOTAL	86.96	100

D. DISTRIBUTION OF NET RESIDENTIAL AREA

RESIDENTIAL	NET AREA (HAC)	DU's	PERCENTAGE	POPULATION
RESIDENTIAL (RESIDENTIAL AND OTHERS)	49.93	8738	100	41940

E. TOTAL NO. OF PROPOSED DUs IN SECTOR 36 8738

F. TOTAL PROPOSED POPULATION OF SECTOR 36 41940

LANDUSE AREA STATEMENT OF SECTOR - 37

A. TOTAL AREA OF SECTOR 37 190.53 HAC

B. LANDUSE BREAKUP OF AREA UNDER SECTOR - 37

LANDUSE (GROSS)	AREA (HAC)	PERCENTAGE
RESIDENTIAL (GROSS)	113.76	59.71
COMMERCIAL	19.12	10.04
PUBLIC / SEMI-PUBLIC	2.21	1.16
RECREATIONAL	35.42	18.59
CIRCULATION	17.42	9.14
B.T. (BUS Terminal)	4.81	2.53
TOTAL	190.53	100

C. LANDUSE BREAKUP OF GROSS RESIDENTIAL AREA

LANDUSE	AREA (HAC)	PERCENTAGE
RESIDENTIAL (NETT)	70.49	61.96
COMMERCIAL	5.30	4.66
COMMUNITY FACILITY	16.82	14.79
RECREATIONAL	12.67	11.14
CIRCULATION	8.48	7.45
TOTAL	113.76	100

D. DISTRIBUTION OF NET RESIDENTIAL AREA

RESIDENTIAL	NET AREA (HAC)	DU's	PERCENTAGE	POPULATION
RESIDENTIAL (RESIDENTIAL AND OTHERS)	70.49	12500	100	52690

E. TOTAL NO. OF PROPOSED DUs IN SECTOR 37 12500

G. TOTAL PROPOSED POPULATION OF SECTOR 37 52690

LEGEND



PROPOSED LAYOUT
PLAN OF SECTOR - 36
& 37 PHASE V, ROHINI

DATE: DEC. 19, 2006 SCALE: 1:5000
PLG. ASST. RASTOGI
ASST. DIR.
JT. DIR. (PLG)
DIRECTOR (PLG)