

THE SCHEME WAS DISCUSSED IN THE 251<sup>th</sup> SCREENING COMMITTEE MEETING HELD ON 13.10.2006 VIDE ITEM NO. 120:2006. THE PROPOSAL AS REFLECTED IN THE AGENDA WAS APPROVED.

THIS SCHEME WAS CERTIFIED BY DIRECTOR (PLG) DWK. AND VARIFIED BY DY. DIRECTOR (ARCH) COORDN.

Sd /  
 17.11.06  
 DIR. (PLG) DWK.

Sd /  
 29.11.06  
 DY. DIR. (ARCH) COORDN.

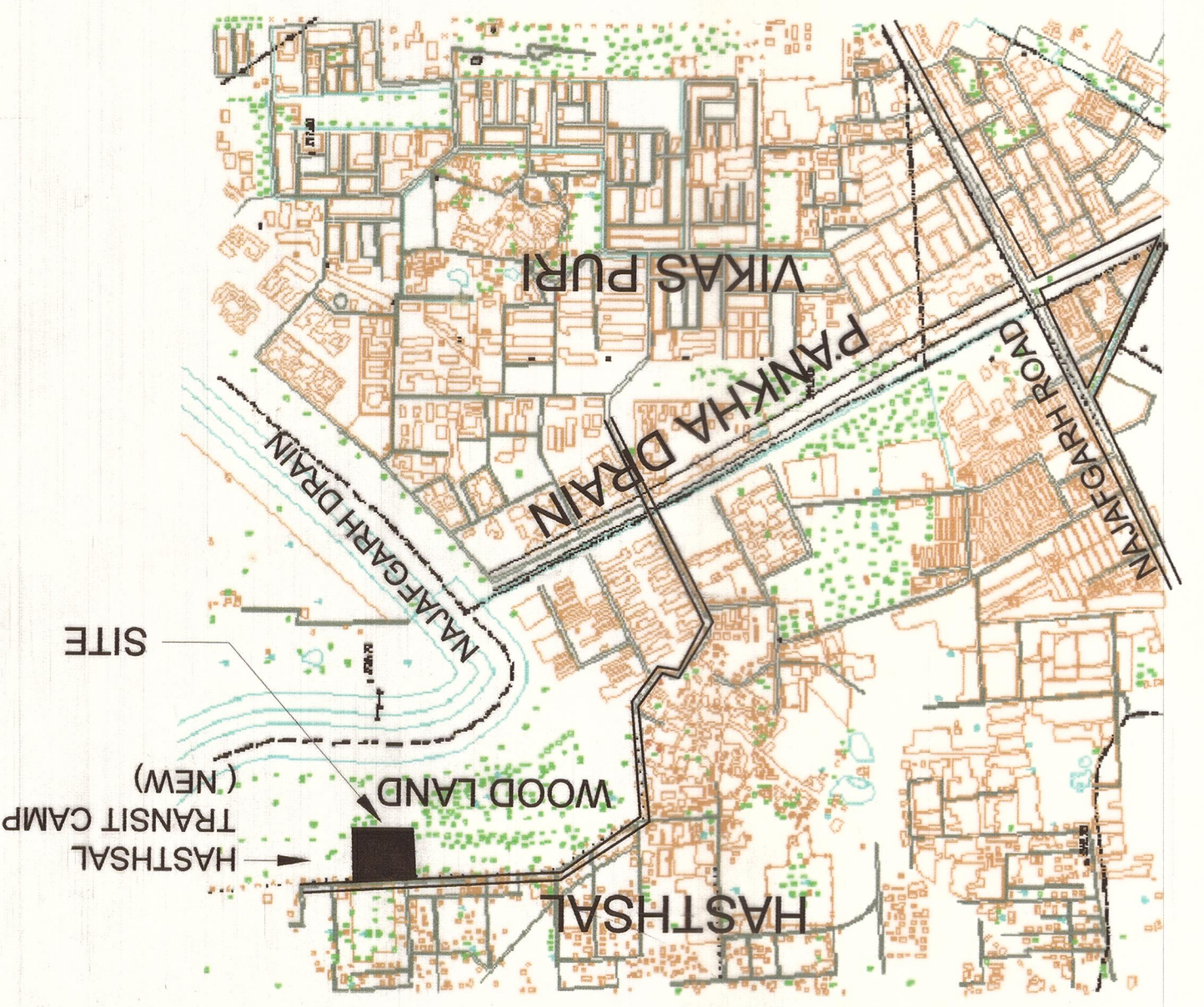

LOCATION PLAN  
 NOT TO SCALE

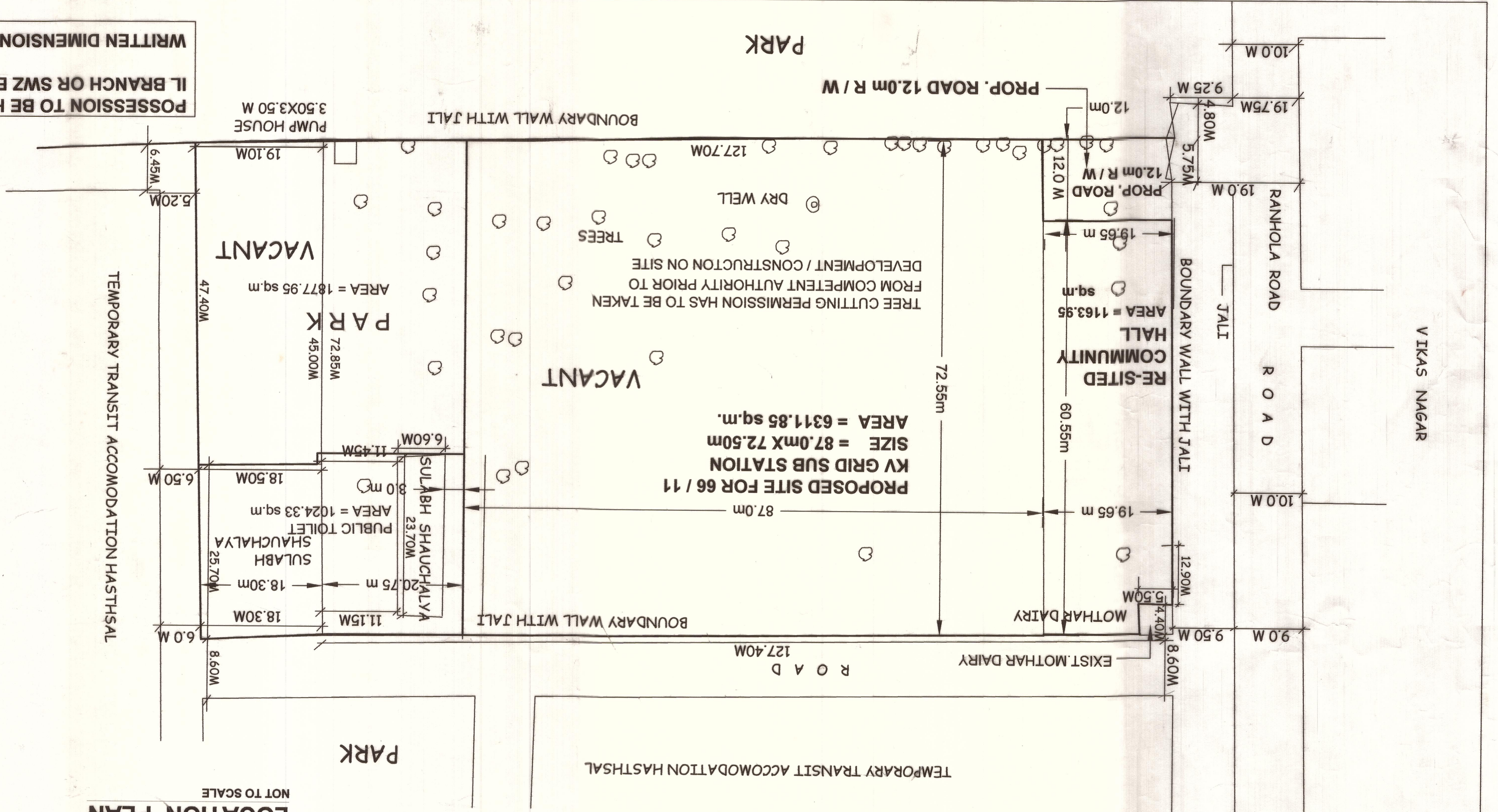

POSSESSION TO BE HANDED OVER BY  
 IL BRANCH OR SWZ ENGG. WING.  
 WRITTEN DIMENSIONS ONLY TO BE FOLLOWED.

# D. D. A. DWARKA PROJECT

## LAYOUT PLAN

### PROPOSED 66 / 11 KV ESS TO BE LOCATED WITHIN THE RECREATIONAL GREEN AREA (PARK) OF HASTHAL TRANSIT CAMP (SHIV VIHAR).

SCALE : 1 : 500

MANJIT SHARMA PLG. ASSTT.	MUKESH CHANDER PLG. ASSTT.	ASSTT. DIR. (PLG.) JT. DIRECTOR (PLG.)	DIRECTOR (PLG.)
DATE 10.11.06	DRG. NO.	NORTH	

NOTES :

TOTAL AREA	= 10639.73 sq.m
AREA UNDER 66 / 11 KV ESS	= 6311.85 sq.m
AREA UNDER EXIST. MOTHR DAIRY	= 25.85 sq.m
AREA UNDER RE-SITED COMMUNITY HALL	= 1163.95 sq.m
AREA UNDER EXIST. PUBLIC TOILET	= 1024.33 sq.m
AREA UNDER CIRCULATION	= 235.80 sq.m
AREA UNDER PARK	= 1877.95 sq.m

THIS DRG. HAS BEEN PREPARED ON THE BASIS OF P.T SURVEY OF VACANT LAND AT TEMPORARY TRANSIT ACCOMODATION HASTHAL VIDE SURVEY DRG. NO. 022 DATED 20.07.06 BEFORE STARTING THE DEVELOPMENT OF THE SITE BY THE ALLOTTEE. TREE CUTTING PERMISSION SHALL BE OBTAINED BY THE ALLOTTEE FROM THE CONCERNED AGENCY.

THE LAND DISPOSAL DEPARTMENT WILL TAKE FURTHER ACTION FOR ESTABLISH THE OWNERSHIP OF LAND AND FURTHER ALLOTMENT OF LAND.

DELHI DEVELOPMENT AUTHORITY