

AREA STATEMENT

S NO	USE/DESCRIPTION	AREA	PERCENTAGE
1	TOTAL AREA UNDER SCHEME	1.30 HA / 3.21 ACS	100.0%
2	AREA UNDER RESIDENTIAL USE	0.92 HA / 2.27 ACS	70.7%
3	AREA UNDER ROADS/CIRCULATION	0.28 HA / 0.69 ACS	21.6%
4	AREA UNDER COMMUNITY FACILITIES	0.10 HA / 0.25 ACS	7.7%
5	POPULATION	709 PERSONS	

STATEMENT OF STRUCTURES:-

S NO	DESCRIPTION	EXISTING STRUCTURES	REGULARISED	AFFECTED
	TOTAL NO OF STRUCTURES	162	157	5
1	PUCCA STRUCTURES	4	4	NIL
2	SEMI-PUCCA STRUCTURES	155	150	5
3	KUTCHA STRUCTURES	3	3	NIL

- LEGEND**
- EXISTING REGULARISED STRUCTURES SHOWN THUS
 - AFFECTED STRUCTURES SHOWN THUS
 - DISPENSARY CUM COMMUNITY HALL
 - SCHEME BOUNDARY

- NOTES:-**
- ROAD WIDTH TO BE AS SHOWN IN THE PLAN OR MORE IF AVAILABLE AT SITE
 - THIS DRAWING HAS BEEN PREPARED ON THE BASIS OF PHYSICAL SURVEY AND DATA SUPPLIED BY DY DIRECTOR (S) C.P. WING

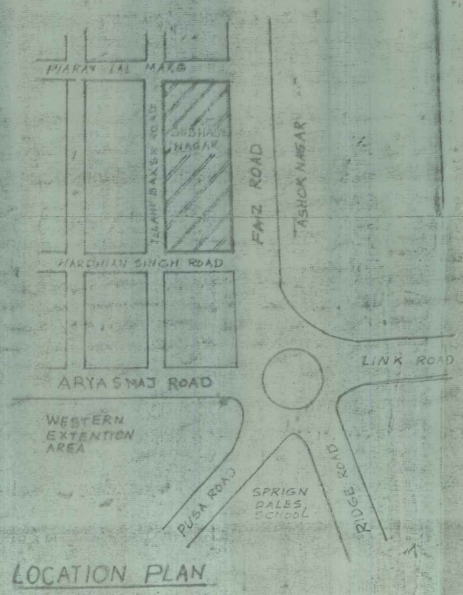

D. D. A. 395/62
7/11/11
CITY PLANNING WING

BUILDING ACTIVITY:-
WITH REFERENCE TO THE OFFICE ORDER NO 33/TP/93 DATED 12-7-93 THE STANDING COMMITTEE VIDE ITS DECISION NO 153 DATED 14-12-92 HAS PERMITTED THE BUILDING ACTIVITY AND COLLECTION OF DEVELOPMENT CHARGES IN RESPECT OF REGULARISED COLONY OF SUBHASH NAGAR (FAIZ ROAD) KAROL BAGH, AREA APPROXIMATELY TO THE CONDITIONS MENTIONED IN THE LETTER NO E-33/TP/1326/CIC DATED 11-12-92.

NOTE:-
PLAN APPROVED BY D.D.A VIDE REPLY NO 1085 DT. 10.05 SUBJECT TO AT PAR WITH THE DECISIONS OF HARIJANS WITH OTHER (S) (C53) 72 - PT 300

REGULARISATION PLAN OF SUBHASH NAGAR (FAIZ ROAD)

LAYOUT PLAN

ORB NO. TP/UC 22/06

DATE 11.08.11

SCALE 1:1000

DR. A. K. SINGH
CHIEF ENGINEER
CITY PLANNING WING

DR. A. K. SINGH
CHIEF ENGINEER
CITY PLANNING WING

395/62
7/11/11

395/62
7/11/11