

BA/G



दिल्ली विकास प्राधिकरण
DELHI DEVELOPMENT AUTHORITY
रोहिणी योजना कार्यालय
ROHINI PROJECT PLANNING OFFICE

AREA STATEMENT

TOTAL AREA OF PLOT = 3914.49 SQ.M.

DETAILS OF PLOT :

PLOT NO.	USE	AREA (IN SQ.M.)
1	ESS (Existing)	242.95
2	Multilevel Parking	2162.90
3	Dispensary	913.00
4	Religious	402.00
Circulation (5.0 M. wide Road R/W)		195.64

NOTES:

1. THIS DRAWING IS PREPARED ON THE BASIS OF P.T. SURVEY SUPPLIED BY SURVEY UNIT OF ROHINI PLANNING OFFICE ON 17.02.2016.
2. DEVELOPMENT CONTROL NORMS ARE AS PER MPD-2021
2. ALL DIMENSIONS ARE IN METRES
3. ONLY WRITTEN DIMENSIONS ARE TO BE FOLLOWED
4. THE SCHEME WAS APPROVED IN THE 34TH SCREENING COMMITTEE MEETING HELD ON 22.02.2017 VIDE ITEM NO. 11.2017.

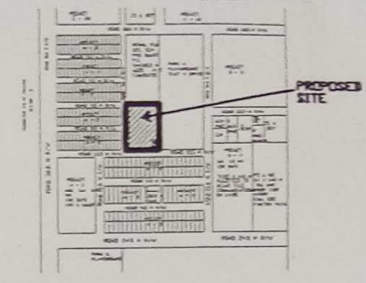

KEY PLAN

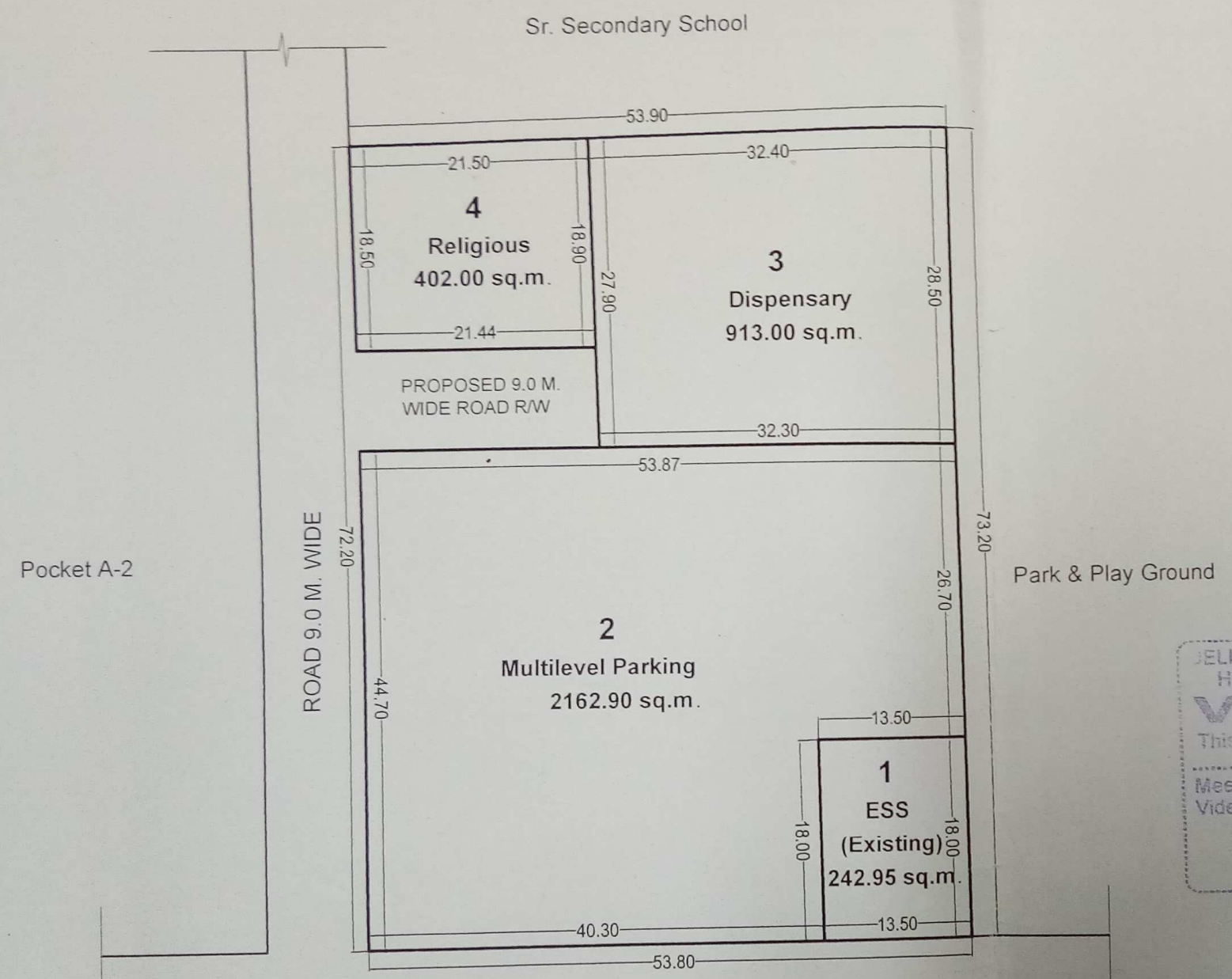

DELHI DEVELOPMENT AUTHORITY
HUPW-CO-ORDINATION UNIT
VERIFIED
This proposal was considered in the
347th Screening Committee
Meeting held on 22.2.2017
Vide item No. 11.2017
[Signature]
Dy. Director (Arch.) Co-ordn.

DELHI DEVELOPMENT AUTHORITY
CERTIFIED
Approved in 347th Screening
Committee Meeting Dt. 22.02.2017
vide Item No. 11.2017
Name *[Signature]*
Signature: Director (Plg.) Rohini
Zone M & H (PT)

The Proposal has been approved by the 347th Screening Committee held on 22.2.2017 vide item No. 11.2017 in File No. PP/R/1003-3/2002/PT/142

[Signature] A. K. Malhotra
Dy. Dir. (Plg.) Rohini
Zone M & H (PT)

[Signature] Deepak Joshi
Asstt. Dir. (Plg.) Rohini
Zone M & H (PT)

[Signature] Shakuntla Chopra
PLANNING ASST.
Zone H (PT)

FILE No: PP/R/1003-3/2002/PT/142

SUB-DIVISION PLAN OF LS/OCF PLOT IN POKET A-2 & A-3, SECTOR-III, ROHINI, PHASE-I & II

SCALE: 1:500

DATE: JANUARY 2017

PLG ASSTT: *[Signature]* ASSTT. DIR. (PLG./CONTRACT)

ASSTT. DIR. (PLG.): *[Signature]*

DIR. (PLG.): *[Signature]*

ROHINI
PLANNING OFFICE, NEW DELHI 110085

Pocket A-2

Sr. Secondary School

Park & Play Ground

Pocket-A-3