

# Yamuna Sports Complex

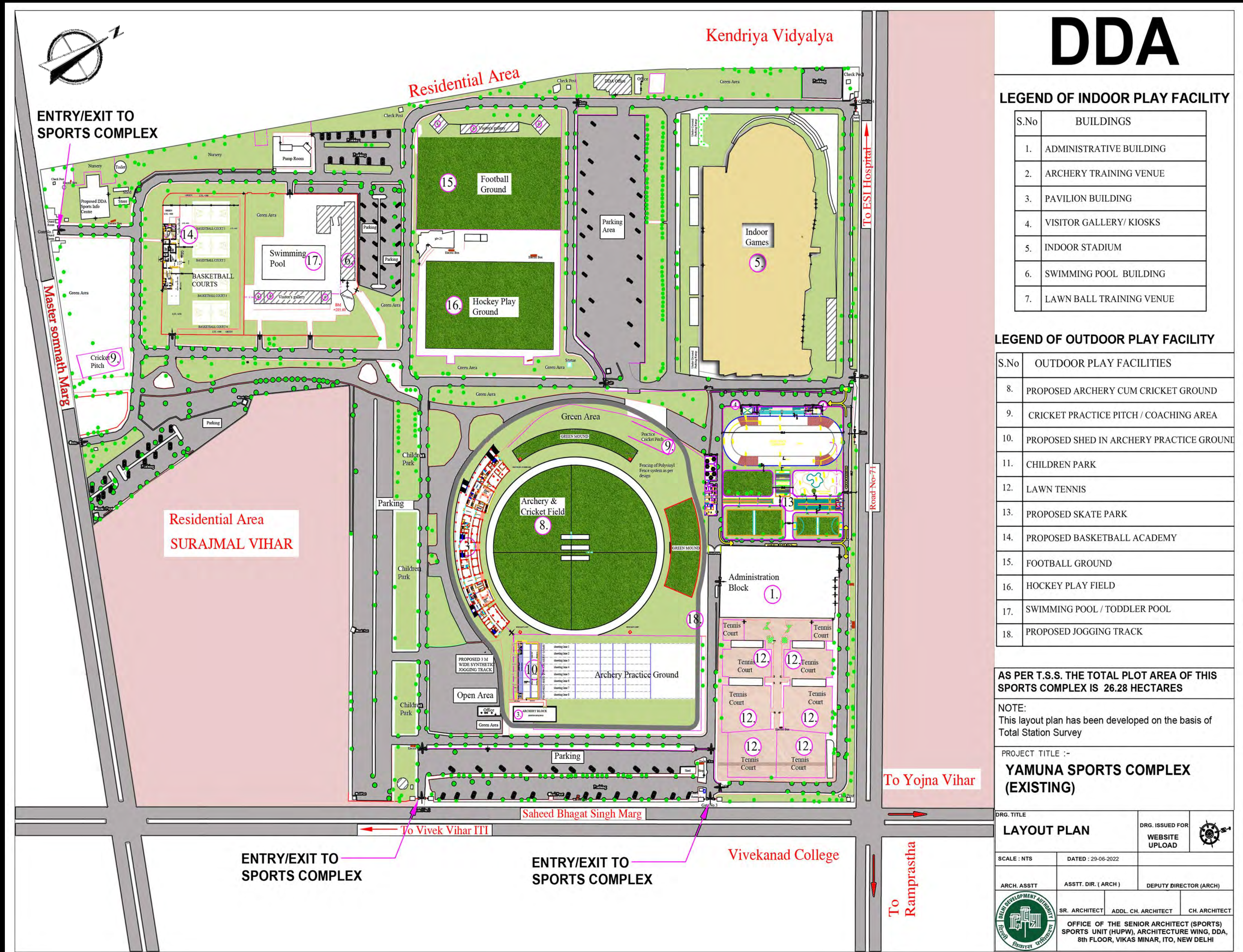

## DDA

### LEGEND OF INDOOR PLAY FACILITY

S.No	BUILDINGS
1.	ADMINISTRATIVE BUILDING
2.	ARCHERY TRAINING VENUE
3.	PAVILION BUILDING
4.	VISITOR GALLERY/ KIOSKS
5.	INDOOR STADIUM
6.	SWIMMING POOL BUILDING
7.	LAWN BALL TRAINING VENUE

### LEGEND OF OUTDOOR PLAY FACILITY

S.No	OUTDOOR PLAY FACILITIES
8.	PROPOSED ARCHERY CUM CRICKET GROUND
9.	CRICKET PRACTICE PITCH / COACHING AREA
10.	PROPOSED SHED IN ARCHERY PRACTICE GROUND
11.	CHILDREN PARK
12.	LAWN TENNIS
13.	PROPOSED SKATE PARK
14.	PROPOSED BASKETBALL ACADEMY
15.	FOOTBALL GROUND
16.	HOCKEY PLAY FIELD
17.	SWIMMING POOL / TODDLER POOL
18.	PROPOSED JOGGING TRACK

AS PER T.S.S. THE TOTAL PLOT AREA OF THIS SPORTS COMPLEX IS 26.28 HECTARES

NOTE:  
This layout plan has been developed on the basis of Total Station Survey

PROJECT TITLE :-  
**YAMUNA SPORTS COMPLEX (EXISTING)**

DRG. TITLE <b>LAYOUT PLAN</b>		DRG. ISSUED FOR WEBSITE UPLOAD
SCALE : NTS	DATED : 29-06-2022	
ARCH. ASST	ASST. DIR. ( ARCH )	DEPUTY DIRECTOR (ARCH)
		SR. ARCHITECT    ADDL. CH. ARCHITECT    CH. ARCHITECT OFFICE OF THE SENIOR ARCHITECT (SPORTS) SPORTS UNIT (HUPW), ARCHITECTURE WING, DDA, 8th FLOOR, VIKAS MINAR, ITO, NEW DELHI

