

# Rohini Sports Complex at Sector - 14



## D.D.A.

### LEGEND OF INDOOR PLAY FACILITIES

S.No	BUILDINGS
1.	RECEPTION BLOCK
2.	ADMINISTRATIVE BUILDING
3.	SQUASH BUILDING
4.	FACILITY BUILDING
5.	MULTIGYM BUILDING
6.	AEROBICS BLOCK
7.	SWIMMING POOL BUILDING
8.	INDOOR BADMINTON BUILDING

### LEGEND OF OUTDOOR PLAY FACILITIES

S.No	OUTDOOR PLAY FACILITIES
9.	FOOTBALL GROUND
10.	CRICKET PRACTICE PITCH / COACHING AREA
11.	MINI FOOTBALL GROUND
12.	CHILDREN PARK
13.	SWIMMING POOL / TODDLER POOL
14.	LAWN TENNIS
15.	SKATING RINK
16.	BADMINTON COURTS
17.	BASKETBALL COURTS
18.	YOGA HUT
19.	TENNIS PRACTICE WALL

#### NOTE:

As per T.S.S the plot area of :  
ROHINI SPORTS COMPLEX IS 7.06HA

#### NOTE:

This layout plan has been developed on  
the basis of Total Station Survey

PROJECT TITLE :-

**ROHINI SPORTS COMPLEX,  
SECTOR-14 (EXISTING)**

DRG. TITLE

**LAYOUT PLAN**

DRG. ISSUED FOR  
WEBSITE  
UPLOAD



SCALE : NTS

DATED : 29-06-2022

ARCH. ASSTT

ASSTT. DIR. ( ARCH )

DEPUTY DIRECTOR (ARCH)

SR. ARCHITECT

ADDL. CH. ARCHITECT

CH. ARCHITECT

OFFICE OF THE SENIOR ARCHITECT (SPORTS)

SPORTS UNIT (HUPW), ARCHITECTURE WING, DDA,

8th FLOOR, VIKAS MINAR, ITO, NEW DELHI

DELHI DEVELOPMENT AUTHORITY

ROHINI

SPORTS

Aggarwal Bhawan

Aggarwal Bhawan Road

Prashant Vihar

To Prashant Vihar

Shaheed Ram Prasad Bismil Marg

To Bhagwan Mahavir Marg →

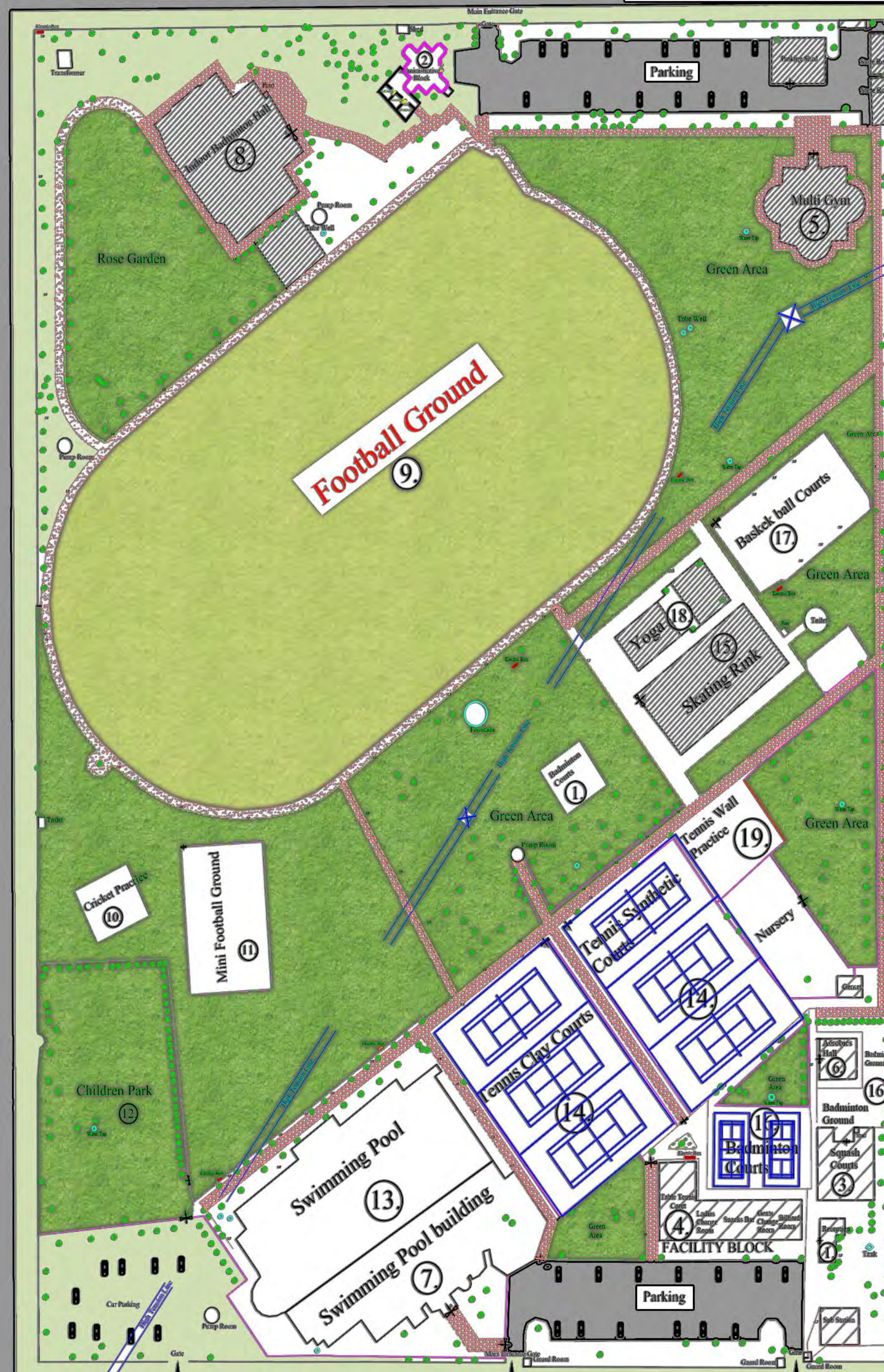

ENTRY TO THE PARKING

BS Road

MAIN ENTRY TO THE COMPLEX

MAIN ENTRY

To Sai Baba Chowk



HOUSING & URBAN PROJECTS WING

आवासीय एवं शहरीय परियोजना खण्ड

SPORTS