

Rashtriya Swabhiman Sports Complex at Pitampura

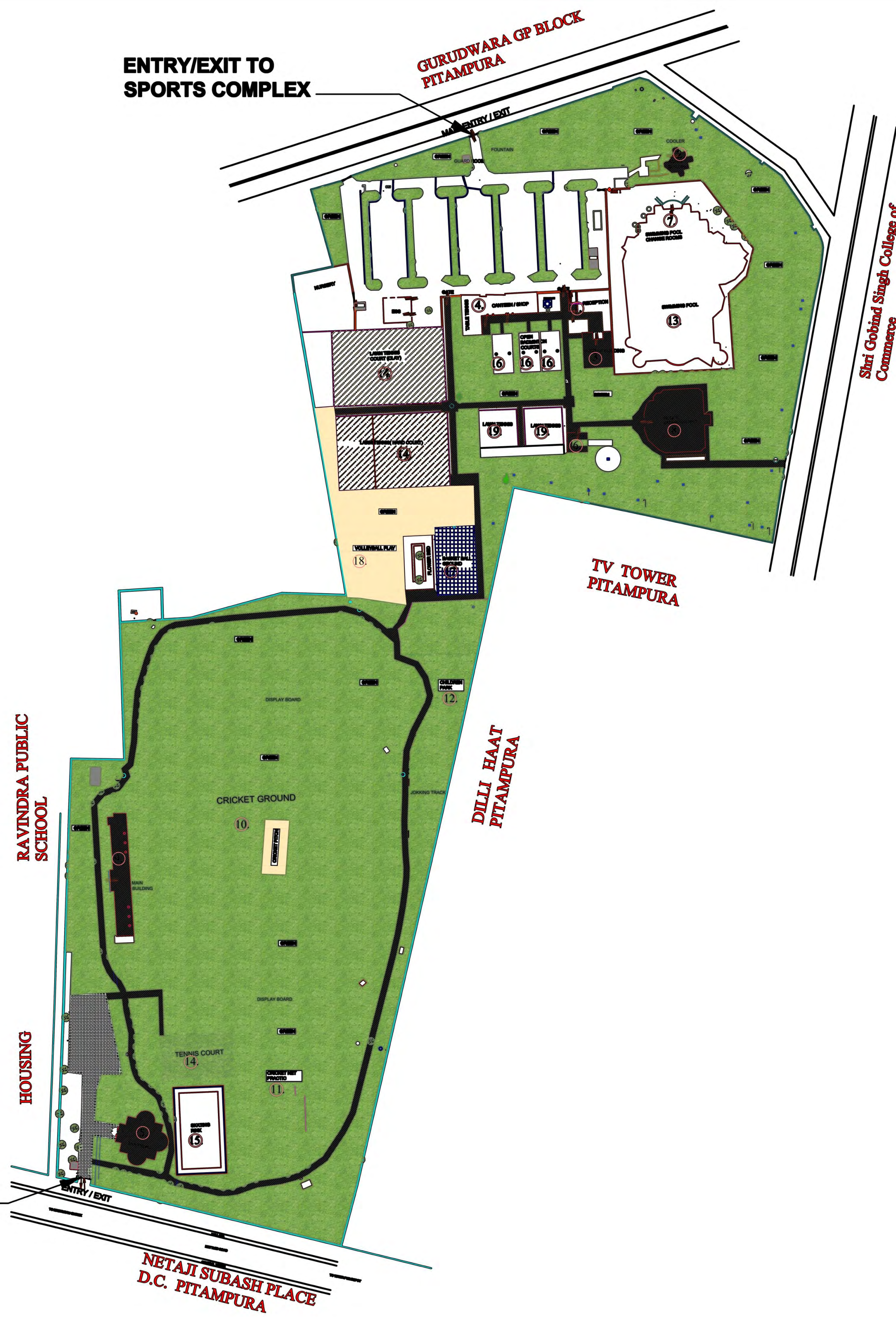
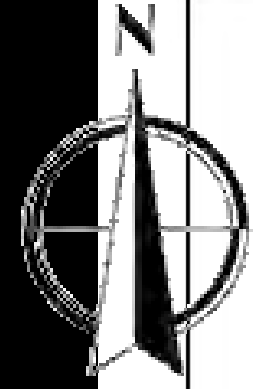

LEGEND OF INDOOR PLAY FACILITY

S.No	BUILDINGS
1.	RECEPTION BLOCK
2.	ADMINISTRATIVE BUILDING
3.	SQUASH BUILDING
4.	FACILITY BUILDING
5.	MULTIGYM BUILDING
6.	AEROBICS BLOCK
7.	SWIMMING POOL BUILDING
8.	INDOOR BADMINTON BUILDING
9.	CRICKET PAVILION BUILDING

LEGEND OF OUTDOOR PLAY FACILITY

S.No	OUTDOOR PLAY FACILITIES
10.	FOOTBALL GROUND
11.	CRICKET PRACTICE PITCH / COACHING AREA
12.	CHILDREN PARK
13.	SWIMMING POOL / TODDLER POOL
14.	LAWN TENNIS
15.	SKATING RINK
16.	BADMINTON COURTS
17.	BASKETBALL COURTS
18.	VOLLEY BALL COURT
19.	LAWN TENNIS PRACTICE

AS PER T.S.S. THE TOTAL PLOT AREA OF THIS SPORTS COMPLEX IS 9.48 HECTARES

NOTE:
This layout plan has been developed on the basis of Total Station Survey

PROJECT TITLE :-
RASHTRIYA SWABHIMAN KHEL PARISAR, PITAMPURA (EXISTING)

DRG. TITLE LAYOUT PLAN		DRG. ISSUED FOR WEBSITE UPLOAD	
SCALE : NTS	DATED : 29-06-2022		
ARCH. ASSTT	ASSTT. DIR. (ARCH)	DEPUTY DIRECTOR (ARCH)	
	SR. ARCHITECT	ADDL. CH. ARCHITECT	CH. ARCHITECT
OFFICE OF THE SENIOR ARCHITECT (SPORTS) SPORTS UNIT (HUPW), ARCHITECTURE WING, DDA, 8th FLOOR, VIKAS MINAR, ITO, NEW DELHI			

ENTRY/EXIT TO SPORTS COMPLEX

NETAJI SUBASH PLACE
D.C. PITAMPURA



HOUSING & URBAN PROJECTS WING
आवासीय एवं शहरीय परियोजना खण्ड

SPORTS