

Paschim Vihar Sports Complex

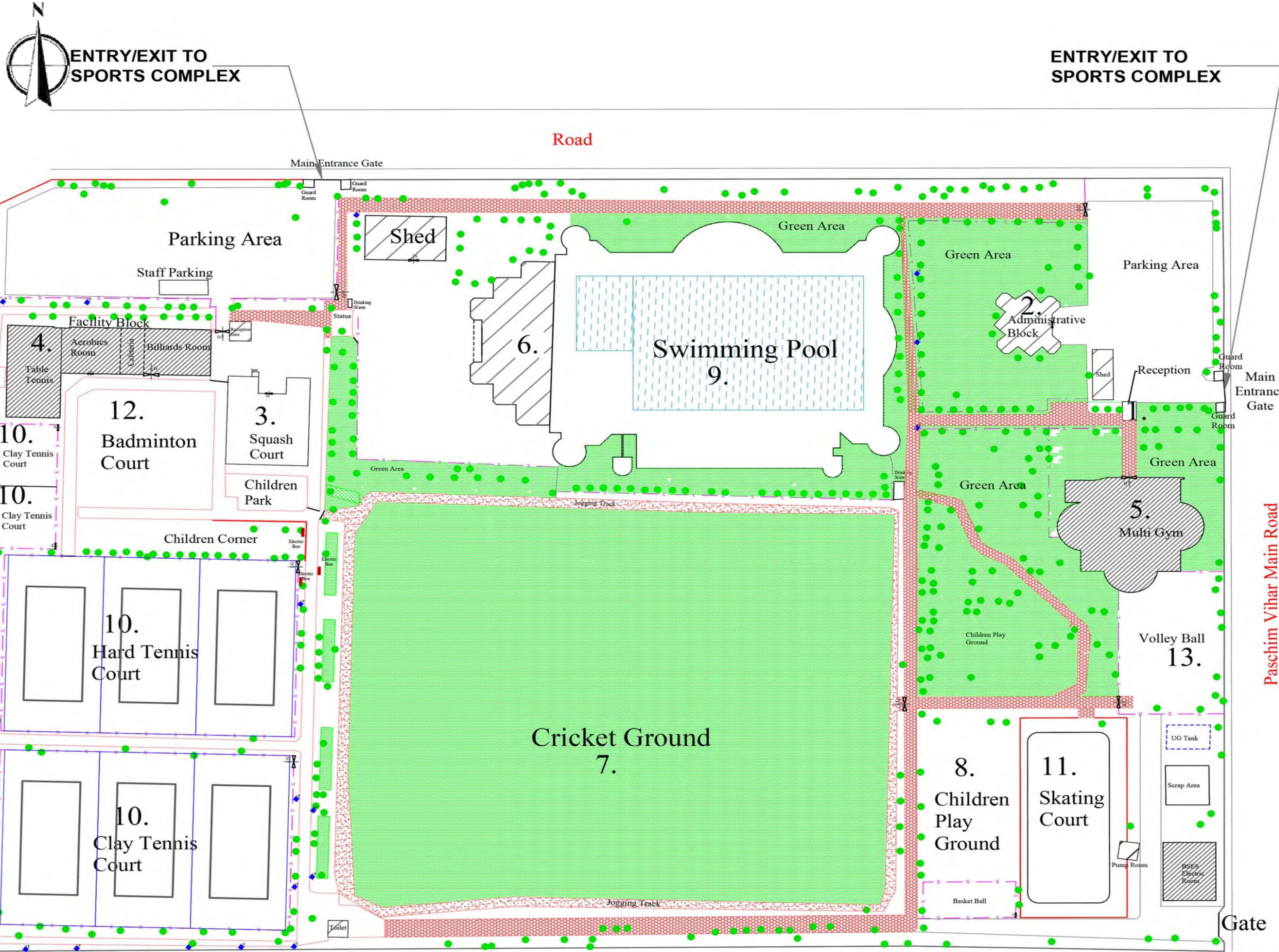

DDA

LEGEND OF INDOOR PLAY FACILITY

S.No	BUILDINGS
1.	RECEPTION BLOCK
2.	ADMINISTRATIVE BUILDING
3.	SQUASH BUILDING
4.	FACILITY BUILDING
5.	MULTIGYM BUILDING
6.	SWIMMING POOL BUILDING

LEGEND OF OUTDOOR PLAY FACILITY

S.No	OUTDOOR PLAY FACILITIES
7.	CRICKET GROUND
8.	CHILDREN PARK
9.	SWIMMING POOL / TODDLER POOL
10.	TENNIS COURTS
11.	SKATING RINK
12.	BADMINTON COURTS
13.	VOLLEYBALL COURTS

AS PER T.S.S. THE TOTAL PLOT AREA OF THIS SPORTS COMPLEX IS 3.65 HECTARES

NOTE:
This layout plan has been developed on the basis of Total Station Survey

PROJECT TITLE :-

PASCHIM VIHAR SPORTS COMPLEX (EXISTING)

DRG. TITLE LAYOUT PLAN		Uploading on Website DRG. ISSUED FOR	
SCALE : NTS		DRG. NO. L1	
ARCH. ASSTT	ASSTT. DIR. (ARCH)	DEPUTY DIRECTOR (ARCH)	
SR. ARCHITECT	ADDL. CH. ARCHITECT	CH. ARCHITECT	
OFFICE OF THE ADDL. CHIEF ARCHITECT - II SPORTS UNIT, HUPW, VIKAS MINAR, ITO, NEW DELHI			



HOUSING & URBAN PROJECTS WING
आवासीय एवं शहरीय परियोजना खण्ड

SPORTS