

Dwarka Sports Complex

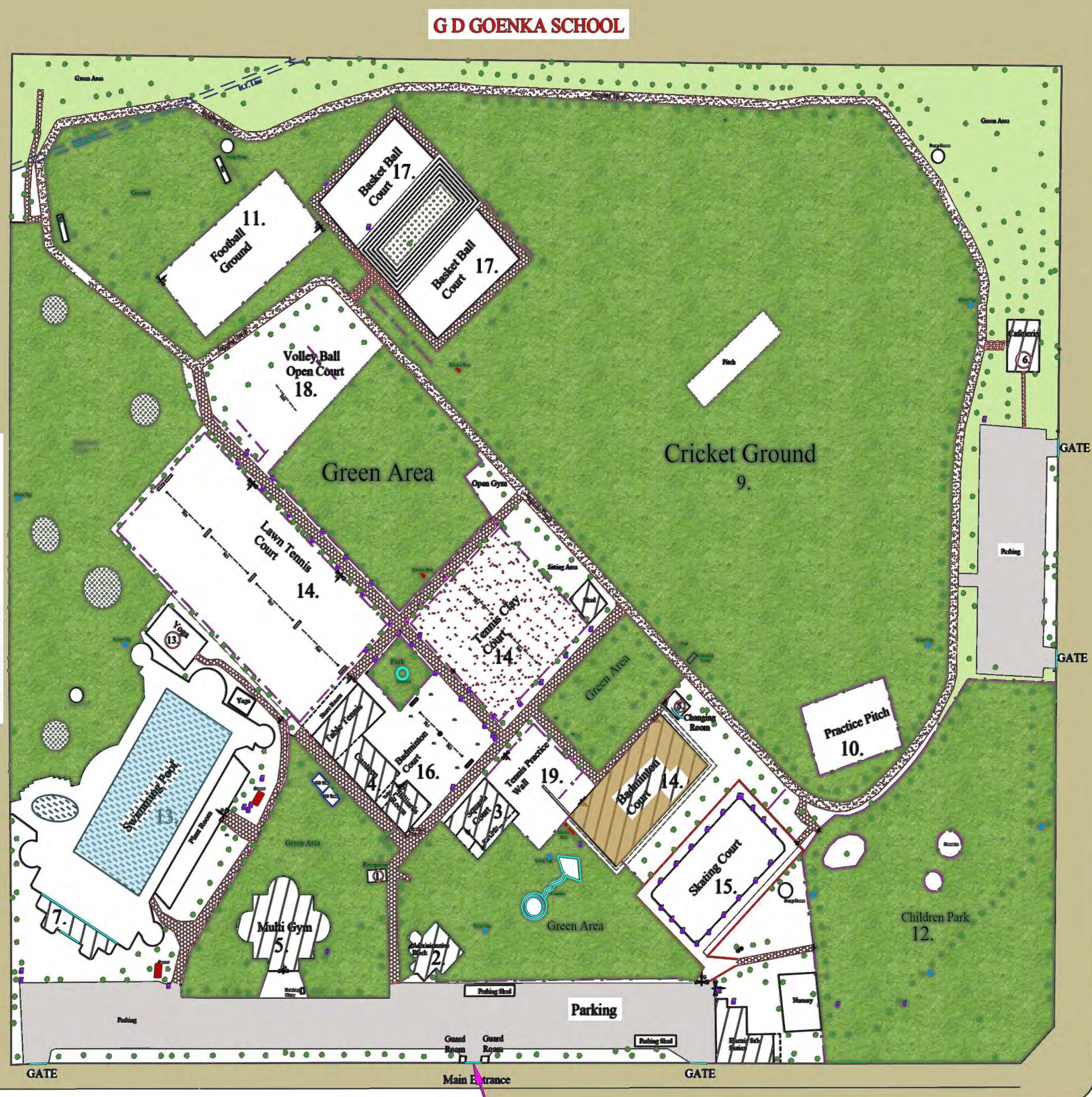

VACANT LAND / Site for Socio Cultural Area

Ramleela Ground



G D GOENKA SCHOOL

To Ashirwad Chowk Sector-12

PARK CUM NURSERY

To DTC Depot Sector-2

To Metro Station Sector-11

ENTRY/EXIT TO SPORTS COMPLEX

To Sector-10

DDA

LEGEND OF INDOOR PLAY FACILITY

S.No	BUILDINGS
1.	RECEPTION BLOCK
2.	ADMINISTRATIVE BUILDING
3.	SQUASH BUILDING
4.	FACILITY BUILDING
5.	MULTI GYM BUILDING
6.	CAFETERIA BLOCK
7.	SWIMMING POOL BUILDING
8.	CHANGE ROOM BLOCK

LEGEND OF OUTDOOR PLAY FACILITY

S.No	OUTDOOR PLAY FACILITIES
9.	CRICKET GROUND
10.	CRICKET PRACTICE PITCH / COACHING AREA
11.	MINI FOOTBALL GROUND
12.	CHILDREN PARK
13.	SWIMMING POOL / TODDLER POOL
14.	LAWN TENNIS
15.	SKATING RINK
16.	BADMINTON COURTS
17.	BASKETBALL COURTS
18.	VOLLEY BALL COURT
19.	LAWN TENNIS PRACTICE

AS PER T.S.S. THE TOTAL PLOT AREA OF THIS SPORTS COMPLEX IS 8.1 HECTARES

NOTE: This layout plan has been developed on the basis of Total Station Survey

PROJECT TITLE :-
DWARKA SPORTS COMPLEX (EXISTING)

DRG. TITLE LAYOUT PLAN		DRG. ISSUED FOR WEBSITE UPLOAD	
SCALE : NTS	DATED : 29-06-2022		
ARCH. ASSTT	ASSTT. DIR. (ARCH)	DEPUTY DIRECTOR (ARCH)	
	SR. ARCHITECT	ADDL. CH. ARCHITECT	CH. ARCHITECT
OFFICE OF THE SENIOR ARCHITECT (SPORTS) SPORTS UNIT (HUPW), ARCHITECTURE WING, DDA, 8th FLOOR, VIKAS MINAR, ITO, NEW DELHI			

