

DDA

AS BUILT DRAWING

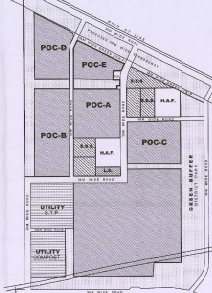

DELHI DEVELOPMENT AUTHORITY CERTIFIED
Approved under Section 25, 26 & 27 of the DDA Act, 1956.
Volume No. 56/2023
Date: 14/02/23
Signature: [Signature]

DELHI DEVELOPMENT AUTHORITY CERTIFIED
Approved under Section 25, 26 & 27 of the DDA Act, 1956.
Volume No. 56/2023
Date: 14/02/23
Signature: [Signature]

NOTES:

THIS DRAWING HAS BEEN PREPARED AS PER THE BASE DESIGN AND DRAWING AS APPROVED BY AUTHORITIES AS BELOW.

THE TOTAL SCHEME OBTAINED APPROVAL FROM DELHI URBAN ARTS COMMISSION UNDER LETTER 1162007-DUC/AS/AS DATED 13.04.2017, AND SUBSEQUENTLY GOT RELEASE APPROVED DRS WIDE (022017-DUC-14) DATED 22.08.2017.

THE SCHEME OBTAINED APPROVAL FROM DELHI FIRE SERVICE, WIDE LETTER F 61678/MS/62312/28 DATED 07.02.2017.

THE TOTAL SCHEME OBTAINED APPROVAL FROM D.D.A. IN THE 34TH SCREENING COMMITTEE MEETING HELD ON 09.12.2019 VIDE AGENDA NO 147/2019.

SL. NO.	REMARKS	DATE SIGN
REVISIONS		
2 BHK & EWS HOUSING FOR DELHI DEVELOPMENT AUTHORITY AT POC - I, LOKNAYAKPURAM		
SITE LAY OUT AS BUILT DRAWING (FAR STATEMENT)		
SCALE :	1 : 500	REV : 00
DRG. NO :	A/2/01	
DATE :	JAN '23	

AGENCY: GIRDHARI LAL CONSTRUCTIONS PVT LTD
550, SECTOR - 6-B, CHANDIGARH-160033
TEL: 91-172-265496, 96-9198720677

ARCHITECT: SUMIT MATTY ARCHITECTS
504 MANISHRA ST, NEHRU PLACE, NEW DELHI 110019
TEL: +91-11-4393501, 49519022
Email: sumitc@sumitc.com, sumitmatmyarchitects@gmail.com

This drawing is a copyright and property of the Architect. This is not to be copied, retransmitted, or used for any other purpose other than for which it has been prepared.

COMPARATIVE AREA STATEMENT

SITE LOCATION	POCKET / LOKNAYAKPURAM	DATE	31/03/2023
SITE AREA (AS PER TENDER)	3.64 HA	OR	31450 SQM
SITE AREA AS ACTUAL	(BY FAR STATEMENT)		31745 SQM

AS BUILT FAR AREA STATEMENT

SITE LOCATION	POCKET / LOKNAYAKPURAM	DATE	31/03/2023
SITE AREA (AS PER TENDER)	3.64 HA	OR	31450 SQM
SITE AREA AS ACTUAL	(BY FAR STATEMENT)		31745 SQM

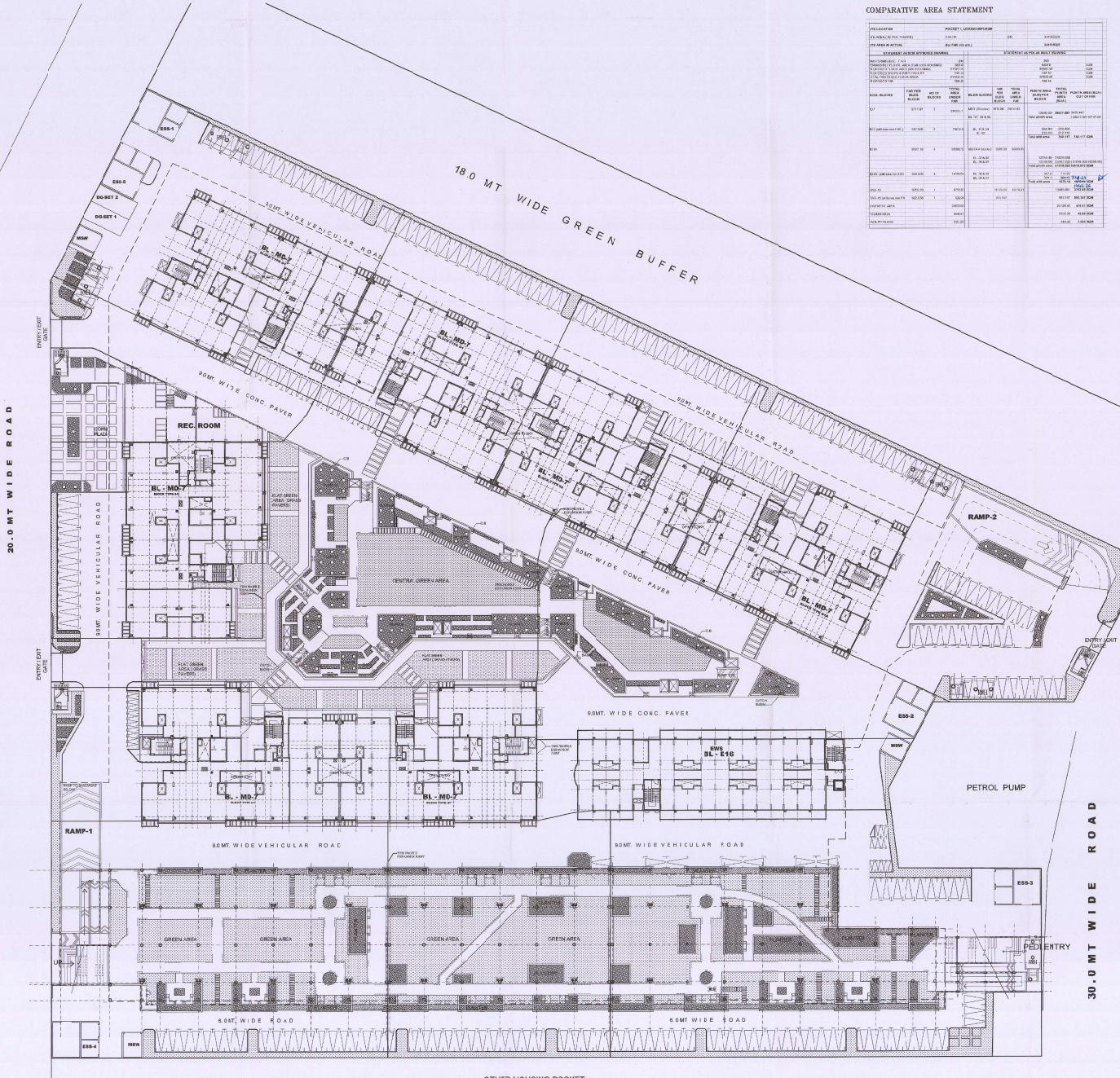

OTHER HOUSING POCKET

NO. OF 2 BHK DATE UNITS

NO. OF EWS DATE UNITS

NO. OF BHK DATE UNITS

NO. OF COMMUNITY FACILITIES

NO. OF PARKING SPOTS

NO. OF GREEN AREAS

NO. OF GREEN BUFFERS

NO. OF GREEN BELTS

NO. OF GREEN BELT AREAS

NO. OF GREEN BELT AREAS

NO. OF GREEN BELT AREAS

NO. OF GREEN AREAS

NO. OF GREEN BUFFERS

NO. OF GREEN BELTS

NO. OF GREEN BELT AREAS

NO. OF GREEN BELT AREAS

NO. OF GREEN BELT AREAS

NO. OF GREEN AREAS

NO. OF GREEN BUFFERS

NO. OF GREEN BELTS

NO. OF GREEN BELT AREAS

NO. OF GREEN BELT AREAS

NO. OF GREEN BELT AREAS

NO. OF GREEN AREAS

NO. OF GREEN BUFFERS

NO. OF GREEN BELTS

NO. OF GREEN BELT AREAS

NO. OF GREEN BELT AREAS

NO. OF GREEN BELT AREAS

VERIFIED
This project is contained in the DDA Act, 1956.
Date: 14/02/23
Signature: [Signature]