

D.D.A.

AREA STATEMENT:

TOTAL PLOT AREA	4350 SQM
PERMISSIBLE GROUND COVERAGE @ 50%	2175 SQM
PERMISSIBLE FAR @ 100	4350 SQM
PER. MAXIMUM HEIGHT	NR
PARKING REQUIRED @ 2ECS/100 SQM OF FAR AREA (TO BE PROVIDED WITHIN THE PLOT)	87 ECS
SET BACKS	Front - 6m. Rear - 3m. Sides - 3m. each
BASEMENTS	AS PER MPD-2021

AREA TO BE PROVIDED FOR FACILITIES: (To be provided within the six months of acquiring plot.)

1. Space for Mother dairy Milk, Fruit & Vegetable Booth (with space for Mother Dairy truck parking in front) on 30.0M wide road.	11.5M. x 6.5M.
2. Shops to be constructed for daily needs	5 Nos.

* Max. 10% additional ground coverage shall be allowed for atrium in LSC as per MPD-2021.

* All other development control norms will be as per MPD-2021 and UBBL-2016.

Note:

* The proposal for relaxation in the permissible set backs to adopt the setbacks of preceding category was approved in 5th Technical Committee Meeting held on the dt. 27.05.2022 vide item no. 22:2022 / as per sub clause 8(3) Regulations for Building Controls within use premises of chapter 17.0 of Master Plan of Delhi-2021, subject to all statutory clearances.

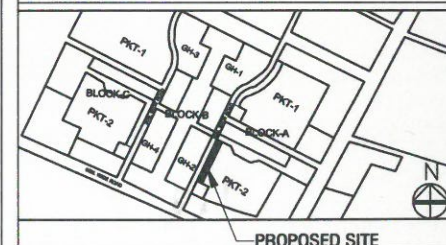

Note -
 • All dimensions are in mm. unless otherwise specified.
 • Do not scale the drawing and follow written dimensions only
 • Any discrepancy in the drawing shall be brought to the notice of Senior Architect (Rohini).

PROJECT TITLE :
COMMERCIAL PLOT IN POCKET-II, BLOCK-A, SECTOR-30: PHASE - IV, ROHINI

SHEET TITLE : SITE LAYOUT		01 DRG. NO.
SCALE NTS	DATE JULY, 2022	SCH. NO.
ARCH. ASSTT. <i>[Signature]</i>	ASSTT. DIR.(ARCH.) <i>[Signature]</i>	DY.DIR. (ARCH.)
SR. ARCH. <i>[Signature]</i>	ADD.CH. ARCH.	CH. ARCH.

OFFICE OF SENIOR ARCHITECT,
 ROHINI ZONE, FIRST FLOOR, DDA,
 MADHUBAN CHOWK, ROHINI

Note:
 * The Scheme has been approved in the 405th SCM held on 7.7.2022 vide item no. 42:2022.

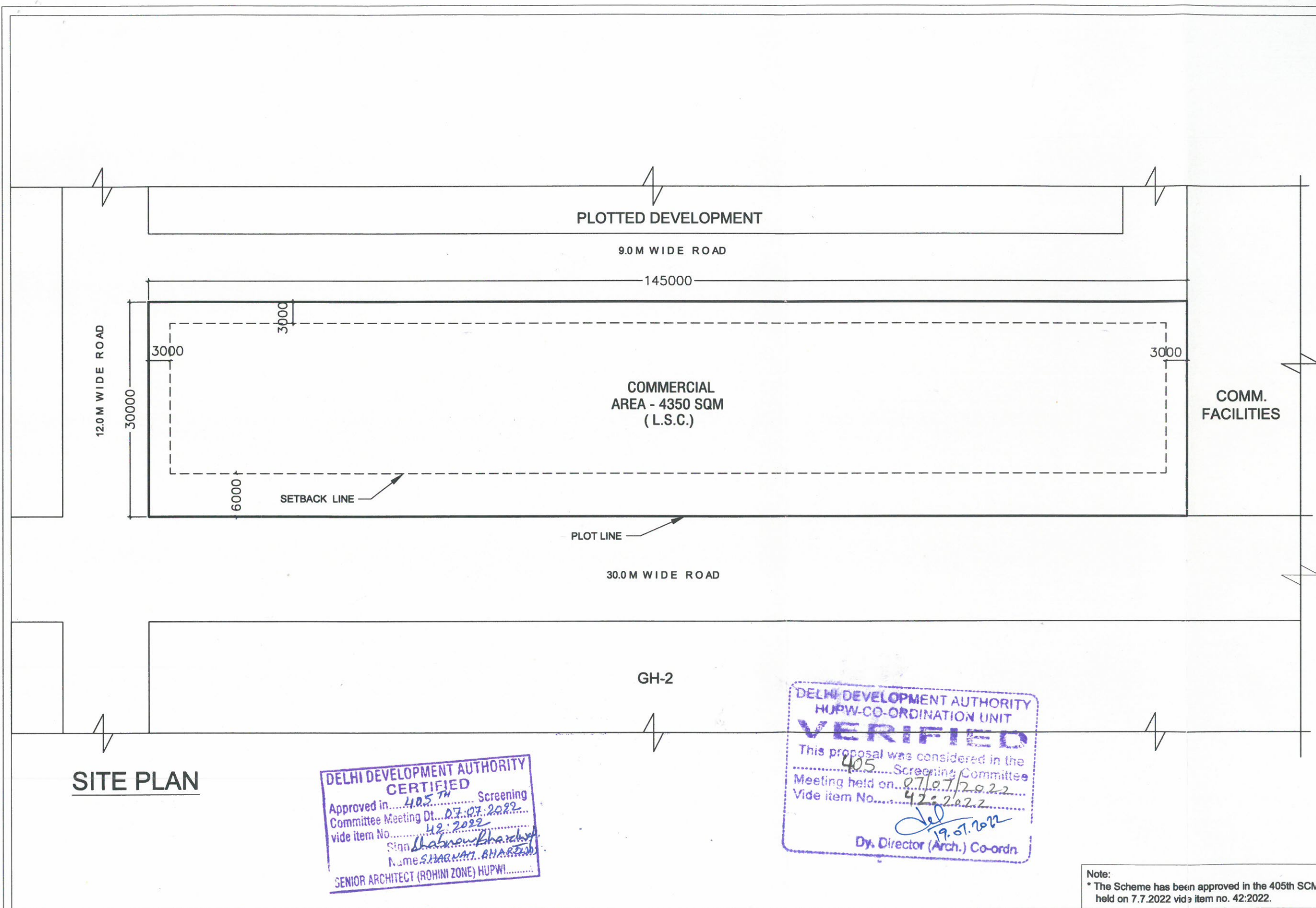

SITE PLAN

**DELHI DEVELOPMENT AUTHORITY
 CERTIFIED**
 Approved in 405TH Screening
 Committee Meeting Dt. 07.07.2022
 vide item No. 42:2022
 Sign *[Signature]*
 Name SHARVATI BHARDE
 SENIOR ARCHITECT (ROHINI ZONE) HUPWI

**DELHI DEVELOPMENT AUTHORITY
 HUPW-CO-ORDINATION UNIT
 VERIFIED**
 This proposal was considered in the
 405TH Screening Committee
 Meeting held on 07.07.2022
 vide item No. 42:2022
 Dy. Director (Arch.) Co-ordn.
 19.07.2022