

(2)

No.1(7)CSC/Survey/83
Government of India
Department of Rehabilitation
Settlement Wing.

Jaisalmer House, New Delhi.
Dated the 18th January, 84.

To

The Director,
Land & Management,
Delhi Development Authority,
Vikas Minar,
New Delhi.

Sub:- Physical possession of lands in Lajpat Nagar IV.

Sir,

I am directed to refer to the Dy.Secretary, DOR's d.o.letter No.4(34)/83-SS.II Dated 28th September, 1983. The lands in Lajpat Nagar-IV, New Delhi have been handed over to the representative of the DDA (Shri S.D.Kathuria), Asstt. Settlement Officer(Lands) on 3.1.84. The particulars of the lands handed over contained in the list (17 items) together with site plans are sent herewith in duplicate. A copy of the layout plan of Lajpat Nagar-IV showing the lands is also sent.

Yours faithfully,

Encl:-As above.

R.C. Bakshi
18/1/84
(R.C. BAKSHI)
ASSTT.ENGINEER (V)

1. Copy to the Land & Development Officer, Ministry of Works and Housing, Nirman Bhawan, New Delhi along with a copy of the statement and set of site plans for their information and record.
2. Copy to the Section Officer, SS.II Section for information.
3. Copy to SO-cum-M.O.(GBP) Jaisalmer House, New Delhi for information and to have necessary entries made in their records.

ASSTT. ENGINEER (V)

STATEMENT SHOWING LAND HANDED OVER
TO D.D.A. IN LAJPAT NAGAR IV-DELHI.

S.NO.	Particulars of piece of land.	Area	Kind of encroachment	Remarks
1.	Land in front of Bungalow plot no.1 and Block no.6&7.	2817sq.yds.	1. MCD store about 600 sq.yds. 2. MCD park about 697 sq.yds. 3. MCD pumping station about 380 sq.yds. 4. Shri.Nathuram Smt.Tara Waroti Shri. Babu Lal about 623 sq.yds. 5. Taxi Stand (Temp.) about 439 sq.yds.	Pucca Park. Pucca. Temp. Khokas. Temp.
2.	Land in front of Khalsa School and Amar Colony Block A&B	^{3.56} 6.86 acrs. <i>M</i>	1. Temp. 30 Khokas about 3236 sq.yds. 2. Two Gas stores about 1563 sq.yds. 3. Vacant land in between Gas stores of Saraswati Shishu Mandir (School) about 1120 sq.yds. 4. Saraswati Shishu Mandir (School) about 3373sq.yds. 5. MCD Nursery and park about 2777 sq.yds.	Temp. Khokas. Pucca Temp. Vacant Pucca Park.
3.	Land in front of DDA Artist Corner Village Garhi.	About 1.25 acrs.	1. Vacant & developed as Park by D.D.A.	Pucca house.
4.	Land by the side of Bungalow no.35 (One east side) the junction of Ring Road and Gari Road.	2266 ²⁶¹⁶ sq.yds. <i>ky</i>	Vacant	Plots no. 36/1, 36/2 37/1 + 37/2
5.	Land near House no. C/33,41 and 68 Block, C, Lajpat Nagar-4 Part-I.	920 sq.yds. ^{217 "} 415 " 1552 sq.yds. <i>1652 sq.yds.</i>	1. Encroached by 10 shops known as Ramesh Market is about 675 sq.yds. & Rest vacant	Pucca
6.	Land at the back of Lady Sri Ram College, Lajpat Nagar-IV	8.4 acrs.	Vacant	Vacant.
7.	Land at the back of shop no. 7 to 20 Amar Colony, Lajpat Nagar-IV	1.5 acrs.	Developed as Park by DMC	It was ear-marked as <i>Y</i> school.

Quacer 31.84
kes 51/18
...2/-

3-

- | | | | | |
|-----|--|--------------|--|--|
| 8. | Land in front of Qr. no. 64 to 102 National park Lajpat Nagar-IV | 0.8 acrs. | Developed as park by DMC. | It was earmarked for community Centre. |
| 9. | Land adjoining to Electric sub-station in front of D/s Blocks no. 1 & 2. | 1575 sq.yds. | Partly encroached by Coal Dept. 693 sq.yds. and remaining area vacant. | |
| 10. | Plot adj. to A/164 (Part-I) Lajpat Nagar. | 370 sq.yds. | MCD Developed park. | |
| 11. | Plot adj. to B/63 (P-I) Lajpat Nagar-IV. | 133 sq.yds. | Encroached by Compound wall & Shed by allottee of B/63. | |
| 12. | Plot adj. to A/124 Part-II, Lajpat Nagar. | 137 sq.yds. | Fenced by owner of adjoining House no. A/124. | |
| 13. | D-IV/48, Amar Colony. Part-I | 100 sq.yds. | Encroached. | Temp. |
| 14. | D-IV/33/A -do- Part-I | 100 sq.yds. | Vacant. | |
| 15. | E/IV/253 -do- Part-II | 100 sq.yds. | Encroached. (AUCTION) | Temp. |
| 16. | C-IV/6 -do- Part-II | 100 sq.yds. | Encroached. (AUCTION) | Temp. |
| 17. | E/IV/265 -do- Part-II | 100 sq.yds. | Encroached by adjoining house. | |
| 18. | E/IV/143 Part-I | | | |

These sites are handed over to D.D.A. as per DO Letter no. 4(34)/83 SS.II dt.26.9.83 in accordance with the sanction letter no.4(19)78/SS.II(Vol.II) dt.2.9.82.

Taken Over

[Signature]
 (S.D.KATHURIA)
 Asstt. Settlement Officer
 (Lands-II)
 Delhi Development Authority.
 Delhi.

Handed over

[Signature]
 (B.P. MAITHANI)
 Settlement Officer
 GBP

[Signature]
 (R.C. BAKSHI)
 Asstt. Engineer
 Jaisalmer Ho
 New Delhi.

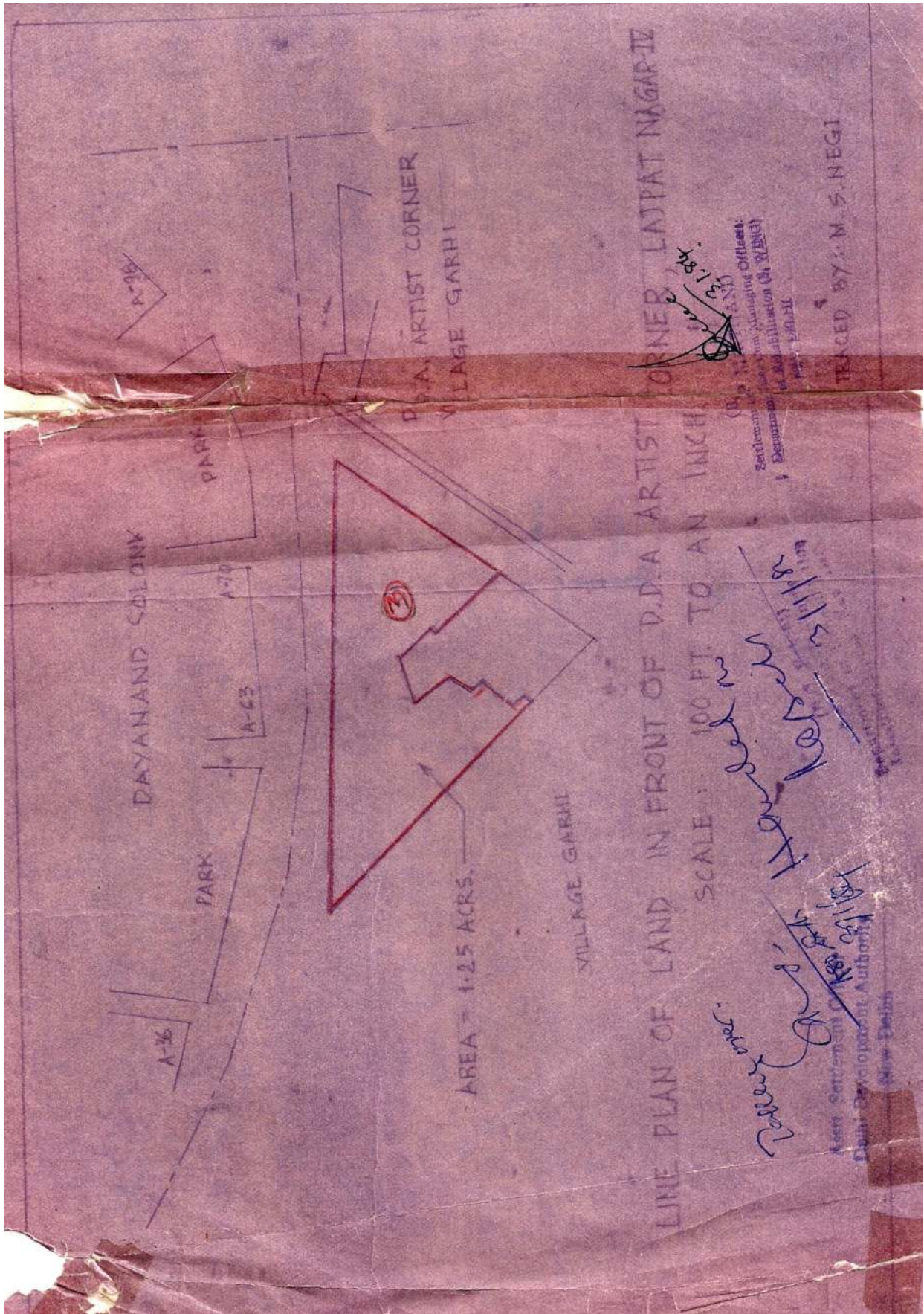

DAYANAND COLONY

PARK

PARK

3

AREA = 1.25 ACRES.

VILLAGE GARHI

LINE PLAN OF LAND IN FRONT OF D.D.A. ARTIST CORNER LATPAT NAGAR-IV

SCALE : 100 FT TO AN INCH

Ramesh Chandra
 28/11/15
 28/11/15

Registered
 Town Planning Officer
 at Jabalpur (M.P.)
 No. 1/2015

DESIGNED BY: M. S. NEGI

Urban Development Authority
 New Delhi

22

LAND ON EAST OF BUNGALOW PLOT NO 5, LAJPAT NAGAR-IV NEW DELHI.

P. AREA = $\frac{2616}{2501} \times 5670$ SQYDS.

NOT TO SCALE

GREEN BELT ROAD

HOUSES

LANE 41' WIDE

FLATS

SM 4

126 Plot no 38

Plot 36+37

VACANT 2616 sq

202'8"

LANE

(35)

FLAT NO 35

TO I.T.O. ← RING ROAD → TO MOOLCHAND

Handed over

Handwritten signature

Taken over

Handwritten signature
31/1/84

Department of Rehabilitation
Jawahar House, New Delhi

3.1.84

TRACED BY
S. RAGHAV

LINE PLAN SHOWING THE POSITION OF LAND
PHYSICALLY HANDED OVER TO D.D.A.

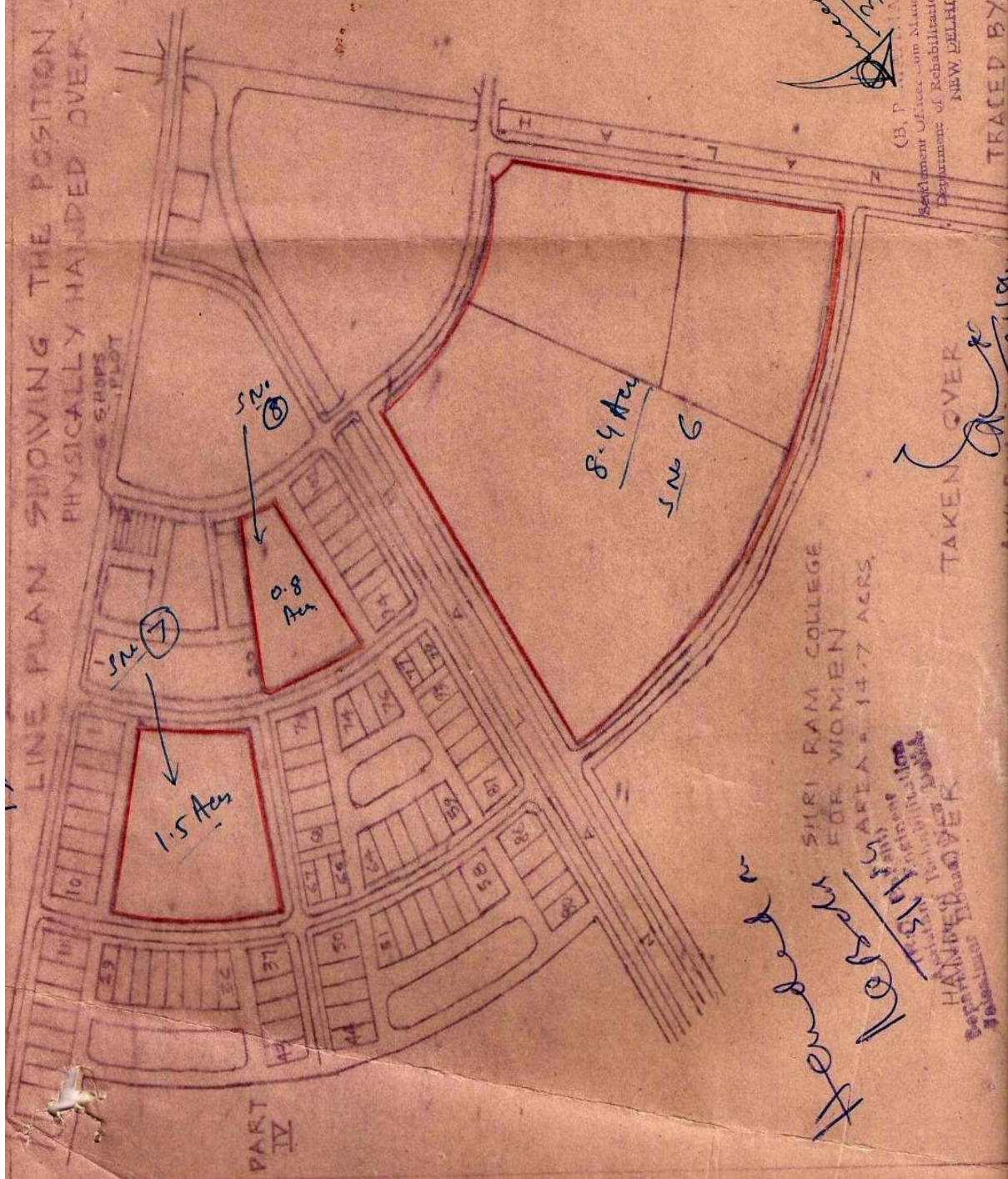

(B, P. ...)
Settlement Officer cum Managing Officer,
Department of Rehabilitation (S, WING)
NEW DELHI

TRADED BY: M. S. NEGI

SRI RAM COLLEGE
FOR WOMEN
AREA = 14.7 ACRES.

Hemendra

15/11/1954
HANDED OVER
Settlement Officer cum Managing Officer

TAKEN OVER

12

THE PLAN SHOWING THE POSITION
OF LAND ADJACENT TO A/164 PART-I
LAJPAT NAGAR -IV (N.H) NEW DELHI

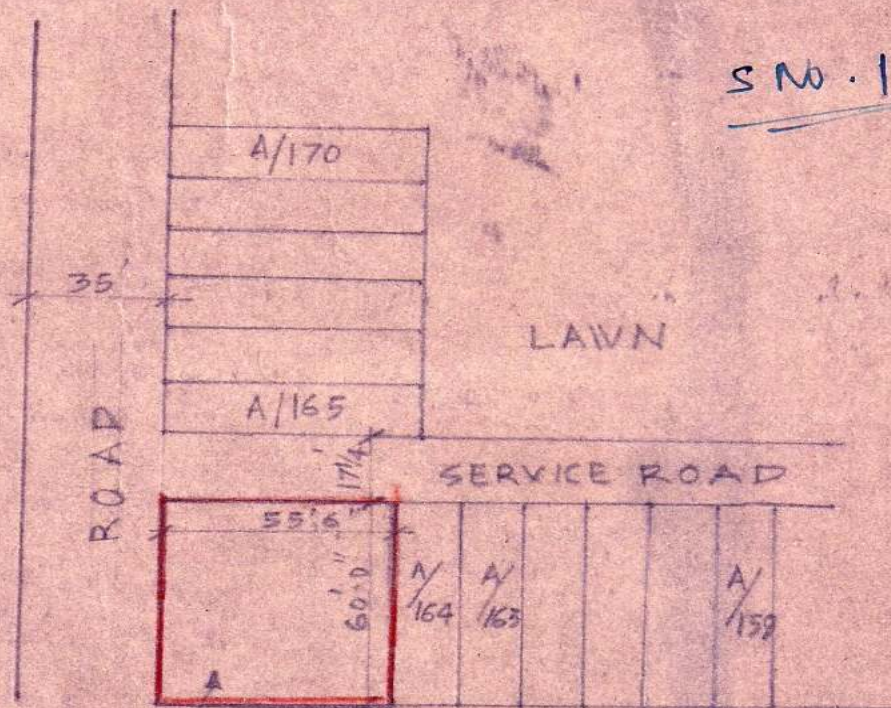

S No. 10

ROAD
PLOT AREA = 370*50. YDS.

HANDED OVER

Queer
3.1.84 *NeBahl*
31/1/84

Department of Rehabilitation
Sahakar House New Delhi

TAKEN OVER

Ad
31/1/84
Asstt. Settlement Officer
Delhi Development Authority
New Delhi.
TRACED BY: M. S. NEGI

11/15 (12)

LINE PLAN SHOWING THE POSITION OF LAND ADJACENT TO PLOT NO. B/63 LAJPAT NAGAR IV NEW DELHI

SNO 11

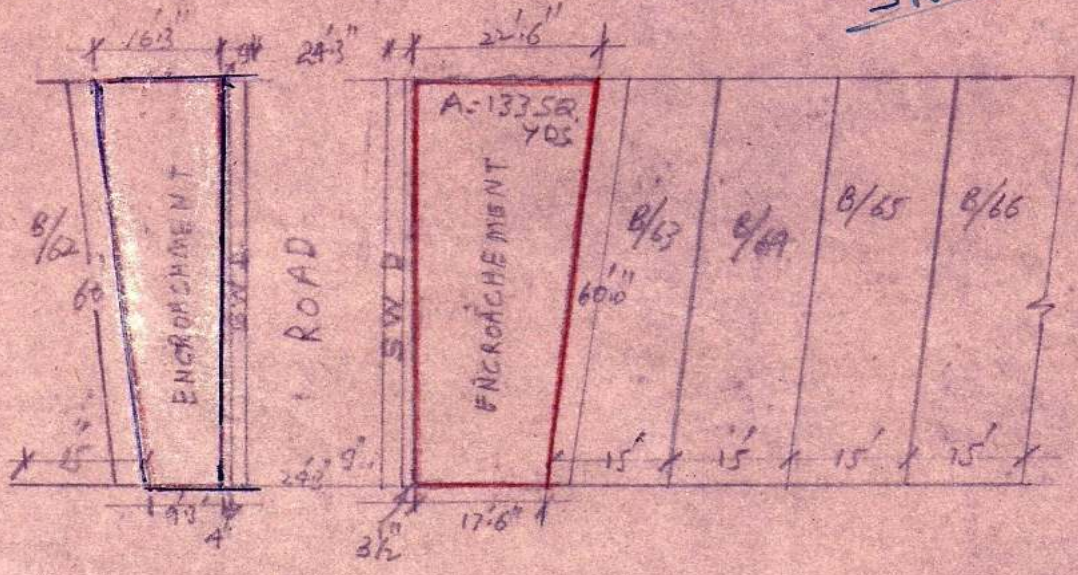

ROAD 52' WIDE

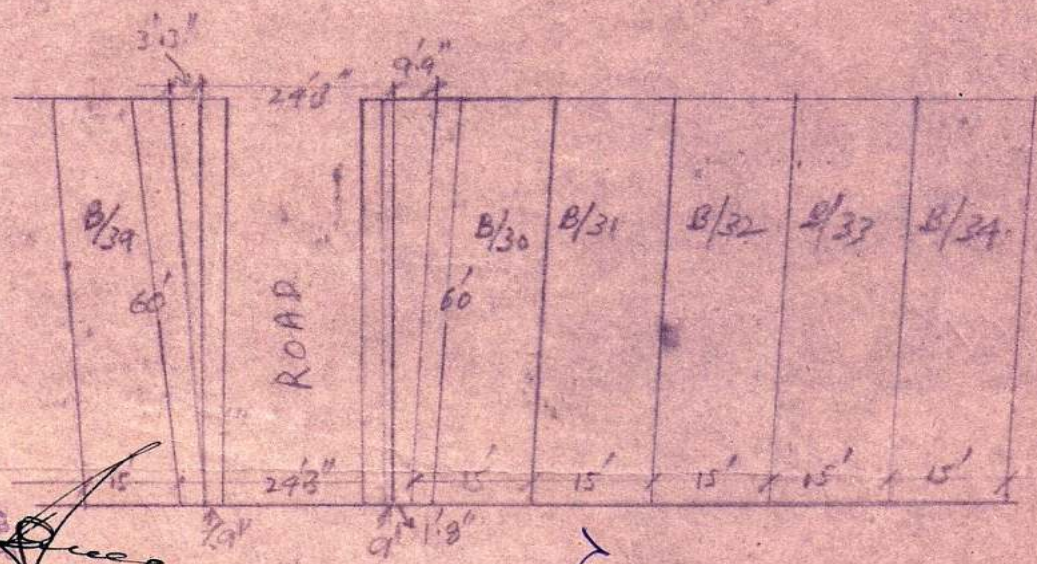

Department of Rehabilitation
NEW DELHI
Joint Managing Officers
(B) and (C)

Handed Over
1.8/1/84
3/1/84

Department of Rehabilitation
Jaisalmer House, New Delhi

Taken Over
31/1/84

Asst. Secy. in Charge
Delhi Development Authority
TRACED BY M.P.S. RAJAN

LINE PLAN SHOWING LAND HANDED
 OVER TO D.D.A. ADJOINING TO H.M.
 A-IV / 124 (PART) LAXPAT-NAGAR-IV
 NEW DELHI (NOT TO SCALE)
 AREA = 137 sq. yds ($\frac{15+26}{2} \times 60$)

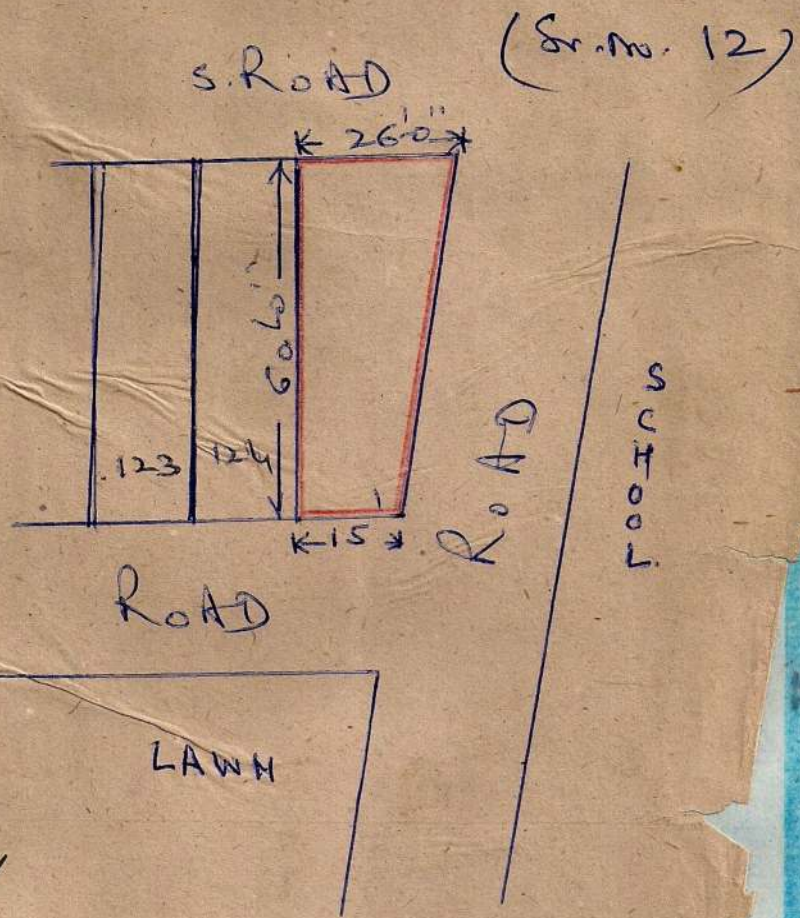

31/84 Handed over
 N. B. S. / 31/12
 Section Officer
 Rehabilitation (S. WING)
 NEW DELHI
 Department of Rehabilitation
 New Delhi

T. S. / 31/12
 Asstt. Settlement
 Delhi Development
 New De

LINE PLAN SHOWING LAND HANDED
 OVER TO D.D.A. PLOT NO. D-IV/48
 (PART I) (~~to be handed~~) Lajpat Nagar IV
 NEW DELHI (NOT TO SCALE)

P. AREA = 100 SQ YDS (15 x 60)
 (S.N. NO. 13)

Block - D -
 ORT no. 17 to 33

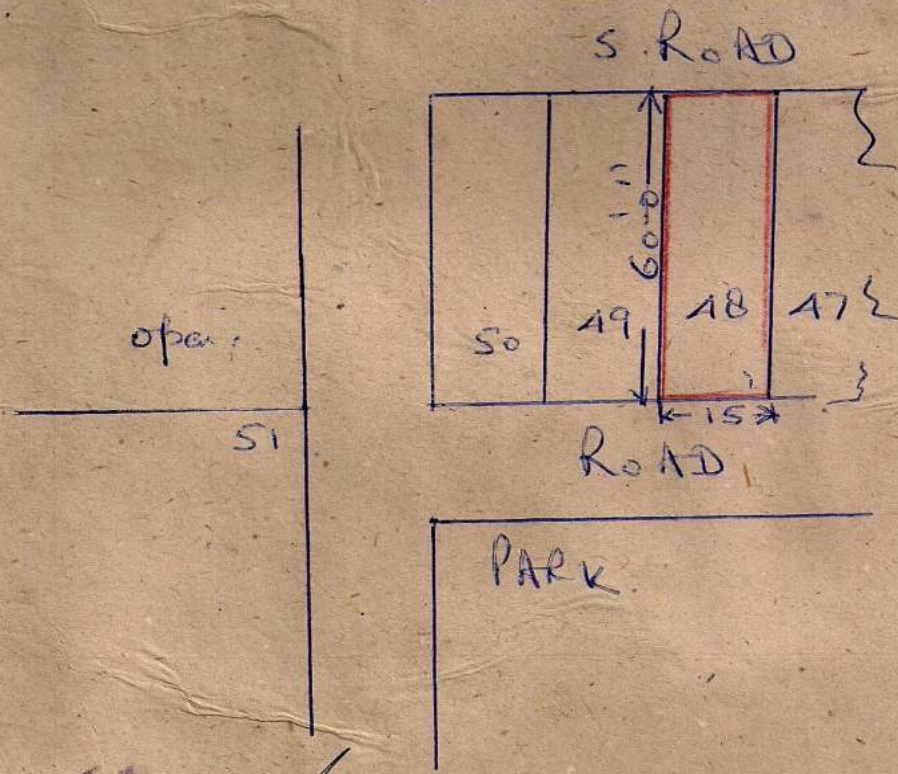

3/18/87
 3/1/89
 Department of Rehabilitation (S. Y. WING)

Handed over
 3/1/89

Taken over
 3/1/89

Asstt. Secy
 Delhi Dev
 Department of Rehabilitation

17-15

LINE PLAN SHOWING LAND
HANDLED OVER TO D.D.A. ASSIGNING
TO D-IV-33 (PART-I) LASPAT NAGAR
N.H. IV NEW DELHI (NOT TO SCALE)
(NEW NO D-IV-33/A)

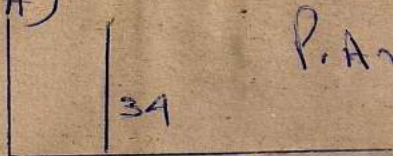

P. Area = 100 sq. yds.
(15' x 60')

S. ROAD (Sr. No. 14)

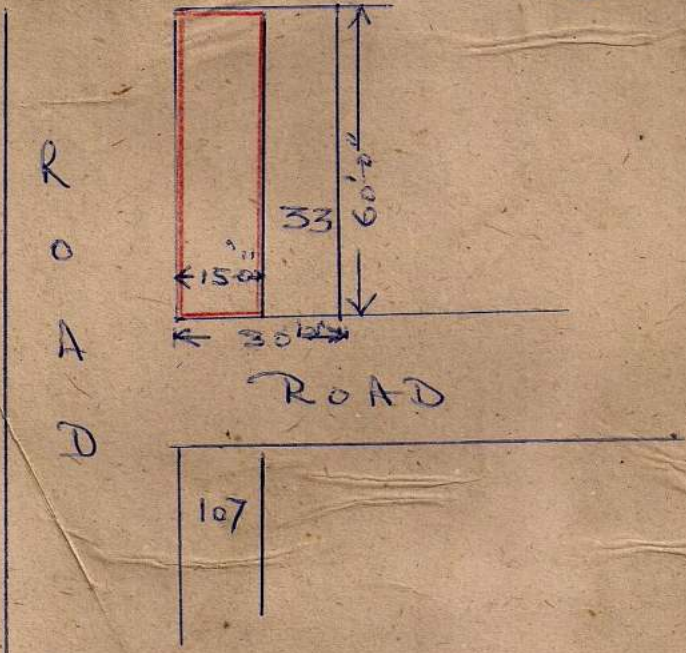

Handed over
31/1/8
31/1/8
Asstt. Engineer
Department of
Jalshila Dept.

Taken over
Asstt. Settlement
Delhi Development
New Delhi.

LINE PLAN SHOWING LAND HANDED
 OVER TO D.D.A. PLOT NO. E/IV/253
 (PART-II) LALPAT-NAGAR, NEW DELHI
 IV
 (NOT TO SCALE)

P. AREA = 100 SQ. YDS. (15' x 60')

(Sv. No. 15)

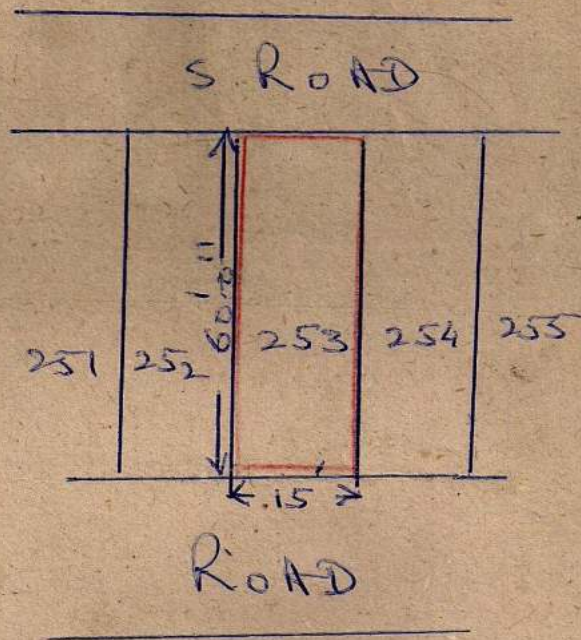

Copy By
 10/5/84
 Settlement Officer (S. Wing)
 Department of Rehabilitation
 NEW DELHI

Handed over
 3/11/84
 Nesohu
 Assistant Engineer
 Department of Rehabilitation

Taken over
 3/11/84
 Asst. Settlement Officer
 Delhi Development Authority
 New Delhi

LINE PLAN SHOWING LAND HANDED
 OVER TO D.D.A. ~~ADJOINING TO~~ (BACK OF MARKET) H.NO.
 C-IV-6 (PART-II) LAXPAT NAGAR IV
 NEW DELHI (NOT TO SCALE)

P. AREA = 100 SQ YDS (15' x 60')

(Sr. No. 16)

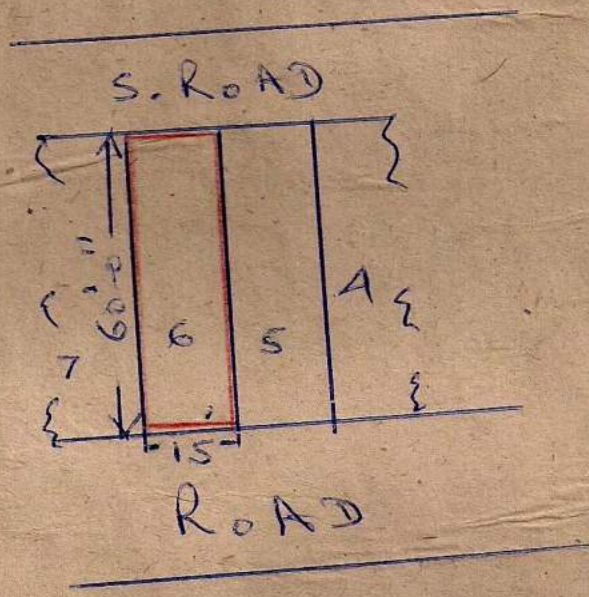

Captain B. J. ...
 3.1.84.
 New Delhi

Handed over
 3/1/84
 (R. C. ...)
 Assistant Engineer
 Department of Rehabilitation
 Jaisalmer House, New Delhi

Take
 Assn. Secy
 Delhi Develo
 No.

LINE PLAN SHOWING LAND
 HANDED OVER TO D.D.A. PLOT NO E-IV /
 265 (PART II) LASPAT NAGAR - IV
 NEW DELHI (NOT TO SCALE)
 P. AREA = 100 SQ. YDS (15' x 60')

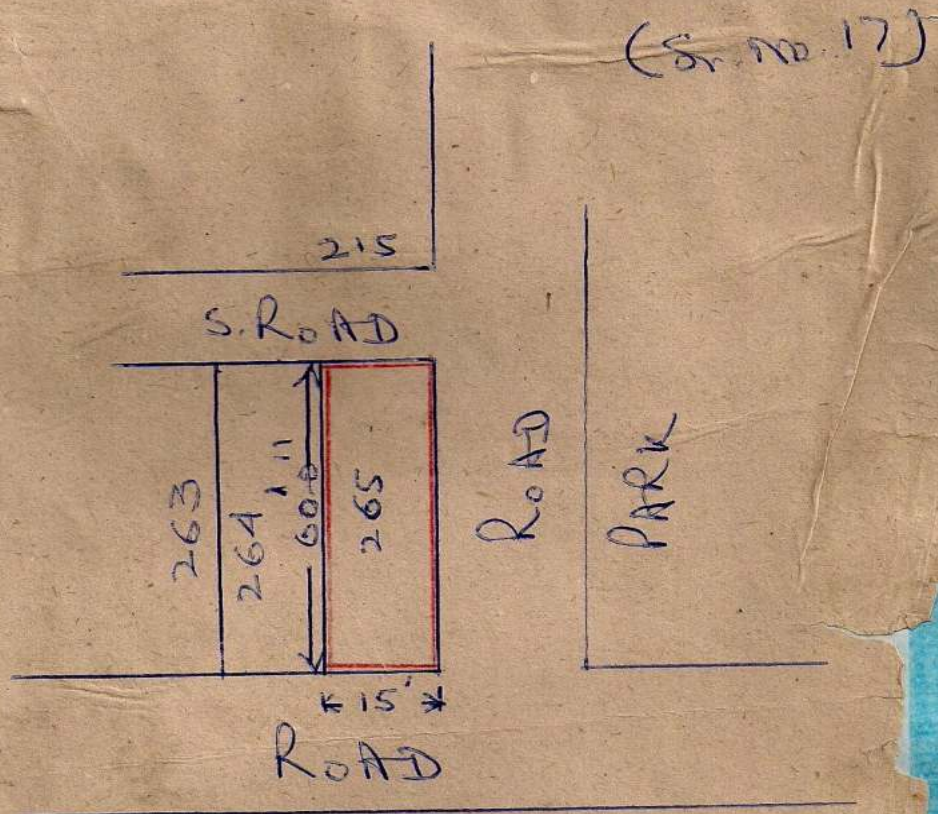

3.184. Handed over
 (B. P. ...)
 Settlement Office (Core Managing Officer)
 Department of Rehabilitation (S. WING)
 New Delhi

No Bills
 37/11/14
 Assistant Engineer
 Department of Rehabilitation
 Jaisalmer House, New Delhi

Taken over
 Asstt. Settlement Officer
 Delhi Development Authc
 New Delhi.